



**STATE OF HAWAII**  
**DEPARTMENT OF TRANSPORTATION**  
869 PUNCHBOWL STREET  
HONOLULU, HAWAII 96813-5097

IN REPLY REFER TO:

Board of Land and  
Natural Resources  
State of Hawaii  
Honolulu, Hawaii

ISSUANCE OF A REVOCABLE PERMIT FOR RAMP  
SPACE TO STORE BAGGAGE/CARGO CONTAINERS  
JAPAN AIRLINES CO., LTD.  
ELLISON ONIZUKA KONA INTERNATIONAL AIRPORT AT KEAHOLE  
TAX MAP KEY: (3) 7-3-43: PORTION OF 003

HAWAII

LEGAL REFERENCE:

Section 171-55, Hawaii Revised Statutes (HRS), as amended.

APPLICANT:

Japan Airlines Co., Ltd. (JAL), a Japanese corporation, whose business address is  
300 Continental Boulevard, Suite 400, El Segundo, California 90245.

LOCATION AND TAX MAP KEY:

Portion of Ellison Onizuka Kona International Airport at Keahole (KOA), Kailua-Kona,  
Island of Hawaii, identified by Tax Map Key: 3rd Division, 7-3-43: Portion of 003.

AREA:

Area/Space No. 630-169, containing an area of approximately 800 square feet of improved,  
paved land, as shown and delineated on the attached Exhibit A.

ZONING:

State Land Use District:	Urban & Conservation
County of Hawaii:	Industrial (MG-1a) and Open

**ITEM M-6**

BLNR – ISSUANCE OF A REVOCABLE PERMIT FOR RAMP SPACE TO STORE  
BAGGAGE/CARGO CONTAINERS, JAPAN AIRLINES CO., LTD.

Page 2

LAND TITLE STATUS:

Section 5(a) lands of the Hawaii Admission Act: Ceded  
DHHL 30% entitlement lands pursuant to Hawaii Admission Act YES \_\_\_ NO X

CURRENT USE STATUS:

Land presently encumbered by Governor’s Executive Order No. 3074, dated August 20, 1981, setting aside 4,204.10 acres designated as KOA under the control and management of the State of Hawaii, Department of Transportation, Airports Division for Airport Purposes.

CHARACTER OF USE:

JAL will use the space to store baggage/cargo containers to support its signatory airline operation.

COMMENCEMENT DATE:

Upon execution of the revocable permit.

MONTHLY RENTAL:

\$137.33 (based on a rate of \$2.06 per square foot per annum for improved, paved land, as determined from the DOTA schedule of rates and charges established by appraisal of Airports property statewide).

SECURITY DEPOSIT:

\$411.99, or three times the monthly rental in effect.

DCCA VERIFICATION:

Place of business registration confirmed:	YES <u>X</u>	NO _____
Registered business name confirmed:	YES <u>X</u>	NO _____
Good standing confirmed:	YES <u>X</u>	NO _____

CHAPTER 343, HRS - ENVIRONMENTAL ASSESSMENT:

The State of Hawaii, Department of Transportation, Airports Division, has determined that the impacts of this action are de minimis and exempt, pursuant to Department of

BLNR – ISSUANCE OF A REVOCABLE PERMIT FOR RAMP SPACE TO STORE  
BAGGAGE/CARGO CONTAINERS, JAPAN AIRLINES CO., LTD.

Page 3

Transportation, Comprehensive Exemption List, Type 8, Part 1, 8(g), concurred to by the  
Environmental Advisory Council on February 1, 2022.

REMARKS:

In accordance with Section 171-55, HRS, relating to Permits, the Department of  
Transportation proposes to issue a month-to-month revocable permit to JAL for ramp  
space to store baggage/cargo containers to support its signatory airline operation at KOA.

RECOMMENDATION:

Based on this submittal, and testimony and facts presented, the Department of  
Transportation recommends the Board finds that approving the issuance of a month-to-  
month Revocable Permit to JAL, including its conditions and rent, will serve the best  
interests of the State.

Respectfully submitted,



EDWIN H. SNIFFEN  
Director of Transportation

APPROVED FOR SUBMITTAL:



DAWN N. S. CHANG  
Chairperson  
Board of Land and Natural Resources



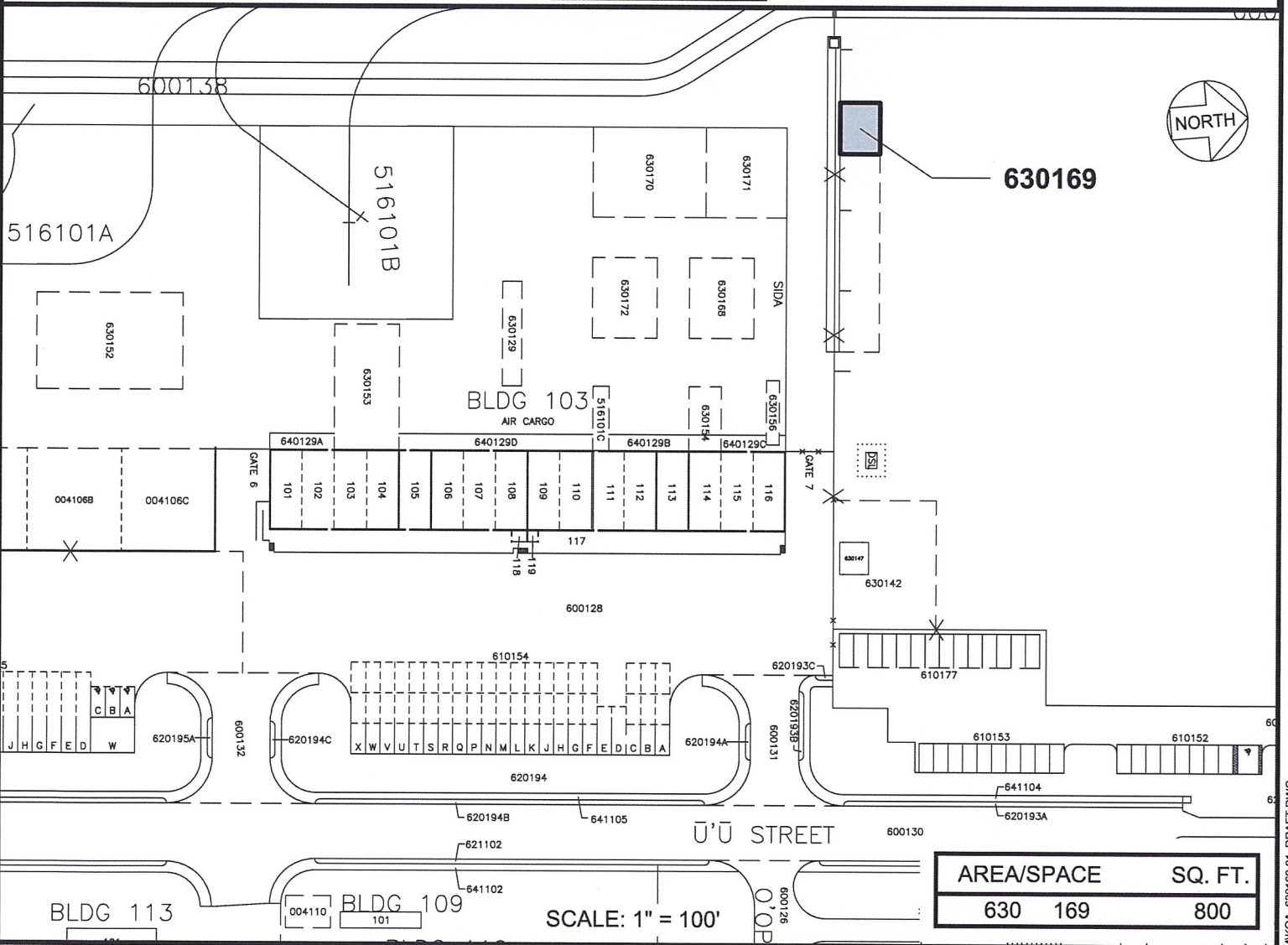
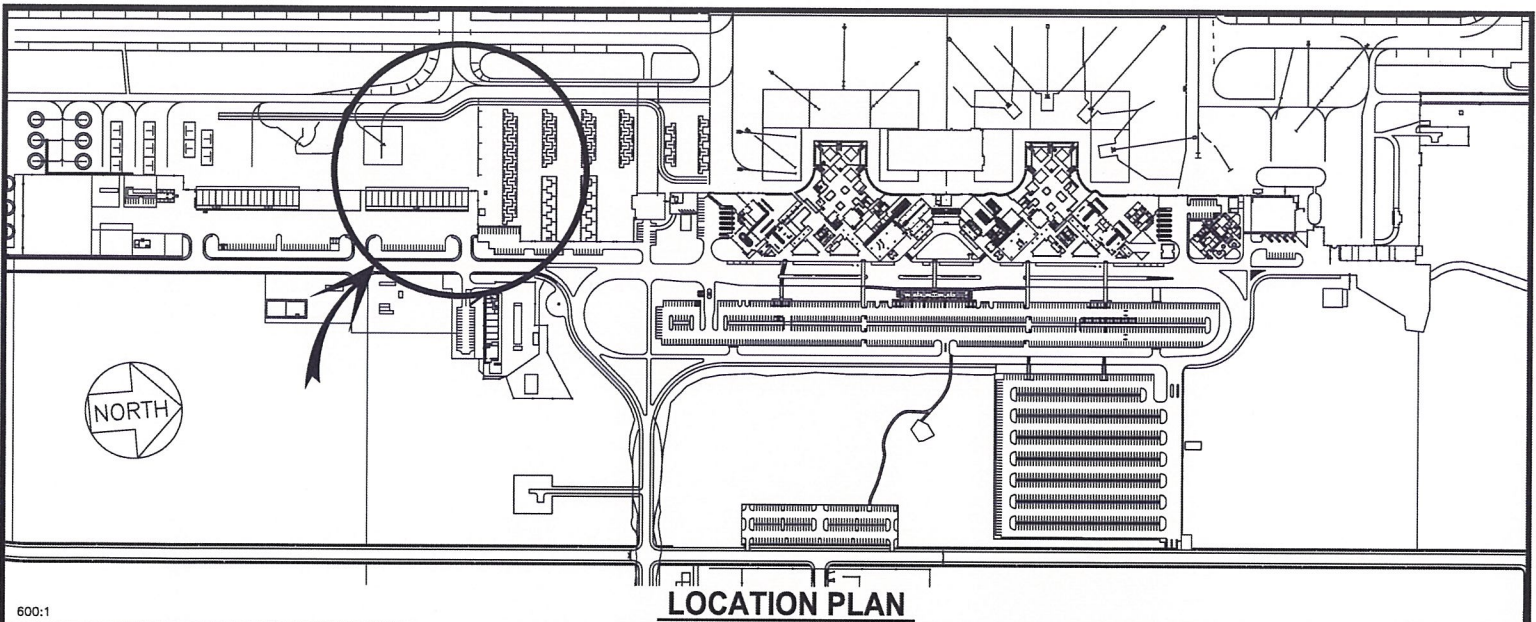

RP-9380	DATE : DECEMBER 2022	EXHIBIT: <b>A</b>
Airports Division	JAPAN AIRLINES CO., LTD.	STORAGE SOUTH GATE GROUND LEVEL
		630169 PLAT C1,39

ELLISON ONIZUKA KONA INTERNATIONAL AIRPORT AT KEAHOLE

N:\AIRPORTS\KOA\_KONACAD\PI\M\KOA\_630169-01\_DRAFT.DWG