

JOSH GREEN, M.D.
GOVERNOR



STATE OF HAWAII
DEPARTMENT OF TRANSPORTATION
869 PUNCHBOWL STREET
HONOLULU, HAWAII 96813-5097

EDWIN H. SNIFFEN
DIRECTOR

Deputy Directors
DREANALEE K. KALILI
TAMMY L. LEE
ROBIN K. SHISHIDO
JAMES KUNANE TOKIOKA

IN REPLY REFER TO:

Board of Land and
Natural Resources
State of Hawaii
Honolulu, Hawaii

ISSUANCE OF A REVOCABLE PERMIT FOR THE INSTALLATION
OF SIX (6) AVIGILON CAMERAS AT GATES E1, E3, E5, E6, E7 AND E9
AS PART OF ITS AIRLINE OPERATIONS
SOUTHWEST AIRLINES CO.
DANIEL K. INOUE INTERNATIONAL AIRPORT
TAX MAP KEY: (1) 1-1-003: 050 (PORTION)

OAHU

APPLICANT:

Southwest Airlines Co. (Southwest Airlines), whose business address is
2702 Love Field Drive, Dallas, Texas 75235.

LEGAL REFERENCE:

Section 171-55, Hawaii Revised Statutes.

LOCATION AND TAX MAP KEY:

Building No. 350, Central Concourse, Ground Level at
Daniel K. Inouye International Airport, Island of Oahu, State of Hawaii, identified by
Tax Map Key: 1st Division, 1-1-003: 050 (Portion).

AREA:

Bldg/Room No. 350-175, containing an area of approximately one square foot;
Bldg/Room No. 350-176, containing an area of approximately one square foot;
Bldg/Room No. 350-177, containing an area of approximately one square foot;
Bldg/Room No. 350-178, containing an area of approximately one square foot;
Bldg/Room No. 350-179, containing an area of approximately one square foot; and
Bldg/Room No. 350-180, containing an area of approximately one square foot,
as shown and delineated on the attached map labeled Exhibit "A".

ITEM M-6

BLNR – ISSUANCE OF A REVOCABLE PERMIT FOR THE INSTALLATION OF SIX (6) AVIGILON CAMERAS AT GATES E1, E3, E5, E6, E7 AND E9 AS PART OF ITS AIRLINE OPERATIONS, SOUTHWEST AIRLINES CO.

Page 2

ZONING:

State Land Use District: Urban
City and County of Honolulu LUO: Industrial (I-2)

LAND TITLE STATUS:

Non-Ceded - Section 5(a) lands of the Hawaii Admission Act
DHHL 30% entitlement lands pursuant to Hawaii Admission Act YES ___ NO X

CURRENT USE STATUS:

Land presently encumbered by Governor’s Executive Order No. 3201, dated June 8, 1983, setting aside 3,152.177 acres designated as Daniel K. Inouye International Airport under the control and management of the State of Hawaii, Department of Transportation, for Airport Purposes.

CHARACTER OF USE:

Southwest Airlines will use the spaces for the installation of six (6) Avigilon cameras at Gates E1, E3, E5, E6, E7 and E9 for its airline operations at Daniel K. Inouye International Airport.

COMMENCEMENT DATE:

Upon execution of the revocable permit.

MONTHLY RENTAL:

\$150.00 (as determined from the Department of Transportation schedule of rates and charges, established by appraisal of Airports property statewide).

SECURITY DEPOSIT:

\$450.00, or three (3) times the monthly rental in effect.

DCCA VERIFICATION:

Place of business registration confirmed: YES X NO ___
Registered business name confirmed: YES X NO ___
Good standing confirmed: YES X NO ___

BLNR – ISSUANCE OF A REVOCABLE PERMIT FOR THE INSTALLATION OF SIX (6) AVIGILON CAMERAS AT GATES E1, E3, E5, E6, E7 AND E9 AS PART OF ITS AIRLINE OPERATIONS, SOUTHWEST AIRLINES CO.

Page 3

CHAPTER 343, HRS - ENVIRONMENTAL ASSESSMENT:

The environmental impacts of the proposed action to the subject land area are covered by the Honolulu International Airport Master Plan Update and Noise Compatibility Program Environmental Assessment (EA), State Project No. AO1011-03. The EA is a joint State and Federal document, dated September 1989 and published in the October 23, 1989 issue of the OEQC Bulletin. Accordingly, relevant mitigation from the EA and Department of Transportation environmental best management practice will address minimal impacts from this action.

REMARKS:

In accordance with Section 171-55, HRS, relating to Permits, the Department of Transportation proposes to issue a month-to-month revocable permit to Southwest Airlines for the installation of six (6) Avigilon cameras at Gates E1, E3, E5, E6, E7 and E9 as part of its airline operations at the Airport. Southwest Airlines is a signatory airline carrier with airline operations located mainly within the Overseas Terminal.

RECOMMENDATION:

Based on this submittal, and testimony and facts presented, the Department of Transportation recommends the Board finds that approving the issuance of a month-to-month Revocable Permit to Southwest Airlines, including its conditions and rent, will serve the best interests of the State.

Respectfully submitted,



EDWIN H. SNIFFEN
Director of Transportation

APPROVED FOR SUBMITTAL:



DAWN N. S. CHANG
Chairperson
Board of Land and Natural Resources

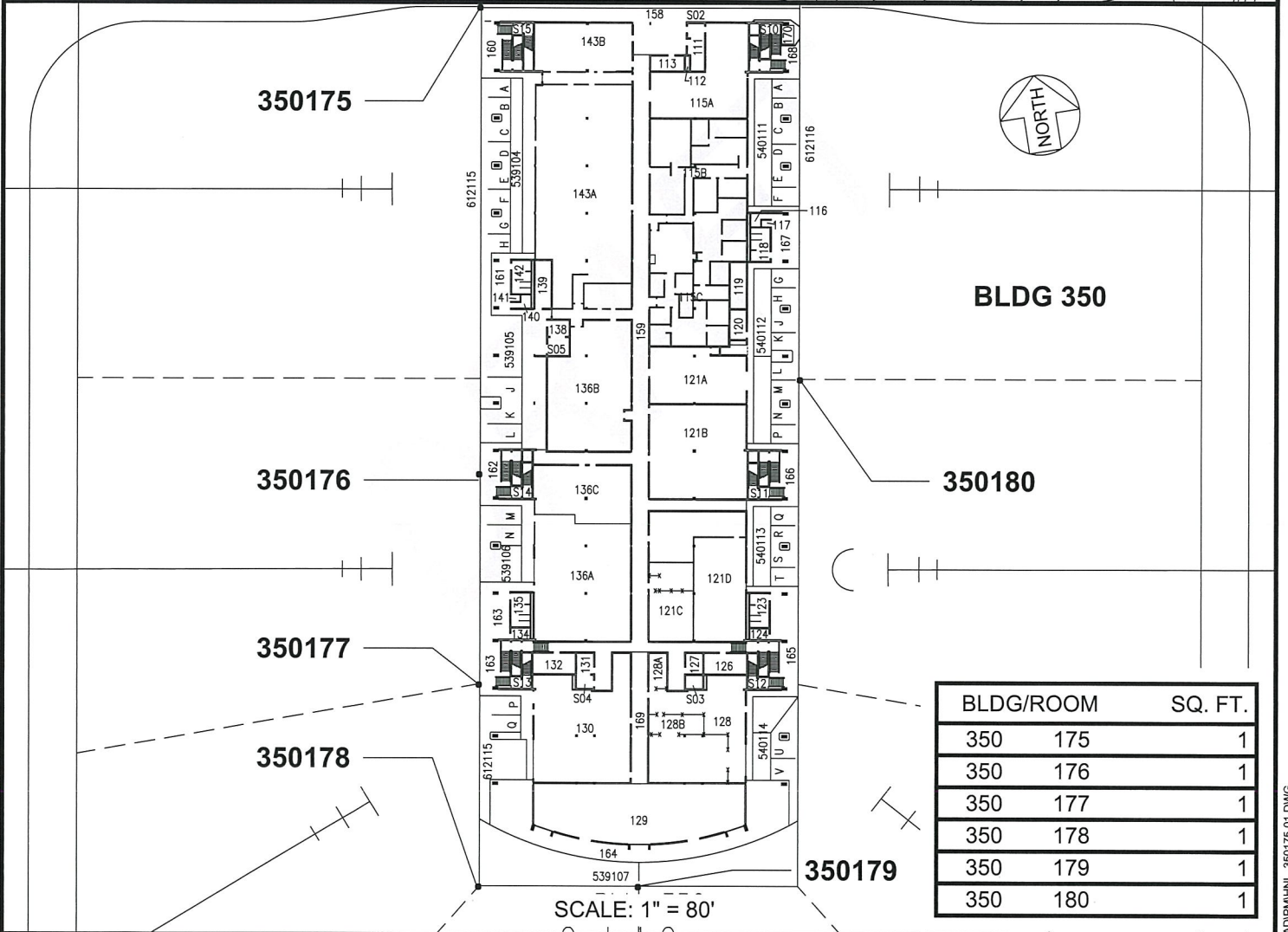
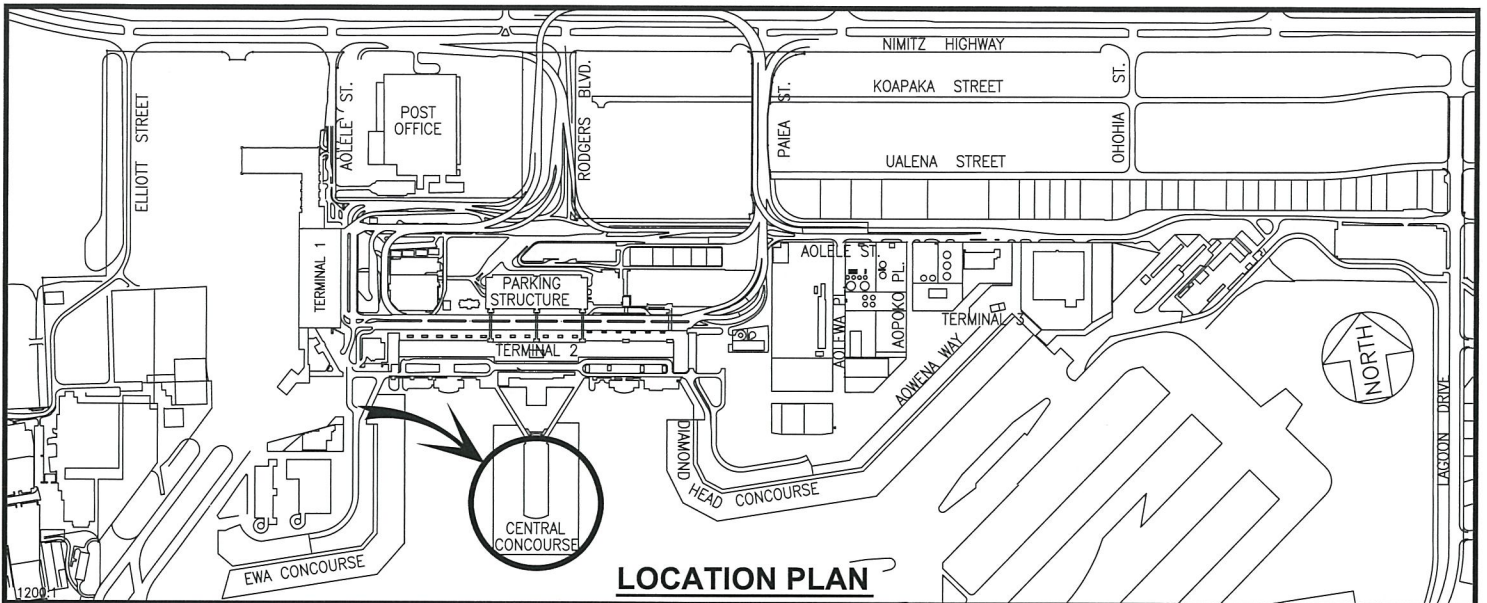

BLDG/ROOM	SQ. FT.
350 175	1
350 176	1
350 177	1
350 178	1
350 179	1
350 180	1

RP-9396

DATE : FEBRUARY 2023

EXHIBIT: **A**



**SOUTHWEST AIRLINES CO.
(CAMERAS)**

**BUILDING 350
CENTRAL CONCOURSE
GROUND LEVEL**

**350175-180
PLAT A1**