

JOSH GREEN, M.D.
GOVERNOR



STATE OF HAWAII
DEPARTMENT OF TRANSPORTATION
869 PUNCHBOWL STREET
HONOLULU, HAWAII 96813-5097

EDWIN H. SNIFFEN
DIRECTOR

Deputy Directors
DREANALEE K. KALILI
TAMMY L. LEE
ROBIN K. SHISHIDO
JAMES KUNANE TOKIOKA

IN REPLY REFER TO:

Board of Land and
Natural Resources
State of Hawaii
Honolulu, Hawaii

ISSUANCE OF A REVOCABLE PERMIT FOR AIRCRAFT PARKING
THE REALTY INVESTMENT COMPANY, LIMITED
HILO INTERNATIONAL AIRPORT
TAX MAP KEY: (3) 2-1-12: PORTION OF 009

HAWAII

REQUEST:

Issuance of a Revocable Permit for Aircraft Parking (Parking Permit) to
The Realty Investment Company, Limited, for an aircraft tie-down space,
situated at Hilo International Airport.

LEGAL REFERENCE:

Section 171-55, Hawaii Revised Statutes (HRS), as amended.

APPLICANT:

The Realty Investment Company, Limited (TRIC), whose mailing address is
P. O. Box 6633, Hilo, Hawaii 96720.

LOCATION AND TAX MAP KEY:

Portion of Hilo International Airport (ITO), Hilo, Island of Hawaii, identified by
Tax Map Key: 3rd Division, 2-1-12: Portion of 009.

AREA:

Area/Space No. 411-102, containing an area of approximately 990 square feet, as
shown and delineated on the attached Exhibit A.

ITEM M-2

BLNR – ISSUANCE OF A REVOCABLE PERMIT FOR AIRCRAFT PARKING
THE REALTY INVESTMENT COMPANY, LIMITED
Page 2

ZONING:

State Land Use District: Urban
County of Hawaii: Industrial (ML-20)

LAND TITLE STATUS:

Section 5(a) lands of the Hawaii Admission Act: Ceded
DHHL 30% entitlement lands pursuant to the Hawaii Admission Act: YES ___ NO X

CURRENT USE STATUS:

Land presently encumbered by Governor's Executive Order No. 2653, dated March 5, 1973, setting aside 284.466 acres designated as General Lyman Field under the control and management of the State of Hawaii, Department of Transportation, Airports for public purposes.

CHARACTER OF USE:

Aircraft tie-down (1976 Grumman AA-A5 Cheetah, Tail No. N9654U).

COMMENCEMENT DATE:

Upon complete execution of the Parking Permit.

MONTHLY RENTAL:

\$126.00 (as determined from the Department of Transportation, Airports schedule of rates and charges established by appraisal of Airports property statewide)

SECURITY DEPOSIT:

\$378.00, or three (3) times the monthly rental in effect.

CHAPTER 343, HRS - ENVIRONMENTAL ASSESSMENT:

The State of Hawaii, Department of Transportation, Airports, has determined that the subject land areas are covered by the Hilo International Airport Final Environmental Assessment (EA), dated April 15, 2003, and published by the Office of Environmental Quality Control (OEQC) in the May 8, 2003, issue of The Environmental Notice. Accordingly, all relevant mitigation from the EA and best management practices will be implemented to address the minimum impacts of this action.

BLNR – ISSUANCE OF A REVOCABLE PERMIT FOR AIRCRAFT PARKING
THE REALTY INVESTMENT COMPANY, LIMITED
Page 3

REMARKS:

In accordance with Section 171-55, HRS, relating to Permits, the Department of Transportation (DOT) proposes to issue a month-to-month Parking Permit to TRIC for an aircraft tie-down at ITO.

RECOMMENDATION:

Based on this submittal, and testimony and facts presented, the DOT recommends the Board finds that approving the issuance of a month-to-month Parking Permit to TRIC, including its conditions and rent, will serve the best interests of the State.

Respectfully submitted,



EDWIN H. SNIFFEN
Director of Transportation

APPROVED FOR SUBMITTAL:



DAWN N. S. CHANG
Chairperson
Board of Land and Natural Resources

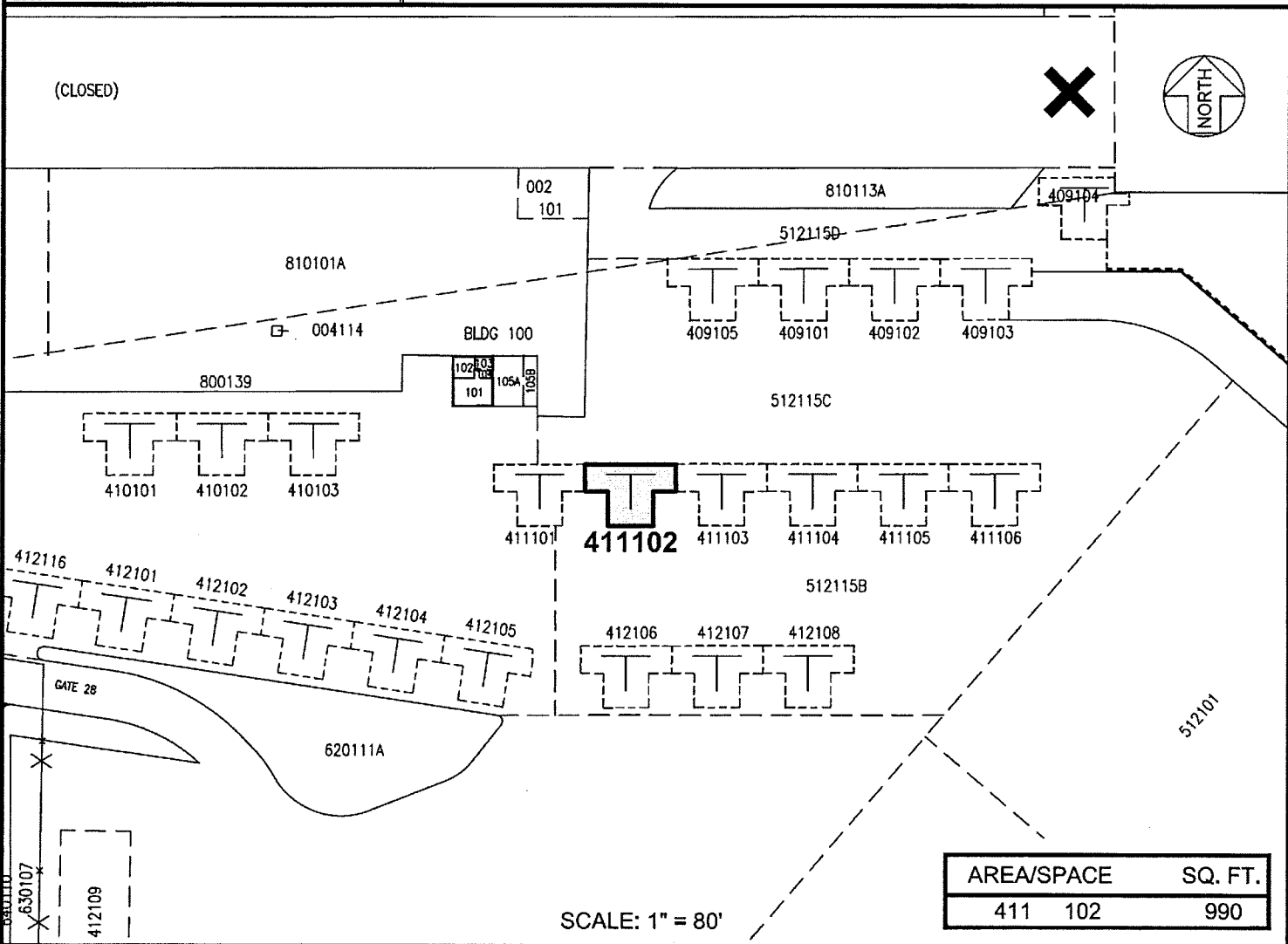
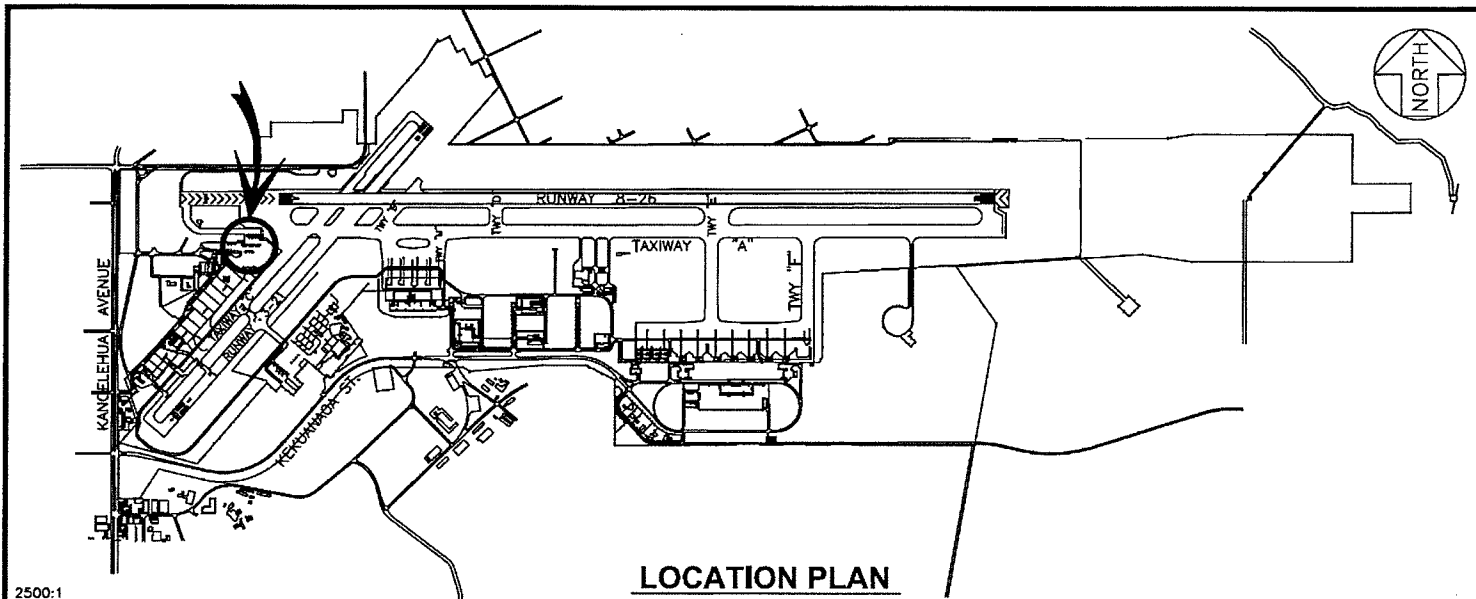

DATE : FEBRUARY 2023

EXHIBIT: **A**



THE REALTY INVESTMENT
COMPANY, LIMITED

TIE-DOWN

411102
PLAT 30

HILO INTERNATIONAL AIRPORT