

JOSH GREEN, M.D.
GOVERNOR



EDWIN H. SNIFFEN
DIRECTOR

Deputy Directors
DREANALEE K. KALILI
TAMMY L. LEE
ROBIN K. SHISHIDO

STATE OF HAWAII
DEPARTMENT OF TRANSPORTATION
869 PUNCHBOWL STREET
HONOLULU, HAWAII 96813-5097

IN REPLY REFER TO:

Board of Land and
Natural Resources
State of Hawaii
Honolulu, Hawaii

ISSUANCE OF A REVOCABLE PERMIT FOR MAIN
TERMINAL FLOOR SPACE FOR TICKET COUNTERS
AIR CANADA
ELLISON ONIZUKA KONA INTERNATIONAL AIRPORT AT KEAHOLE
TAX MAP KEY: (3) 7-3-43: PORTION OF 003

HAWAII

LEGAL REFERENCE:

Section 171-55, Hawaii Revised Statutes (HRS), as amended.

APPLICANT:

Air Canada, whose mailing address is 7373 Cote Vertu West, Saint Laurent,
Quebec H4S 1Z3.

LOCATION AND TAX MAP KEY:

Portion of Ellison Onizuka Kona International Airport at Keahole (KOA), Kailua-Kona,
Island of Hawaii, identified by Tax Map Key: 3rd Division, 7-3-43: Portion of 003.

AREA:

Building/Room No. 316-103, containing an area of approximately 354 square feet, as
shown and delineated on the attached Exhibit A.

ZONING:

State Land Use District:	Urban & Conservation
County of Hawaii:	Industrial (MG-1a) and Open

ITEM M-4

BLNR – ISSUANCE OF A REVOCABLE PERMIT FOR MAIN TERMINAL FLOOR SPACE FOR TICKET COUNTERS, AIR CANADA

Page 2

LAND TITLE STATUS:

Section 5(a) lands of the Hawaii Admission Act: Ceded
DHHL 30% entitlement lands pursuant to Hawaii Admission Act YES ___ NO X

CURRENT USE STATUS:

Land presently encumbered by Governors Executive Order No. 3074, dated August 20, 1981, setting aside 4,204.10 acres designated as KOA under the control and management of the State of Hawaii, Department of Transportation, Airports for Airport Purposes.

CHARACTER OF USE:

Air Canada will use the space to install ticket counters in support of its Signatory Airline Carrier Operation at KOA.

COMMENCEMENT DATE:

To be determined by the Director of Transportation at a later date.

MONTHLY RENTAL:

\$2,366.79 (based on a rate of \$80.23 per square foot, per annum, as determined from the Airports Signatory Rates and Charges, Hawaii Airports System, effective July 1, 2022)

SECURITY DEPOSIT:

\$7,100.37, or three (3) times the monthly rental in effect.

DCCA VERIFICATION:

Place of business registration confirmed: N/A
Registered business name confirmed: N/A
Good standing confirmed: N/A

CHAPTER 343, HRS - ENVIRONMENTAL ASSESSMENT:

The subject land area pertaining to this action was evaluated for environmental impact by the Keahole Airport Master Plan Final Environmental Impact Statement (EIS), published in The Environmental Notice on November 8, 1988, and accepted by the Governor on December 19, 1988. This action is consistent with the 1988 EIS and the same mitigation conditions apply.

BLNR – ISSUANCE OF A REVOCABLE PERMIT FOR MAIN TERMINAL FLOOR SPACE
FOR TICKET COUNTERS, AIR CANADA

Page 3

REMARKS:

In accordance with Section 171-55, HRS, relating to Permits, the State of Hawaii, Department of Transportation (DOT) proposes to issue a month-to-month revocable permit to Air Canada for main terminal floor space to install ticket counters in support of its Signatory Airline Carrier Operation at KOA.

RECOMMENDATION:

Based on this submittal, and testimony and facts presented, the DOT recommends the Board finds that approving the issuance of a month-to-month Revocable Permit to Air Canada, including its conditions and rent, will serve the best interests of the State.

Respectfully submitted,



EDWIN H. SNIFFEN
Director of Transportation

APPROVED FOR SUBMITTAL:



DAWN N. S. CHANG
Chairperson
Board of Land and Natural Resources

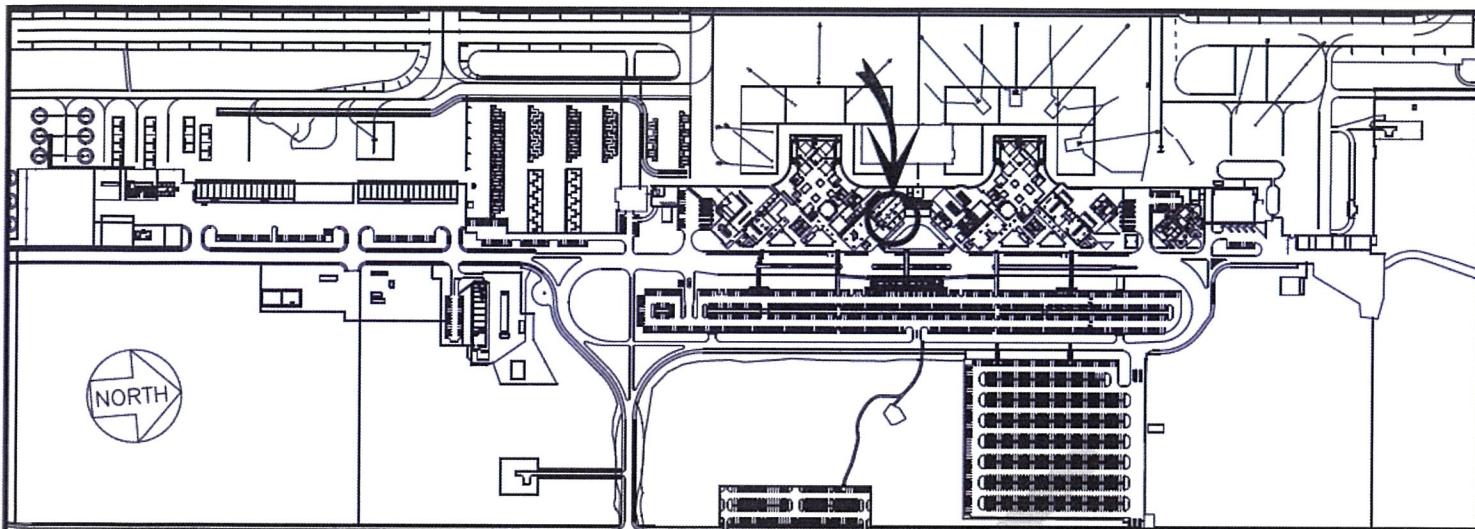

LOCATION PLAN

600:1

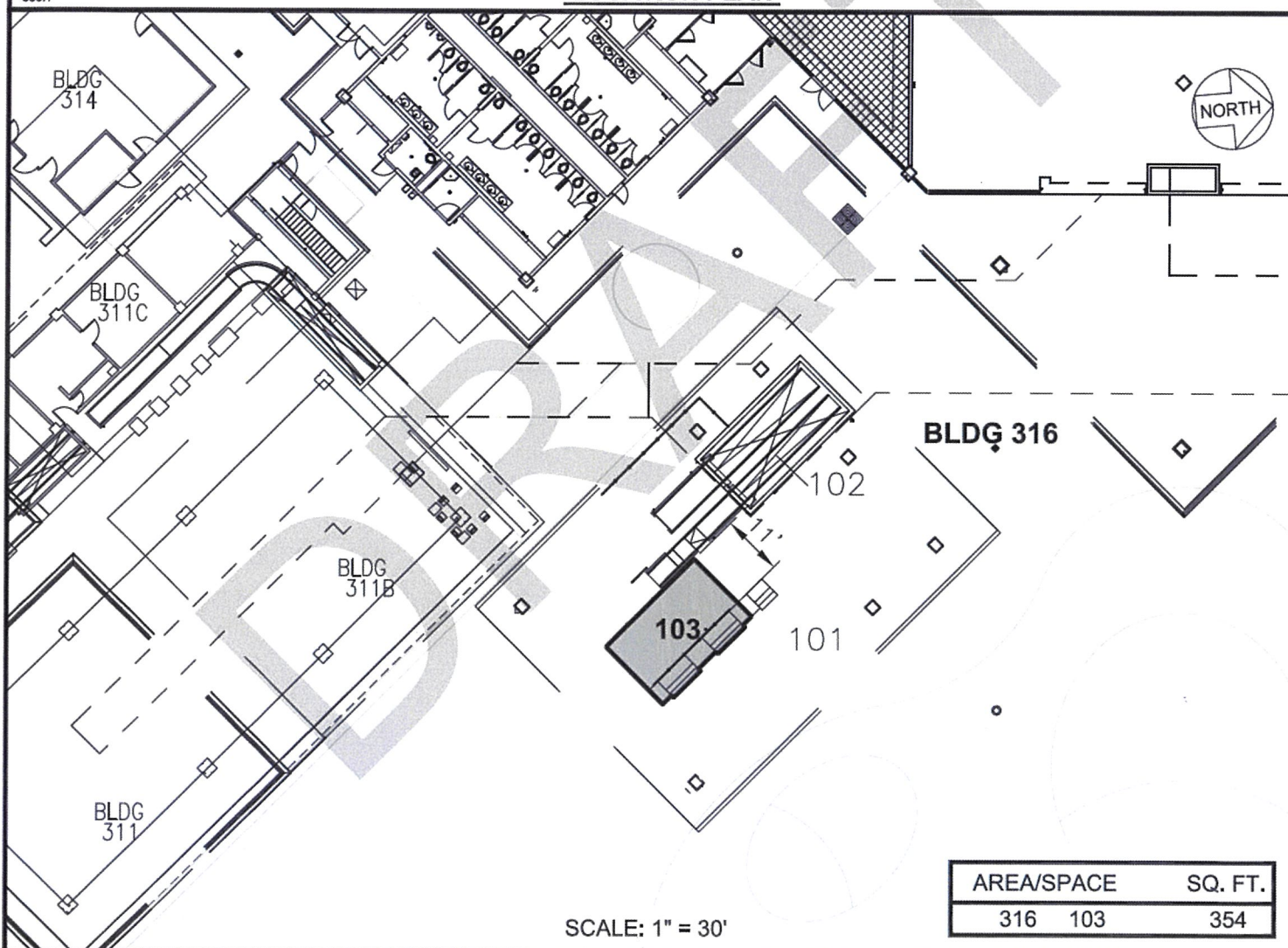

SCALE: 1" = 30'

AREA/SPACE	SQ. FT.
316 103	354

DATE : FEBRUARY 2023

EXHIBIT: **A**



Airports

AIR CANADA

BLDG 316
BAGGAGE MAKE UP
GROUND LEVEL

316103
PLAT E1,58

ELLISON ONIZUKA KONA INTERNATIONAL AIRPORT AT KEAHOLE

N:\AIRPORTS\KONA_KONACAD\PIW\KOA_316103-01_DRAFT.DWG