



STATE OF HAWAII
DEPARTMENT OF TRANSPORTATION
869 PUNCHBOWL STREET
HONOLULU, HAWAII 96813-5097

Board of Land and
Natural Resources
State of Hawaii
Honolulu, Hawaii

AMENDMENT TO PRIOR BOARD ACTION OF MAY 12, 2023, ITEM M-1,
ISSUANCE OF A REVOCABLE PERMIT FOR A FIELD OFFICE AND VEHICLE
PARKING FOR PASSENGER LOADING BRIDGE MAINTENANCE PROJECT
BOWERS + KUBOTA CONSULTING, INC.
DANIEL K. INOUE INTERNATIONAL AIRPORT
TAX MAP KEY: (1) 1-1-003: 001 (PORTION)

OAHU

On May 12, 2023, under agenda Item M-1, the Land Board authorized the Department of Transportation (DOT) to issue a revocable permit to Bowers + Kubota Consulting, Inc., for a field office and vehicle parking for Passenger Loading Bridge Maintenance Project located at Daniel K. Inouye International Airport on the Island of Oahu.

PURPOSE:

The DOT requests certain changes to the space number of the vehicle parking space previously approved by the Land Board as follows:

ORIGINAL:

AREA:

Building/Room No. 360-130D, containing an area of approximately 507 square feet;
Building/Room No. 360-130N, containing an area of approximately 80 square feet; and
Area/Space No. 611-105E, containing an area of approximately 345 square feet as shown
and delineated on the attached map labeled Exhibit "A".

AS AMENDED:

AREA:

Building/Room No. 360-130D, containing an area of approximately 507 square feet;
Building/Room No. 360-130N, containing an area of approximately 80 square feet; and
Area/Space No. 611-106B, containing an area of approximately 345 square feet as shown
and delineated on the attached map labeled Exhibit "A".

ITEM M-1

BLNR – AMENDMENT TO THE PRIOR BOARD ACTION OF MAY 12, 2023, ITEM M-1
ISSUANCE OF A REVOCABLE PERMIT FOR A FIELD OFFICE AND VEHICLE
PARKING FOR PASSENGER LOADING BRIDGE MAINTENANCE PROJECT
BOWERS + KUBOTA CONSULTING, INC.

Page 2

REMARKS:

All other terms as outlined in the submittal previously approved by the Land Board remain unchanged.

RECOMMENDATION:

Based on this amendment, testimony and facts presented, the Department of Transportation recommends the Board finds that approving the change in the space number of the vehicle parking space in the issuance of a month-to-month Revocable Permit to Bowers + Kubota Consulting, Inc., including its conditions and rent, will serve the best interests of the State.

Respectfully submitted,



EDWIN H. SNIFFEN
Director of Transportation

APPROVED FOR SUBMITTAL:



DAWN N. S. CHANG
Chairperson
Board of Land and Natural Resources

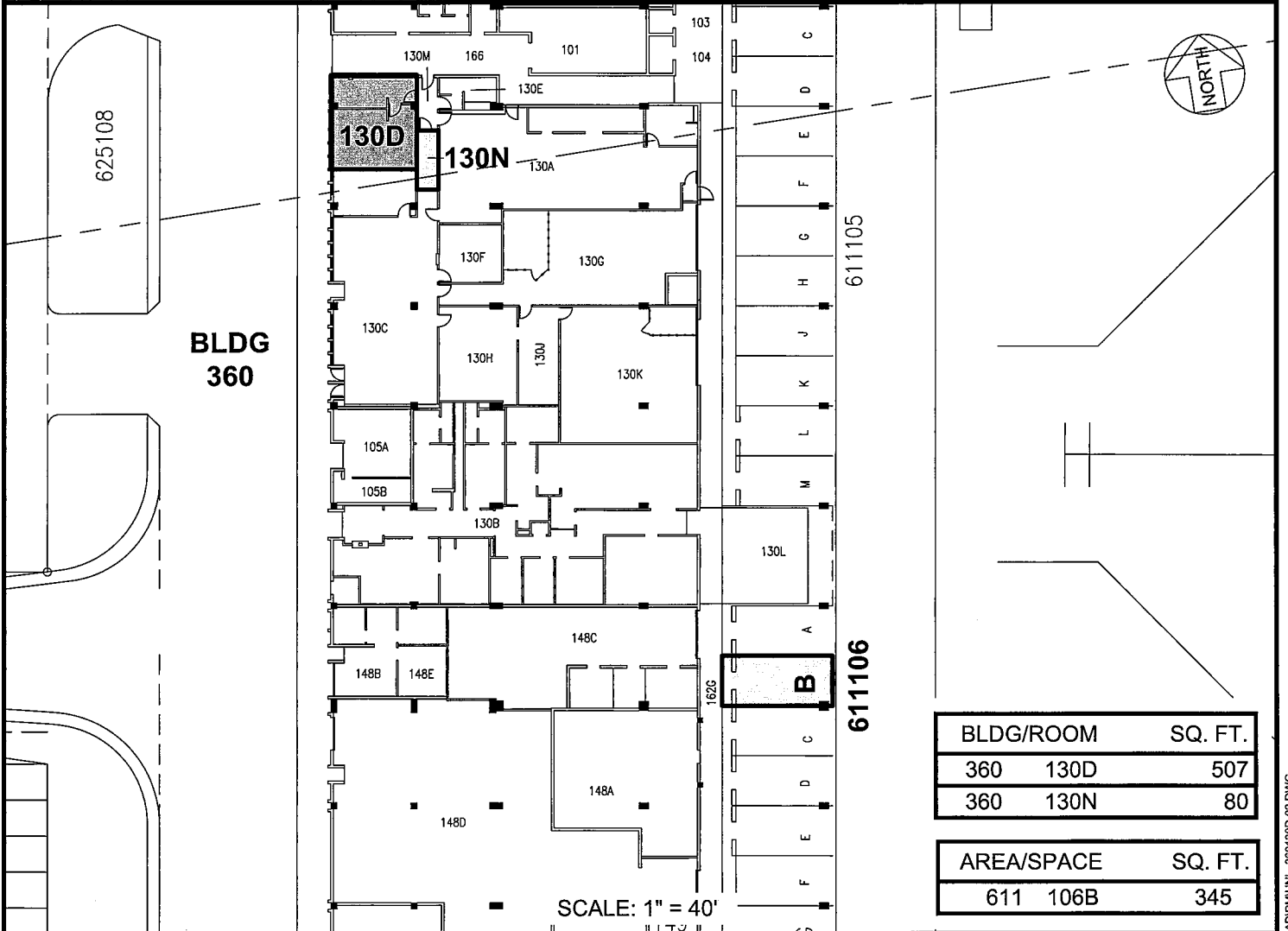
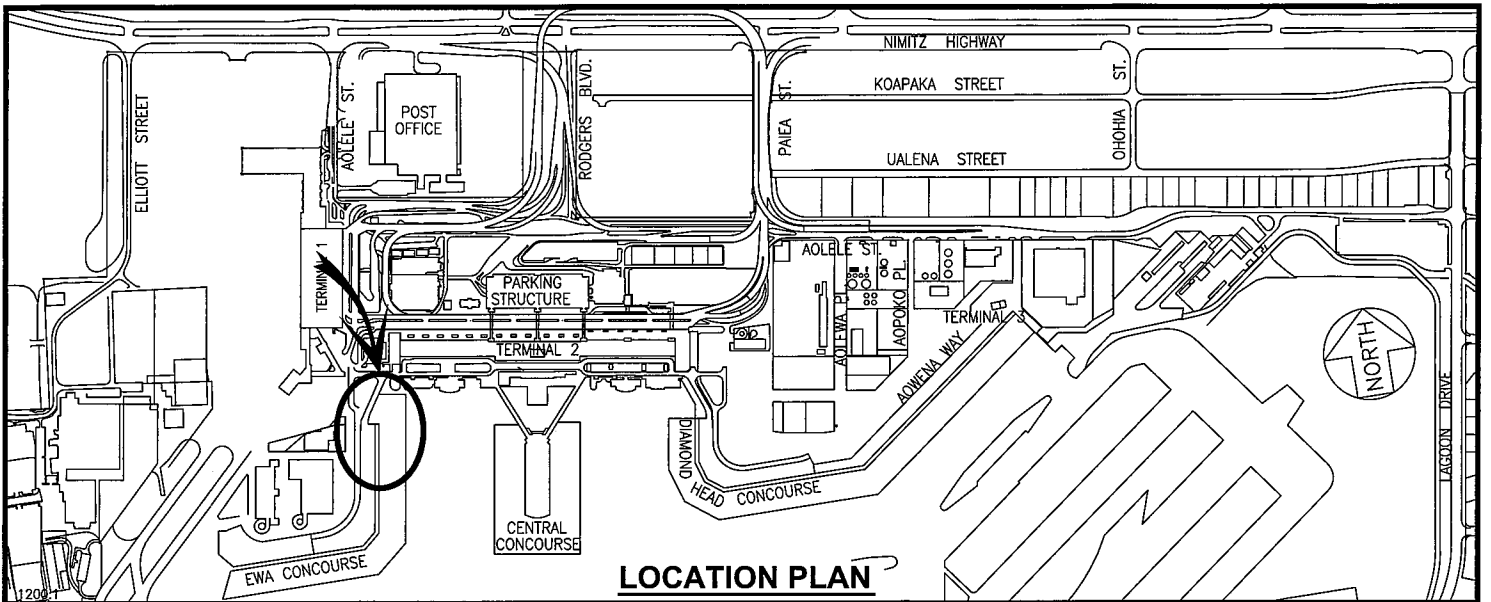

BLDG/ROOM	SQ. FT.
360 130D	507
360 130N	80

AREA/SPACE	SQ. FT.
611 106B	345

RP-9421	DATE : APRIL 2023	EXHIBIT: A	
	BOWERS + KUBOTA CONSULTING, INC.	BLDG 360 & PARKING STALL EWA CONCOURSE GROUND LEVEL	360130D,N 611106B

DANIEL K. INOUE INTERNATIONAL AIRPORT

N:\AIRPORTS\HNL_HONOLULU\CAD\PM\HNL_360130D-02.DWG

JOSH GREEN, M.D.
GOVERNOR



EDWIN H. SNIFFEN
DIRECTOR

Deputy Directors
DREANALEE K. KALILI
TAMMY L. LEE
ROBIN K. SHISHIDO
JAMES KUNANE TOKIOKA

STATE OF HAWAII
DEPARTMENT OF TRANSPORTATION
869 PUNCHBOWL STREET
HONOLULU, HAWAII 96813-5097

IN REPLY REFER TO:

MAY 12, 2023

Board of Land and
Natural Resources
State of Hawaii
Honolulu, Hawaii

ISSUANCE OF A REVOCABLE PERMIT FOR A FIELD OFFICE AND VEHICLE
PARKING FOR PASSENGER LOADING BRIDGE MAINTENANCE PROJECT
BOWERS + KUBOTA CONSULTING, INC.
DANIEL K. INOUE INTERNATIONAL AIRPORT
TAX MAP KEY: (1) 1-1-003: 001 (PORTION)

OAHU

REQUEST:

Issuance of a Revocable Permit for a field office and vehicle parking for passenger loading bridge maintenance project at Daniel K. Inouye International Airport.

LEGAL REFERENCE:

Section 171-55, Hawaii Revised Statutes (HRS).

APPLICANT:

Bowers + Kubota Consulting, Inc., whose mailing address is 94-408 Akoki Street, Waipahu, Hawaii 96797.

LOCATION AND TAX MAP KEY:

A portion of Building 360 and parking stall, Ewa Concourse, Ground Level at Daniel K. Inouye International Airport, Island of Oahu, State of Hawaii, identified by Tax Map Key: 1st Division, 1-1-003: 001 (Portion).

AREA:

Building/Room Nos. 360-130D and 360-130N, containing an area of approximately 507 square feet and 80 square feet respectively, and Area/Space No. 611-105E, containing an area of approximately 345 square feet as shown and delineated on the attached map labeled Exhibit "A".

ITEM M-1
MAY 12, 2023
RP-9421

BLNR – ISSUANCE OF A REVOCABLE PERMIT FOR A FIELD OFFICE AND VEHICLE
PARKING FOR PASSENGER LOADING BRIDGE MAINTENANCE PROJECT
BOWERS + KUBOTA CONSULTING, INC.

Page 2

ZONING:

State Land Use District: Urban
City and County of Honolulu LUO: Industrial (I-2)

LAND TITLE STATUS:

Non-Ceded - Section 5(a) lands of the Hawaii Admission Act
DHHL 30% entitlement lands pursuant to Hawaii Admission Act YES ___ NO X

CURRENT USE STATUS:

Land presently encumbered by Governor's Executive Order No. 3201, dated
June 8, 1983, setting aside 3,152.177 acres designated as Daniel K. Inouye
International Airport under the control and management of the State of Hawaii,
Department of Transportation, Airports (DOTA) for Airport Purposes.

CHARACTER OF USE:

Bowers + Kubota Consulting, Inc. will use the spaces for a field office and parking for
State Project No. BS1224-18, Construction Management Services for Passenger Loading
Bridge Maintenance for Statewide Airports, at Daniel K. Inouye International Airport.

COMMENCEMENT DATE:

To be determined by the Director of Transportation at a later date.

MONTHLY RENTAL:

\$25.00 (as stated in Contract No. 70780, State Project No. BS1224-18, Construction
Management Services for Passenger Loading Bridge Maintenance, Statewide Airports).

SECURITY DEPOSIT:

\$75.00, or three (3) times the monthly rental in effect.

DCCA VERIFICATION:

Place of business registration confirmed: YES X NO ___
Registered business name confirmed: YES X NO ___
Good standing confirmed: YES X NO ___

BLNR – ISSUANCE OF A REVOCABLE PERMIT FOR A FIELD OFFICE AND VEHICLE
PARKING FOR PASSENGER LOADING BRIDGE MAINTENANCE PROJECT
BOWERS + KUBOTA CONSULTING, INC.

Page 3

CHAPTER 343, HRS - ENVIRONMENTAL ASSESSMENT:

The environmental impacts of the proposed action to the subject land area are covered by the Honolulu International Airport, Airport Modernization Program Environmental Assessment (EA), State Project No. AO1030-13. The EA is a joint State and Federal document dated January 2013, and published in the February 8, 2013 issue of the OEQC Bulletin. Accordingly, the actions have been determined to have little or no impact upon the environment.

REMARKS:

In accordance with Section 171-55, HRS, relating to Permits, the DOTA proposes to issue a permit to Bowers + Kubota Consulting, Inc for a field office and vehicle parking, as specifically stated in Contract No. 70780, State Project No. BS1224-18 Construction Management Services for Passenger Loading Bridge Maintenance, Statewide Airports, 1.6 Field Office: "Pending the availability of space on airport property, the STATE may issue a Revocable Permit (RP) to the CONTRACTOR for the use of the space, assessed at the nominal monthly fee specified for the respective airport for each Revocable Permit issued. The space(s) shall be used only for a field office, and subject to the approval of the State, vehicle parking may be allowed."

RECOMMENDATION:

Based on this submittal, and testimony and facts presented, the Department of Transportation recommends the Board finds that approving the issuance of a month-to-month Revocable Permit to Bowers and Kubota Consulting, Inc., including its conditions and rent, will serve the best interests of the State.

Respectfully submitted,



EDWIN H. SNIFFEN
Director of Transportation

APPROVED FOR SUBMITTAL:



DAWN N. S. CHANG
Chairperson
Board of Land and Natural Resources

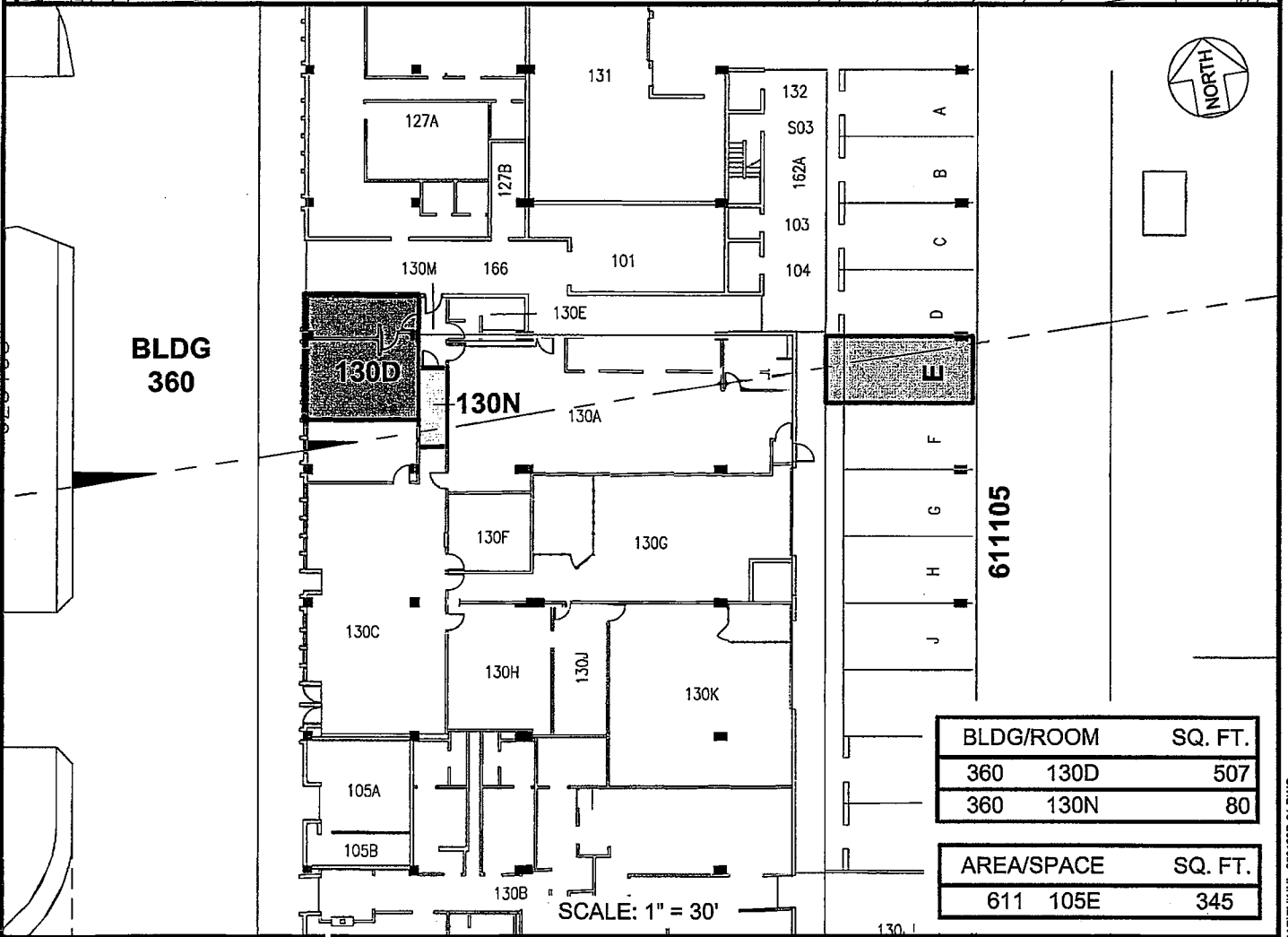
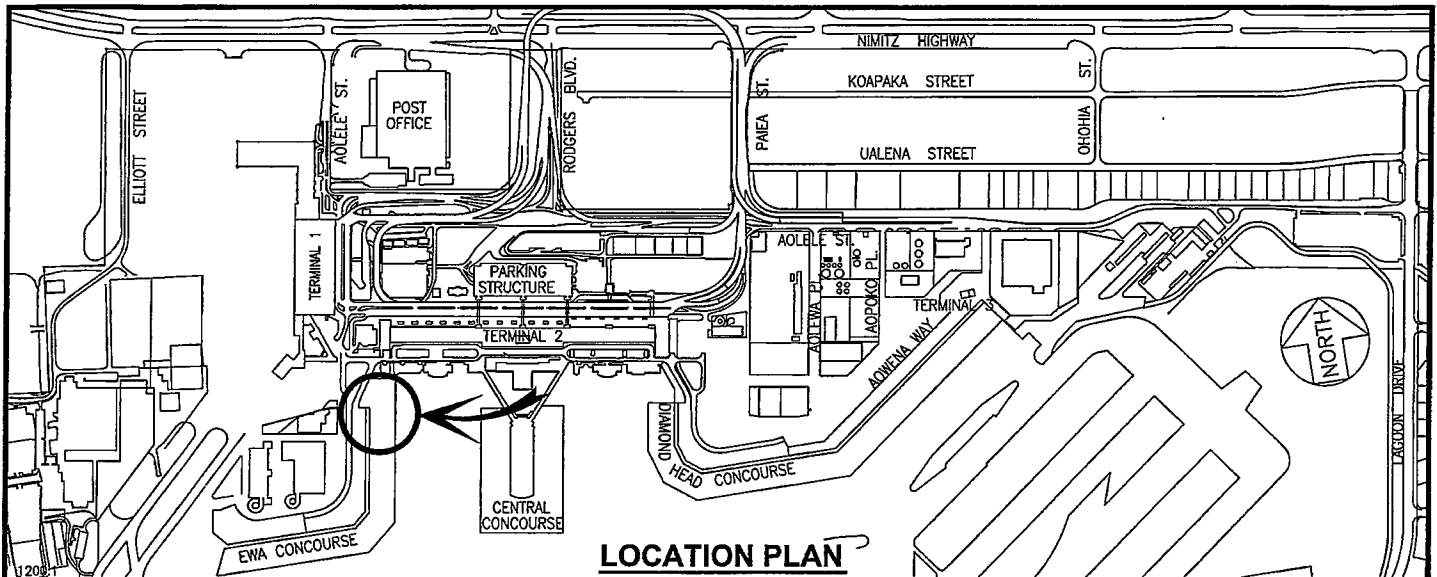

BLDG/ROOM	SQ. FT.
360 130D	507
360 130N	80
AREA/SPACE	SQ. FT.
611 105E	345

RP-9421	DATE : APRIL 2023	EXHIBIT: A
	BOWERS & KUBOTA CONSULTING, INC.	BLDG 360 & PARKING STALL EWA CONCOURSE GROUND LEVEL
		360130D,N 611105E

DANIEL K. INOUE INTERNATIONAL AIRPORT

N:\A1-REPORTS\HNL_HO\NOLULUCAD\RP\HNL_360130D-01.DWG