

JOSH GREEN, M.D.  
GOVERNOR



STATE OF HAWAII  
DEPARTMENT OF TRANSPORTATION  
869 PUNCHBOWL STREET  
HONOLULU, HAWAII 96813-5097

EDWIN H. SNIFFEN  
DIRECTOR

Deputy Directors  
FORD N. FUCHIGAMI  
DREANALEE K. KALILI  
TAMMY L. LEE  
ROBIN K. SHISHIDO

IN REPLY REFER TO:

Board of Land and  
Natural Resources  
State of Hawaii  
Honolulu, Hawaii

ISSUANCE OF A REVOCABLE PERMIT FOR  
STORAGE OF MATERIALS AND AIRCRAFT SUPPLIES  
CHOPPER DOCTOR, INC.  
DANIEL K. INOUE INTERNATIONAL AIRPORT  
TAX MAP KEY: (1) 1-1-072: 018 (PORTION)

OAHU

APPLICANT:

Chopper Doctor, Inc., whose business address is 1331 Ala Kapuna Street,  
Honolulu, Hawaii 96819.

LEGAL REFERENCE:

Section 171-55, Hawaii Revised Statutes.

LOCATION AND TAX MAP KEY:

A portion of Daniel K. Inouye International Airport (Airport), Island of Oahu, State of  
Hawaii, identified by Tax Map Key: 1<sup>st</sup> Division, 1-1-072: 018 (Portion).

AREA:

Building/Room No. 206-104A, containing an area of approximately 419 square feet, as  
shown and delineated on the attached map labeled Exhibit "A".

ZONING:

State Land Use District: Urban  
City and County of Honolulu LUO: Industrial (I-2)

**ITEM M-2**

BLNR – ISSUANCE OF A REVOCABLE PERMIT FOR STORAGE OF MATERIALS AND AIRCRAFT SUPPLIES, CHOPPER DOCTOR, INC.

Page 2

LAND TITLE STATUS:

Section 5(b) lands of the Hawaii Admission Act: Ceded  
DHHL 30% entitlement lands pursuant to Hawaii Admission Act    YES \_\_\_    NO X

CURRENT USE STATUS:

Land presently encumbered by Governor’s Executive Order No. 3201, dated June 8, 1983, setting aside 3,152.177 acres designated as Daniel K. Inouye International Airport under the control and management of the State of Hawaii, Department of Transportation, for Airport Purposes.

CHARACTER OF USE:

Chopper Doctor, Inc. will use the space for storage of materials and aircraft supplies

COMMENCEMENT DATE:

Upon execution of the revocable permit.

MONTHLY RENTAL:

\$600.30 per month (based upon a rate of \$9.72 per square foot per annum, as determined from the Schedule of Rates and Charges for Airport properties statewide).

SECURITY DEPOSIT:

\$1,800.90, or three (3) times the monthly rental in effect.

DCCA VERIFICATION:

Place of business registration confirmed:	YES <u>X</u>	NO ___
Registered business name confirmed:	YES <u>X</u>	NO ___
Good standing confirmed:	YES <u>X</u>	NO ___

CHAPTER 343, HRS - ENVIRONMENTAL ASSESSMENT:

The environmental impacts of the proposed action to the subject land area are covered by the Honolulu International Airport Master Plan Update and Noise Compatibility Program Environmental Assessment (EA), State Project No. AO1011-03. The EA is a joint State and Federal document, dated September 1989 and published in the October 23, 1989 issue of the OEQC Bulletin. Accordingly, relevant mitigation from the EA and Department of Transportation environmental best management practice will address minimal impacts from this action.

BLNR – ISSUANCE OF A REVOCABLE PERMIT FOR STORAGE OF MATERIALS AND AIRCRAFT SUPPLIES, CHOPPER DOCTOR, INC.

Page 3

REMARKS:

In accordance with Section 171-55 HRS, relating to Permits, the Department of Transportation proposes to issue a month-to-month revocable permit to Chopper Doctor, Inc. for the storage of materials and aircraft supplies at the Airport.

RECOMMENDATION:

Based on this submittal, and testimony and facts presented, the Department of Transportation recommends the Board finds that approving the issuance of a month-to-month Revocable Permit to Chopper Doctor, Inc., including its conditions and rent, will serve the best interests of the State.

Respectfully submitted,



EDWIN H. SNIFFEN  
Director of Transportation

APPROVED FOR SUBMITTAL:



DAWN N. S. CHANG  
Chairperson  
Board of Land and Natural Resources

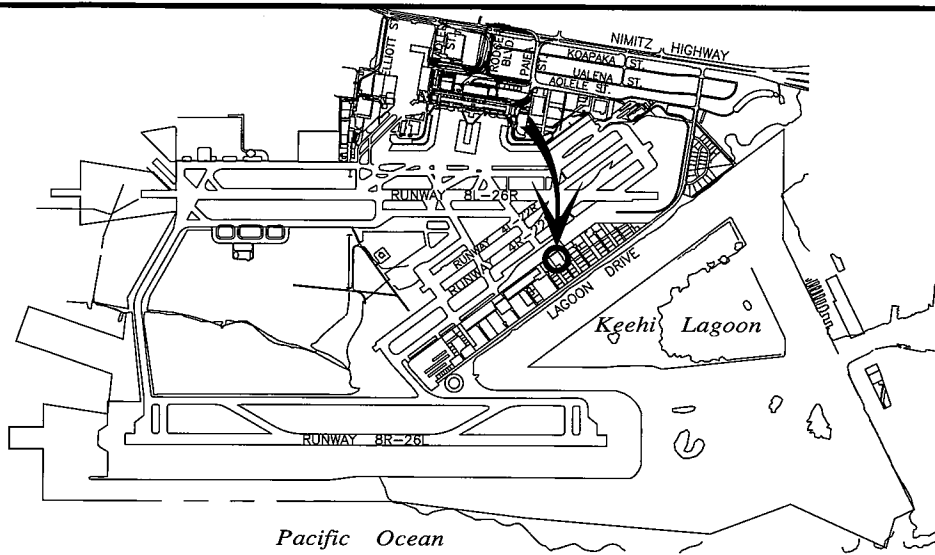

**LOCATION PLAN**

5000:1



**G.A.1  
BLDG 206**

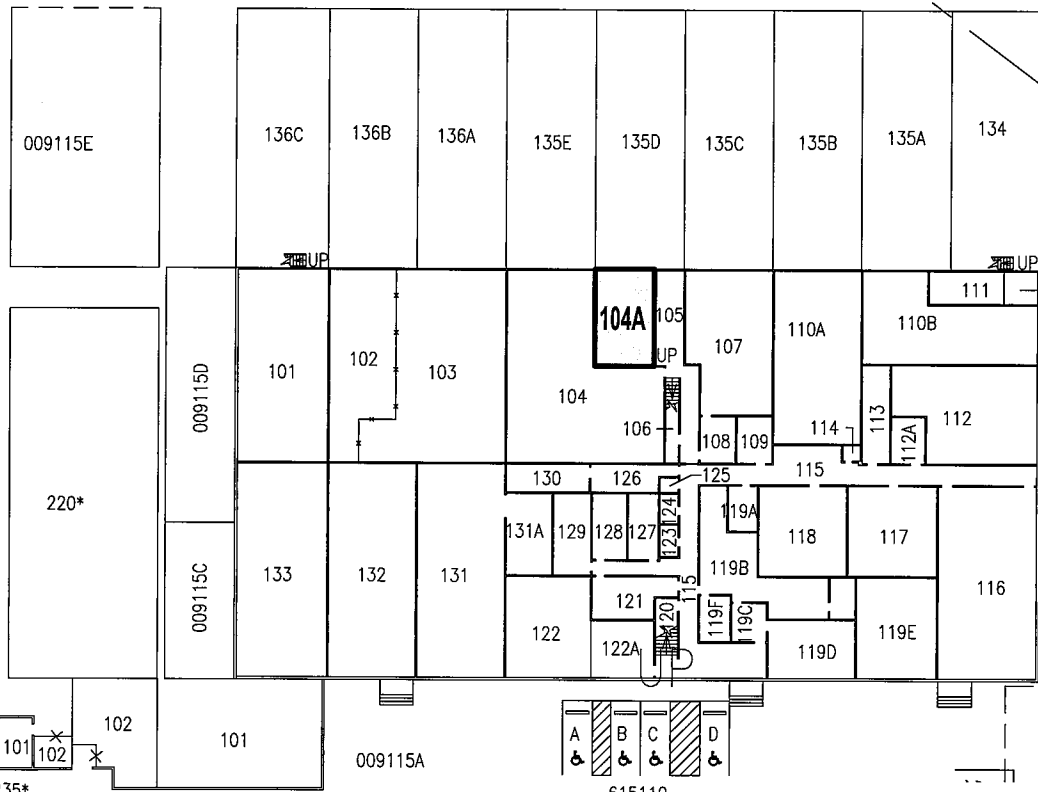

BLDG/ROOM	SQ. FT.
206 104A	419

SCALE: 1" = 50'

RP-9436

DATE: APRIL 2023

EXHIBIT: **A**



AIRPORTS

CHOPPER DOCTOR, INC.

**BUILDING 206  
OLD AIR SERVICE BLDG  
GROUND LEVEL**

206104A

**DANIEL K. INOUE INTERNATIONAL AIRPORT**

N:\AIRPORTS\HNL\_HONOLULU\CAD\PI\HNL\_206104A-01.DWG