



STATE OF HAWAII
DEPARTMENT OF TRANSPORTATION
869 PUNCHBOWL STREET
HONOLULU, HAWAII 96813-5097

EDWIN H. SNIFFEN
DIRECTOR

Deputy Directors
FORD N. FUCHIGAMI
DREANALEE K. KALILI
TAMMY L. LEE
ROBIN K. SHISHIDO

IN REPLY REFER TO:

Board of Land and
Natural Resources
State of Hawaii
Honolulu, Hawaii

ISSUANCE OF A REVOCABLE PERMIT FOR CARGO, WAREHOUSE,
OFFICES AND CONTAINER STORAGE FOR RETAIL GOODS
DISTRIBUTION AND CONTRACT HOME DELIVERY OPERATIONS
ISLAND MOVERS, INC.
HILO INTERNATIONAL AIRPORT
TAX MAP KEY: (3) 2-1-12: PORTION OF 009

HAWAII

LEGAL REFERENCE:

Section 171-55, Hawaii Revised Statutes (HRS), as amended.

APPLICANT:

Island Movers, Inc. (IMI), a Hawaii corporation, whose mailing address is
P.O. Box 17865, Honolulu, Hawaii 96817.

LOCATION AND TAX MAP KEY:

Portion of Hilo International Airport (ITO), Hilo, Island of Hawaii, identified by
Tax Map Key: 3rd Division, 2-1-12: Portion of 009.

AREAS:

Building/Room No. 139-102, containing an area of approximately 6,249 square feet,
Building/Room No. 139-110A, containing an area of approximately 828 square feet,
Building/Room No. 139-110B, containing an area of approximately 877 square feet,
Building/Room No. 139-116, containing an area of approximately 10,967 square feet, and
Area/Space Nos. 612-112N, P, Q, R, S, T & U, each containing an area of approximately 642
square feet of improved, paved land, as shown and delineated on the attached Exhibit A.

ZONING:

State Land Use District: Urban
County of Hawaii: Industrial (ML-20)

ITEM M-13

BLNR – ISSUANCE OF A REVOCABLE PERMIT FOR CARGO, WAREHOUSE, OFFICES AND CONTAINER STORAGE FOR RETAIL GOODS DISTRIBUTION AND CONTRACT HOME DELIVERY OPERATIONS, ISLAND MOVERS, INC.

Page 2

LAND TITLE STATUS:

Section 5(a) lands of the Hawaii Admission Act: Ceded
DHHL 30% entitlement lands pursuant to the Hawaii Admission Act: YES ___ NO X

CURRENT USE STATUS:

Land presently encumbered by Governor's Executive Order No. 1519, dated July 17, 1952, setting aside 550.881 acres, being a portion of General Lyman Field under the control and management of the Hawaii Aeronautics Commission (subsequently transferred to the Department of Transportation) as a site for the Hilo Airport, now known as Hilo International Airport.

CHARACTER OF USE:

IMI will use Building/Room Nos. 139-102 and 139-116 as warehouse, storage, and distribution areas to support its retail goods distribution and contract home delivery operations at ITO.

IMI will use Building/Room Nos. 139-110A and 139-110B as offices to support its retail goods distribution and contract home delivery operations at ITO.

IMI will use Area/Space Nos. 612-112N, P, Q, R, S, T & U as container storage to support its retail goods distribution and contract home delivery operations at ITO.

COMMENCEMENT DATE:

To be determined by the Director of Transportation at a later date.

MONTHLY RENTAL:

\$19,711.27 (\$16,873.12 based on the cargo warehouse rate of \$9.60 per square foot per annum, the cargo office rate of \$15.60 per square foot per annum, and the improved, paved land a rate of \$2.36 per square foot per annum as determined from the Department of Transportation, Airports schedule of rates and charges established by appraisal of Airports property statewide, plus \$2,838.15 for maintenance.)

SECURITY DEPOSIT:

\$59,133.81, or three times the monthly rental in effect.

BLNR – ISSUANCE OF A REVOCABLE PERMIT FOR CARGO, WAREHOUSE, OFFICES AND CONTAINER STORAGE FOR RETAIL GOODS DISTRIBUTION AND CONTRACT HOME DELIVERY OPERATIONS, ISLAND MOVERS, INC.

Page 3

DCCA VERIFICATION:

Place of business registration confirmed: YES X NO _____
Registered business name confirmed: YES X NO _____
Good standing confirmed: YES X NO _____

CHAPTER 343, HRS - ENVIRONMENTAL ASSESSMENT:

The State of Hawaii, Department of Transportation, Airports, deems this action as de minimis and is exempt from the preparation of an exemption notice in accordance with HAR, Section 11-200.1-16(b) and the Department of Transportation (DOT), Comprehensive Exemption List, concurred to by the Environmental Advisory Council on February 1, 2022, Exemption Type 8, Part 1 (8)g: Creation or extensions of leases, revocable permits or easements of property for continuing aeronautical or maritime uses or complementary purposes.

REMARKS:

In accordance with Section 171-55, HRS, relating to Permits, the DOT proposes to issue a month-to-month Revocable Permit to IMI for warehouses, offices, and container storage to support its retail goods distribution and contract home delivery operations at ITO.

RECOMMENDATION:

Based on this submittal, and testimony and facts presented, the DOT recommends the Board finds that approving the issuance of a month-to-month Revocable Permit to IMI, including its conditions and rent, will serve the best interests of the State.

Respectfully submitted,



EDWIN H. SNIFFEN
Director of Transportation

APPROVED FOR SUBMITTAL:



DAWN N. S. CHANG
Chairperson
Board of Land and Natural Resources

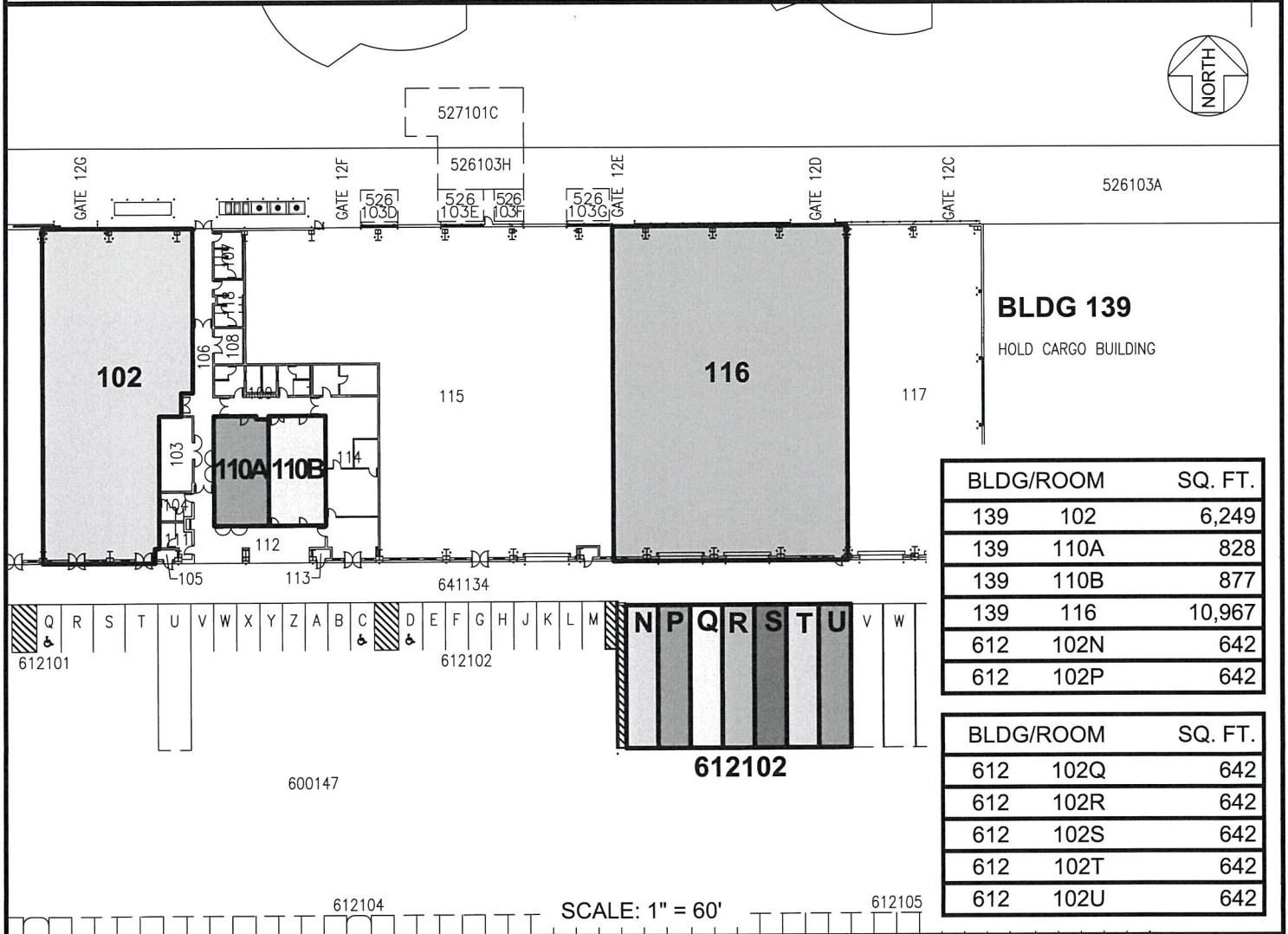
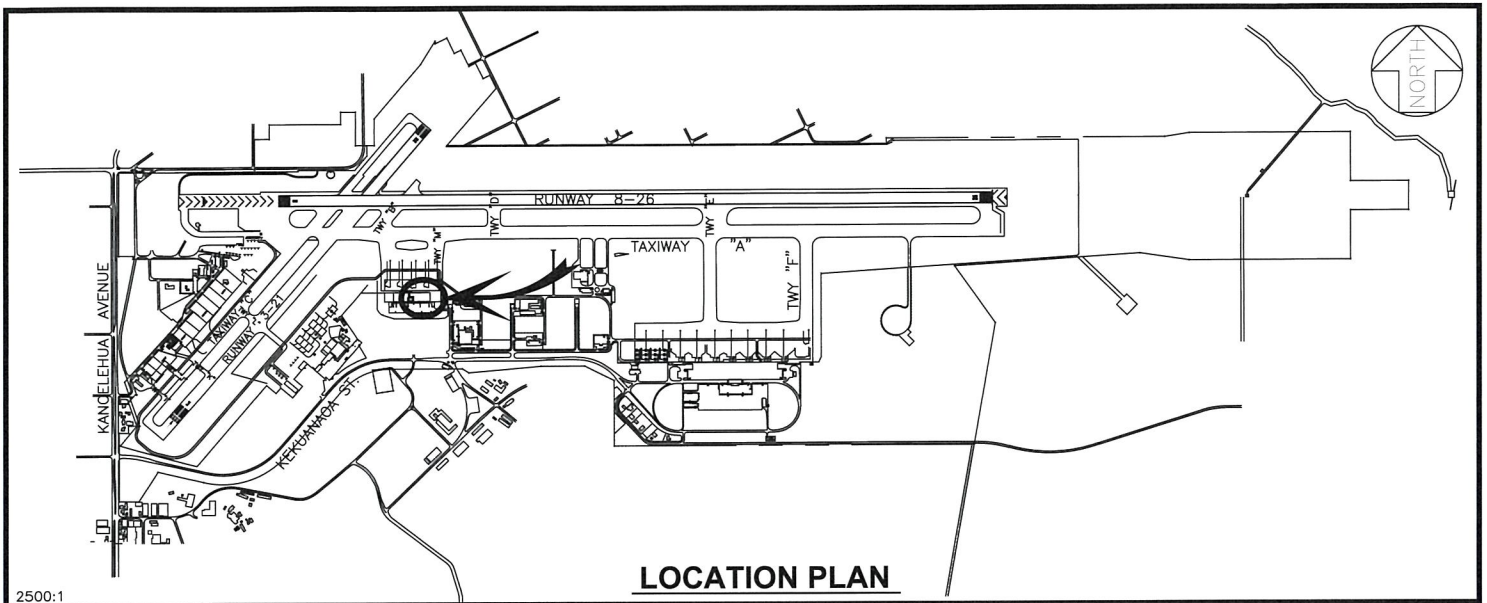

RP-9437 DATE : FEBRUARY 2023 EXHIBIT: **A**

	ISLAND MOVERS, INC.	BUILDING 139 HOLD CARGO BLDG GROUND LEVEL	139102 139110A-B 612102N-U PLAT 31
--	---------------------	---	---

HILO INTERNATIONAL AIRPORT

N:\AIRPORTS\HILO\CAD\PIWITO_139102-02.DWG