



**STATE OF HAWAII**  
**DEPARTMENT OF TRANSPORTATION**  
869 PUNCHBOWL STREET  
HONOLULU, HAWAII 96813-5097

EDWIN H. SNIFFEN  
DIRECTOR

Deputy Directors  
FORD N. FUCHIGAMI  
DREANALEE K. KALILI  
TAMMY L. LEE  
ROBIN K. SHISHIDO

IN REPLY REFER TO:

Board of Land and  
Natural Resources  
State of Hawaii  
Honolulu, Hawaii

ISSUANCE OF A REVOCABLE PERMIT FOR AN  
EMPLOYEE BREAK ROOM AND STORAGE SPACE  
ALCLEAR, LLC DBA CLEAR  
DANIEL K. INOUE INTERNATIONAL AIRPORT  
TAX MAP KEY: (1) 1-1-003: 001 (PORTION)

OAHU

APPLICANT/LESSEE:

ALCLEAR, LLC DBA CLEAR (CLEAR), whose mailing address is 85 Tenth Avenue,  
9TH Floor, New York, New York 10011.

LEGAL REFERENCE:

Section 171-55, Hawaii Revised Statutes (HRS), as amended.

LOCATION AND TAX MAP KEY:

Portion of Building 310, Ground Floor of the Inter-Island Terminal (Terminal 1), and  
Portion of Building 352, Ground Floor of the International Arrivals (Terminal 2), at the  
Daniel K. Inouye International Airport (Airport), Island of Oahu, State of Hawaii,  
identified by Tax Map Key: 1<sup>st</sup> Division, 1-1-003: 001 (Portion).

AREA:

Building/Room No. 310-153, consisting of approximately 291 square feet;  
Building/Room No. 310-154A, consisting of approximately 139 square feet; and  
Building/Room No. 310-154B, consisting of approximately 152 square feet,  
as shown and delineated on the attached map labeled Exhibit "A".

Building/Room No. 352-102, consisting of approximately 355 square feet,  
as shown and delineated on the attached map labeled Exhibit "B".

**ITEM M-2**

BLNR – ISSUANCE OF A REVOCABLE PERMIT FOR AN EMPLOYEE BREAK ROOM AND STORAGE SPACE, ALCLEAR, LLC DBA CLEAR

Page 2

ZONING:

State Land Use District: Urban  
City and County of Honolulu: I-2 (Industrial)

LAND TITLE STATUS:

Section 5(a) lands of the Hawaii Admissions Act: Non-ceded  
DHHL 30% entitlement lands pursuant to the Hawaii State Constitution: YES \_\_\_ NO X

CURRENT USE STATUS:

Land presently encumbered by Governor’s Executive Order No. 3201, dated June 8, 1983, setting aside 3,152.177 acres designated as the Airport under the control and management of the State of Hawaii, Department of Transportation, Airports (DOTA), for Airport Purposes.

CHARACTER OF USE:

Employee Break room and storage space to support CLEAR’s Registered Traveler Program at the Airport.

COMMENCEMENT DATE:

Upon complete execution of the revocable permit.

MONTHLY RENTAL:

\$1,770.69 (\$1,259.76, as determined from the DOTA schedule of rates and charges established by appraisal of Airport property statewide, \$510.93 for utilities).

SECURITY DEPOSIT:

\$5,312.07, or three (3) times the monthly rent in effect.

DCCA VERIFICATION:

Place of business registration confirmed:	YES <u>X</u>	NO ___
Registered business name confirmed:	YES <u>X</u>	NO ___
Good standing confirmed:	YES <u>X</u>	NO ___

CHAPTER 343, HRS - ENVIRONMENTAL ASSESSMENT:

The environmental impacts of the proposed action to the subject land area are covered by the Honolulu International Airport Master Plan Update and Noise Compatibility Program Environmental Assessment (EA), State Project No. AO1011-03. The EA is a joint State

BLNR – ISSUANCE OF A REVOCABLE PERMIT FOR AN EMPLOYEE BREAK ROOM  
AND STORAGE SPACE, ALCLEAR, LLC DBA CLEAR

Page 3

and Federal document, dated September 1989 and published in the October 23, 1989 issue of the OEQC Bulletin. Accordingly, relevant mitigation from the EA and DOTA environmental best management practice will address minimal impacts from this action.

REMARKS:

In accordance with Section 171-55, HRS, relating to Permits, the Department of Transportation proposes to issue a month-to-month revocable permit to CLEAR for an employee break room and storage space to support CLEAR's Registered Traveler Program at the Airport.

RECOMMENDATION:

Based on this submittal, and testimony and facts presented, the Department of Transportation recommends the Board finds that approving the issuance of a month-to-month Revocable Permit to CLEAR, including its conditions and rent, will serve the best interests of the State.

Respectfully submitted,



EDWIN H. SNIFFEN  
Director of Transportation

APPROVED FOR SUBMITTAL:



DAWN N. S. CHANG  
Chairperson  
Board of Land and Natural Resources

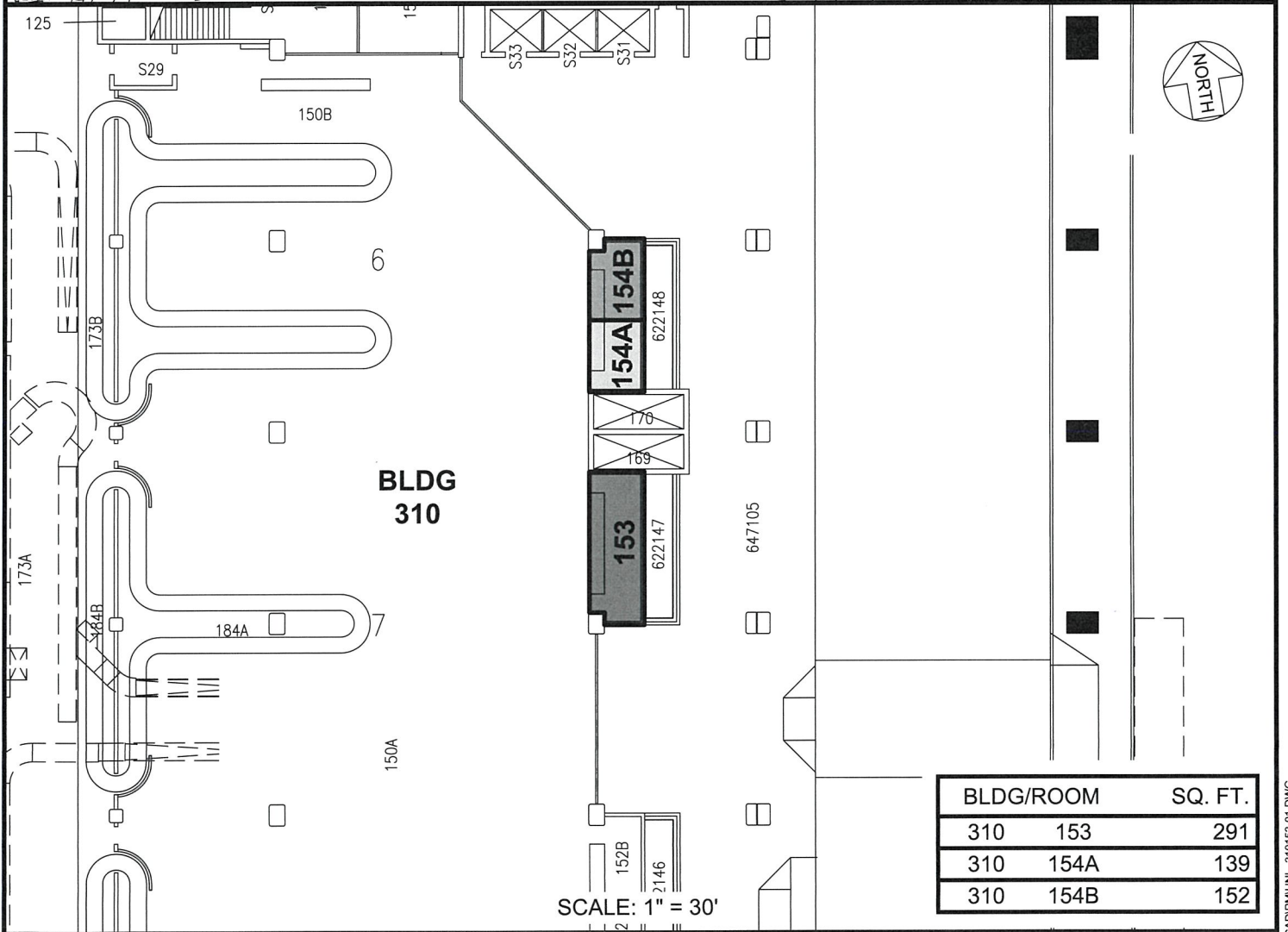
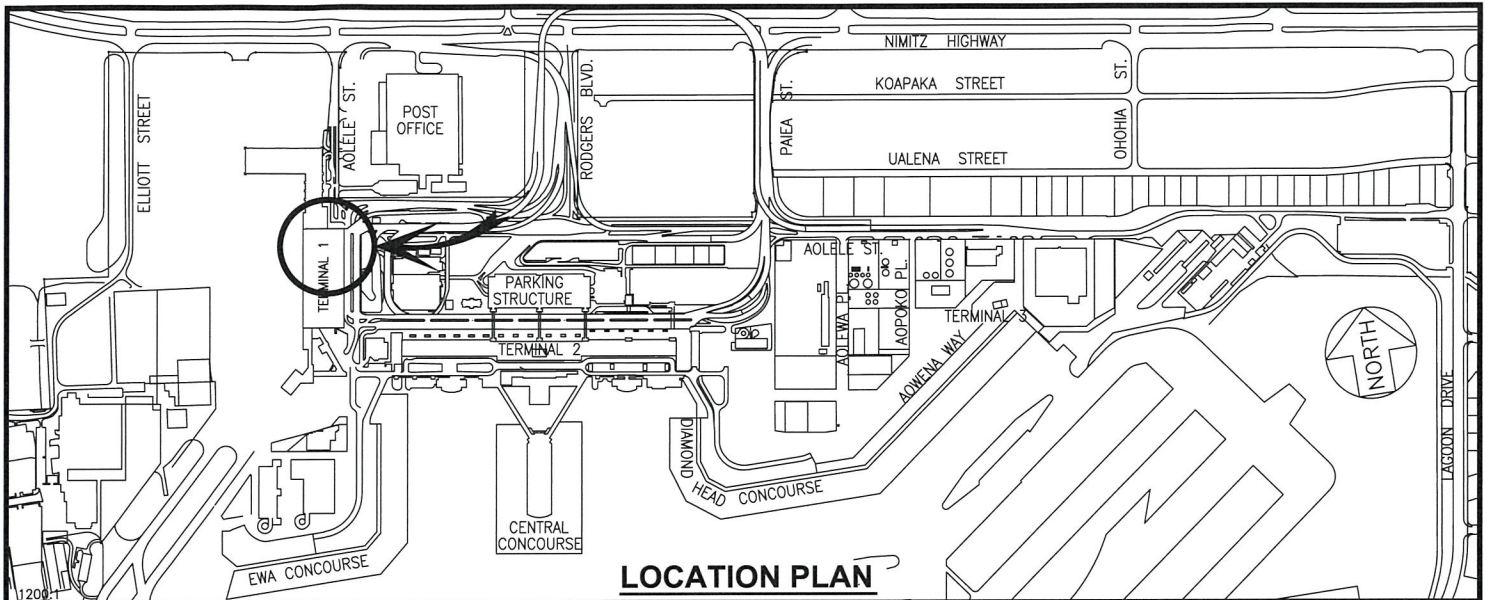

BLDG/ROOM	SQ. FT.
310 153	291
310 154A	139
310 154B	152

DATE : JUNE 2023

EXHIBIT: **A**



ALCLEAR, LLC  
dba CLEAR

BUILDING 310  
INTER-ISLAND TERMINAL  
GROUND LEVEL

310153  
310154A  
310154B

DANIEL K. INOUE INTERNATIONAL AIRPORT



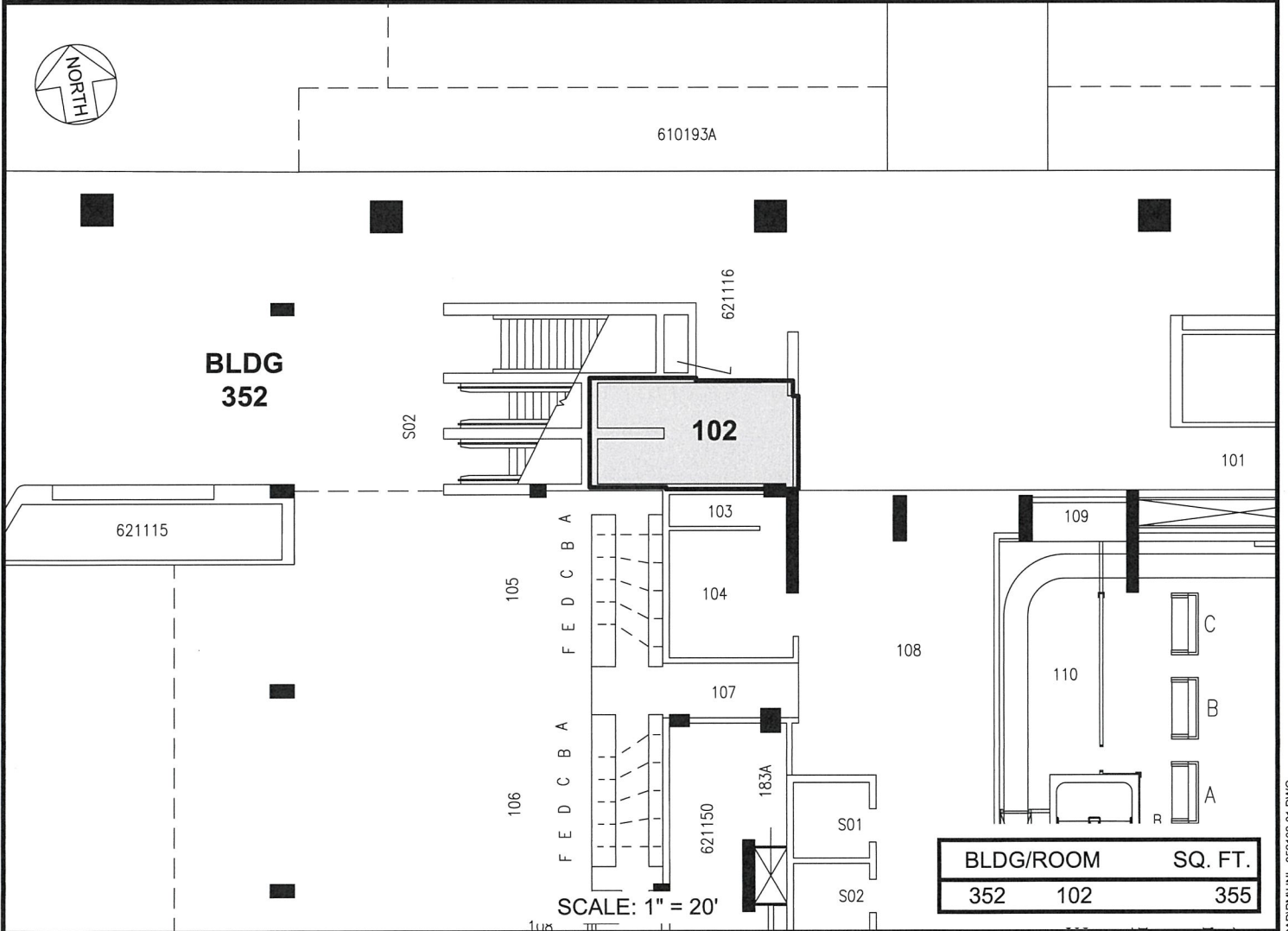
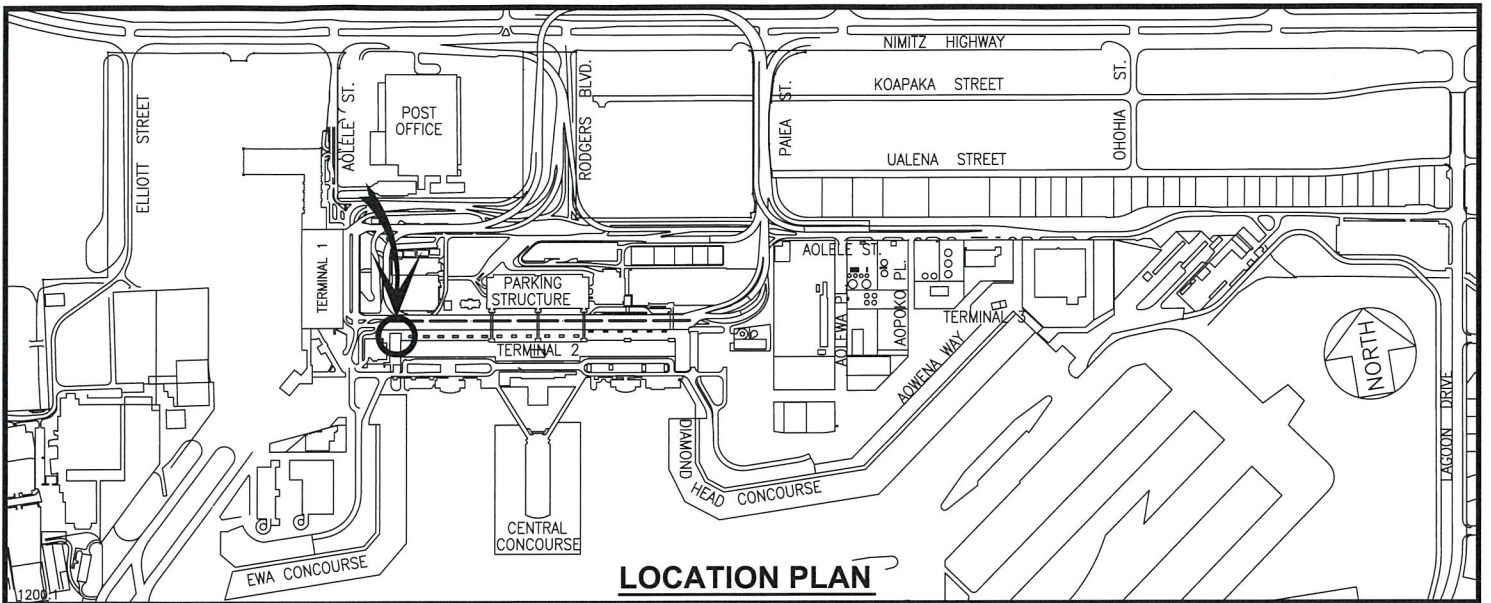

DATE : JUNE 2023

EXHIBIT: **B**



ALCLEAR, LLC  
dba CLEAR

BUILDING 352  
EWA INT'L ARRIVALS  
GROUND LEVEL

352102