



STATE OF HAWAII
DEPARTMENT OF TRANSPORTATION
869 PUNCHBOWL STREET
HONOLULU, HAWAII 96813-5097

EDWIN H. SNIFFEN
DIRECTOR

Deputy Directors
FORD N. FUCHIGAMI
DREANALEE K. KALILI
TAMMY L. LEE
ROBIN K. SHISHIDO

IN REPLY REFER TO:

Board of Land and
Natural Resources
State of Hawaii
Honolulu, Hawaii

ISSUANCE OF A REVOCABLE PERMIT FOR COMMERCIAL USE OF A
T-HANGAR FOR STORAGE AND MAINTENANCE FOR TWO AIRCRAFT IN
SUPPORT OF A COMMERCIAL AERONAUTICAL GYROCOPTER
FLIGHT INSTRUCTION BUSINESS
GYROCOPTERS HAWAII LLC DBA SKYLAND AIR
KAWAIHAPAI AIRFIELD, WAIALUA, HAWAII
TAX MAP KEY: (1) 6-8-014:017 (PORTION)

OAHU

REQUEST:

Issuance of a Revocable Permit for commercial use a T-Hangar for storage and maintenance of two aircraft to Gyrocopters Hawaii LLC dba Skyland Air, situated at Kawaihapai Airfield fka Dillingham Airfield.

APPLICANT:

Gyrocopters Hawaii LLC dba Skyland Air, whose mailing address is P.O. Box 911272, Waialua, Hawaii 96791.

LEGAL REFERENCE:

Section 171-55, Hawaii Revised Statutes (HRS), as amended.

LOCATION AND TAX MAP KEY:

A portion of the Kawaihapai Airfield, Waialua, Island of Oahu, State of Hawaii, identified by Tax Map Key: 1st Division, 6-8-014:017 (portion).

AREA:

Bldg/Room No. 402-107, containing an area of approximately 1,107 square feet, as shown and delineated on the attached map labeled Exhibit "A".

ITEM M-1

BLNR – ISSUANCE OF A REVOCABLE PERMIT FOR COMMERCIAL USE OF A
T-HANGAR FOR STORAGE AND MAINTENANCE OF TWO AIRCRAFT IN SUPPORT OF
A COMMERCIAL AERONAUTICAL GYROCOPTER FLIGHT INSTRUCTION BUSINESS
GYROCOPTERS HAWAII LLC DBA SKYLAND AIR
Page 2

ZONING:

State Land Use District: Agriculture
City and County of Honolulu LUO: AG-2

LAND TITLE STATUS:

Ceded land, which the State of Hawaii is currently leasing the land from the
United States of America.

CHARACTER OF USE:

Commercial use of a T-Hangar for storage and maintenance of two aircraft, (2022
AutoGyro GMBH MTO Sport, Tail No. N-808FU and 2022 AutoGyro GMBH MTO,
Tail No. N-808XS).

COMMENCEMENT DATE:

To be determined by the Director of Transportation at a later date.

MONTHLY RENTAL:

\$553.50 per month (as determined from the Schedule of Rates and Charges established
by appraisal of Airport properties statewide).

SECURITY DEPOSIT:

\$1,660.50, or three times the monthly rental in effect.

CHAPTER 343, HRS - ENVIRONMENTAL ASSESSMENT:

The subject land area is covered by the revised and updated Environmental Assessment
for the Dillingham Airfield Master Plan and FAR Part 150 Noise Compatibility Program
project, referenced as State Contract No. 26985, State Project No. AO2011-01. This
Environmental Assessment evaluated the environmental effects of the recommended
Dillingham Airfield Master Plan to meet existing and forecast general aviation demands
and was prepared for the State of Hawaii, Department of Transportation, Airports.

BLNR – ISSUANCE OF A REVOCABLE PERMIT FOR COMMERCIAL USE OF A T-HANGAR FOR STORAGE AND MAINTENANCE OF TWO AIRCRAFT IN SUPPORT OF A COMMERCIAL AERONAUTICAL GYROCOPTER FLIGHT INSTRUCTION BUSINESS GYROCOPTERS HAWAII LLC DBA SKYLAND AIR

Page 3

REMARKS:

In accordance with Section 171-55, HRS, relating to Permits, the Department of Transportation proposes to issue a month-to-month Revocable Permit to Gyrocopters Hawaii LLC dba Skyland Air at Kawaihapai Airfield fka Dillingham Airfield, for commercial use of a T-Hangar for storage and maintenance of two aircraft in support of their gyrocopter flight instruction business.

RECOMMENDATION:

Based on this submittal, and testimony and facts presented, the Department of Transportation recommends the Board finds that approving the issuance of a month-to-month Revocable Permit to Gyrocopters Hawaii LLC dba Skyland Air, including its conditions and rent, will serve the best interests of the State.

Respectfully submitted,



EDWIN H. SNIFFEN
Director of Transportation

APPROVED FOR SUBMITTAL:



DAWN N. S. CHANG
Chairperson
Board of Land and Natural Resources

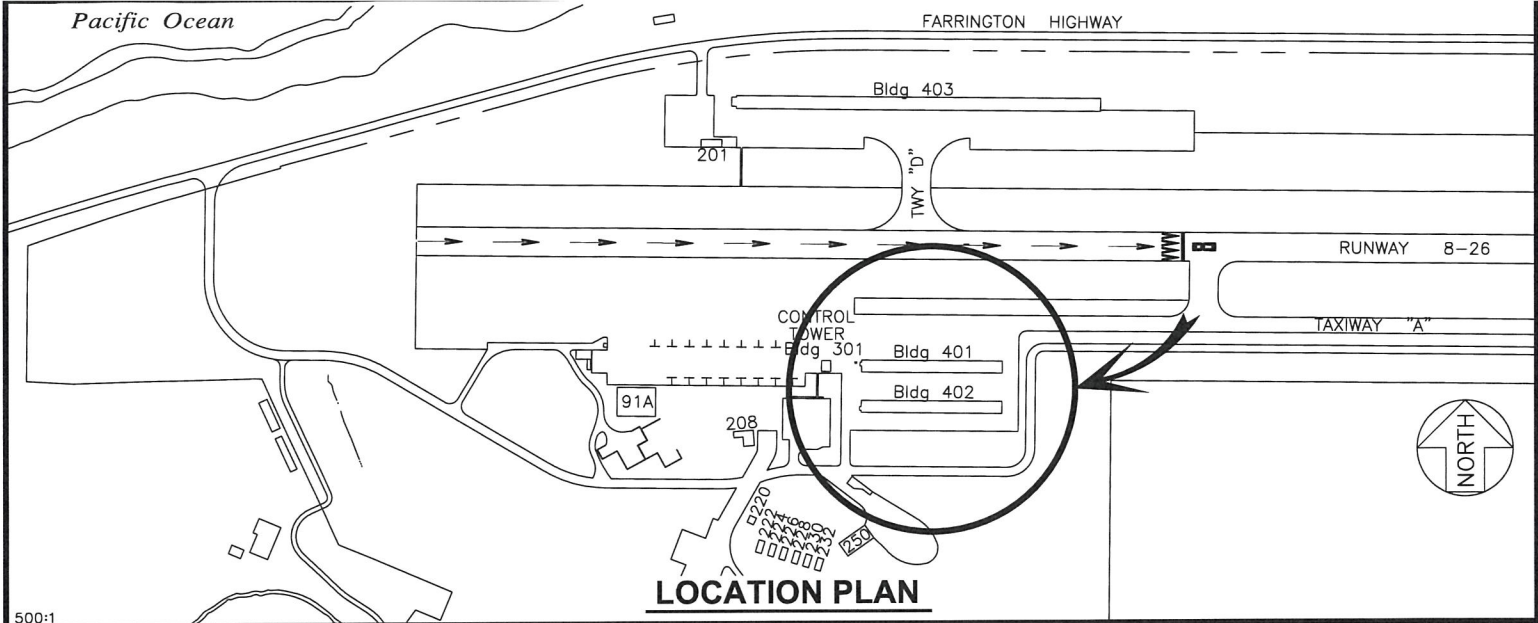

500:1

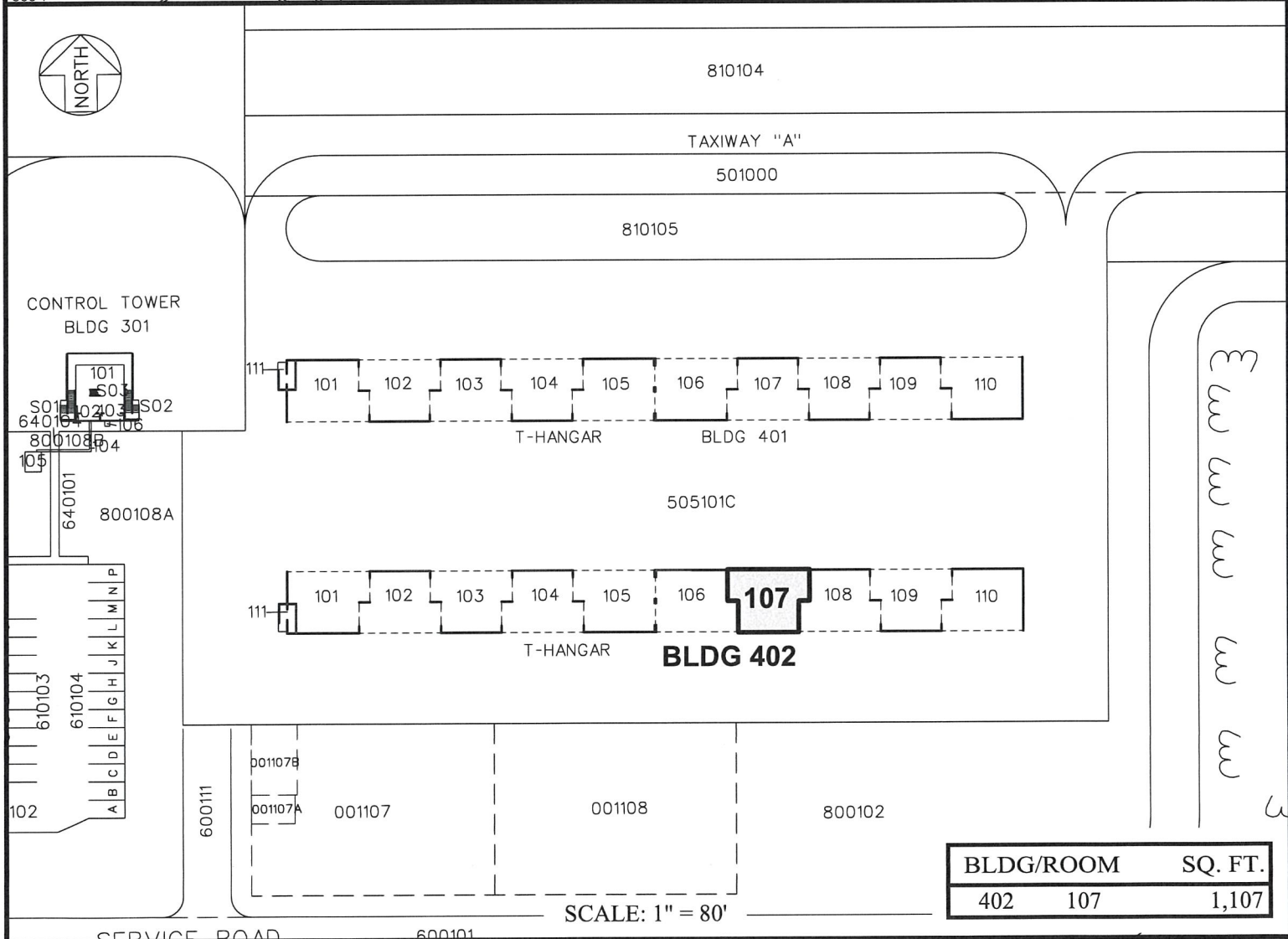

RP-9465

DATE : JULY 2023

EXHIBIT: **A**



Airports

GYROCOPTERS HAWAII LLC
dba SKYLAND AIR

T-HANGAR

402107

DILLINGHAM AIRFIELD

N:\AIRPORTS\HDH_Dillingham\CAD\PM\hnh_402107-01.dwg