

JOSH GREEN, M.D.  
GOVERNOR



EDWIN H. SNIFFEN  
DIRECTOR

Deputy Directors  
FORD N. FUCHIGAMI  
DREANALEE K. KALILI  
TAMMY L. LEE  
ROBIN K. SHISHIDO

IN REPLY REFER TO:

STATE OF HAWAII  
DEPARTMENT OF TRANSPORTATION  
869 PUNCHBOWL STREET  
HONOLULU, HAWAII 96813-5097

Board of Land and  
Natural Resources  
State of Hawaii  
Honolulu, Hawaii

ISSUANCE OF A REVOCABLE PERMIT FOR A HANGAR AND IMPROVED, PAVED  
LAND TO SUPPORT PART 135 HELICOPTER ON-DEMAND AIR SERVICE AND  
PART 133 CLASS A UTILITY WORK OPERATIONS  
SAFARI AVIATION, INC.  
WAIMEA-KOHALA AIRPORT  
TAX MAP KEY: (3) 6-7-001: PORTION OF 008

HAWAII

LEGAL REFERENCE:

Section 171-55, Hawaii Revised Statutes (HRS), as amended.

APPLICANT:

Safari Aviation, Inc. (Safari), whose mailing address is 3225 Akahi Street,  
Lihue, Hawaii 96766.

LOCATION AND TAX MAP KEY:

Portion of Waimea-Kohala Airport (MUE), Kamuela, Island of Hawaii, identified by  
Tax Map Key: 3<sup>rd</sup> Division, 6-7-001: Portion of 008.

AREA:

Building/Room No. 105-101, containing an area of approximately 3,600 square feet, and  
Area/Space No. 001-105, containing an area of approximately 1,300 square feet of improved,  
paved land, as shown and delineated on the attached Exhibit A.

ZONING:

State Land Use District:	Agricultural District
County of Hawaii:	A-40A Agriculture

**ITEM M-10**

BLNR – ISSUANCE OF A REVOCABLE PERMIT FOR A HANGAR AND IMPROVED, PAVED LAND AND TO SUPPORT PART 135 HELICOPTER ON-DEMAND AIR SERVICE AND PART 133 CLASS A UTILITY WORK OPERATIONS, SAFARI AVIATION, INC.

Page 2

LAND TITLE STATUS:

Section 5(a) lands of the Hawaii Admission Act: Non-Ceded  
DHHL 30% entitlement lands pursuant to Hawaii Admission Act YES \_\_\_ NO X

CURRENT USE STATUS:

Land presently encumbered by Governors Executive Order No. 1789, dated May 21, 1957, setting aside 89.718 acres, being a portion of Waimea-Kohala Airport under the control and management of the Hawaii Aeronautics Commission (subsequently transferred to the Department of Transportation) for Airport Purposes.

CHARACTER OF USE:

Safari will use the area for the storage of aircraft, parts and equipment, and a satellite aircraft maintenance base to support its Part 135 helicopter on-demand air service and Part 133 Class A Utility Work operations.

COMMENCEMENT DATE:

To be determined by the Director of Transportation at a later date.

MONTHLY RENTAL:

\$891.00 (based on a rate of \$2.97 per square foot per annum for Building/Room No. 105-101, as determined from the State of Hawaii, Department of Transportation, (HDOT), Schedule of Rates and Charges established by appraisal of Airports property statewide).

SECURITY DEPOSIT:

\$2,673.00, or three times the monthly rental in effect.

DCCA VERIFICATION:

Place of business registration confirmed:	YES <u>X</u>	NO ___
Registered business name confirmed:	YES <u>X</u>	NO ___
Good standing confirmed:	YES <u>X</u>	NO ___

CHAPTER 343, HRS - ENVIRONMENTAL ASSESSMENT:

HDOT, has determined that the environmental impacts of the proposed tenant lease for the subject land use is covered by the Waimea-Kohala Airport Final Environmental Assessment (FEA), published by the Office of Environmental Quality Control (OEQC) in the

BLNR – ISSUANCE OF A REVOCABLE PERMIT FOR A HANGAR AND IMPROVED,  
PAVED LAND AND TO SUPPORT PART 135 HELICOPTER ON-DEMAND AIR SERVICE  
AND PART 133 CLASS A UTILITY WORK OPERATIONS, SAFARI AVIATION, INC.

Page 3

November 8, 1999, issue of The Environmental Notice. Accordingly, all relevant mitigation from the FEA and best management practices will be implemented to address the minimum impacts of this action.

REMARKS:

In accordance with Section 171-55, HRS, relating to Permits, HDOT proposes to issue a month-to-month revocable permit to Safari for a Hangar for the storage of aircraft, parts and equipment, and a satellite aircraft maintenance base, and improved, paved land to support its Part 135 helicopter on-demand air service and Part 133 Class A Utility Work operations.

RECOMMENDATION:

Based on this submittal, and testimony and facts presented, HDOT recommends the Board finds that approving the issuance of a month-to-month revocable permit to Safari, including its conditions and rent, will serve the best interests of the State.

Respectfully submitted,



EDWIN H. SNIFFEN  
Director of Transportation

APPROVED FOR SUBMITTAL:



DAWN N. S. CHANG  
Chairperson  
Board of Land and Natural Resources

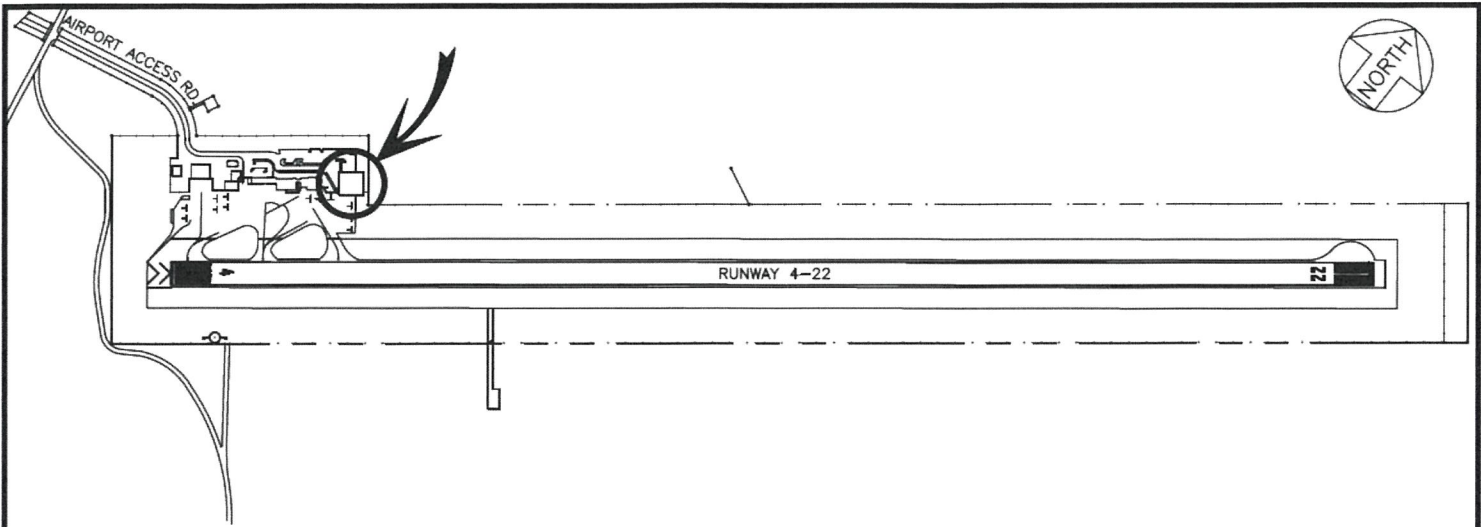

**LOCATION PLAN**

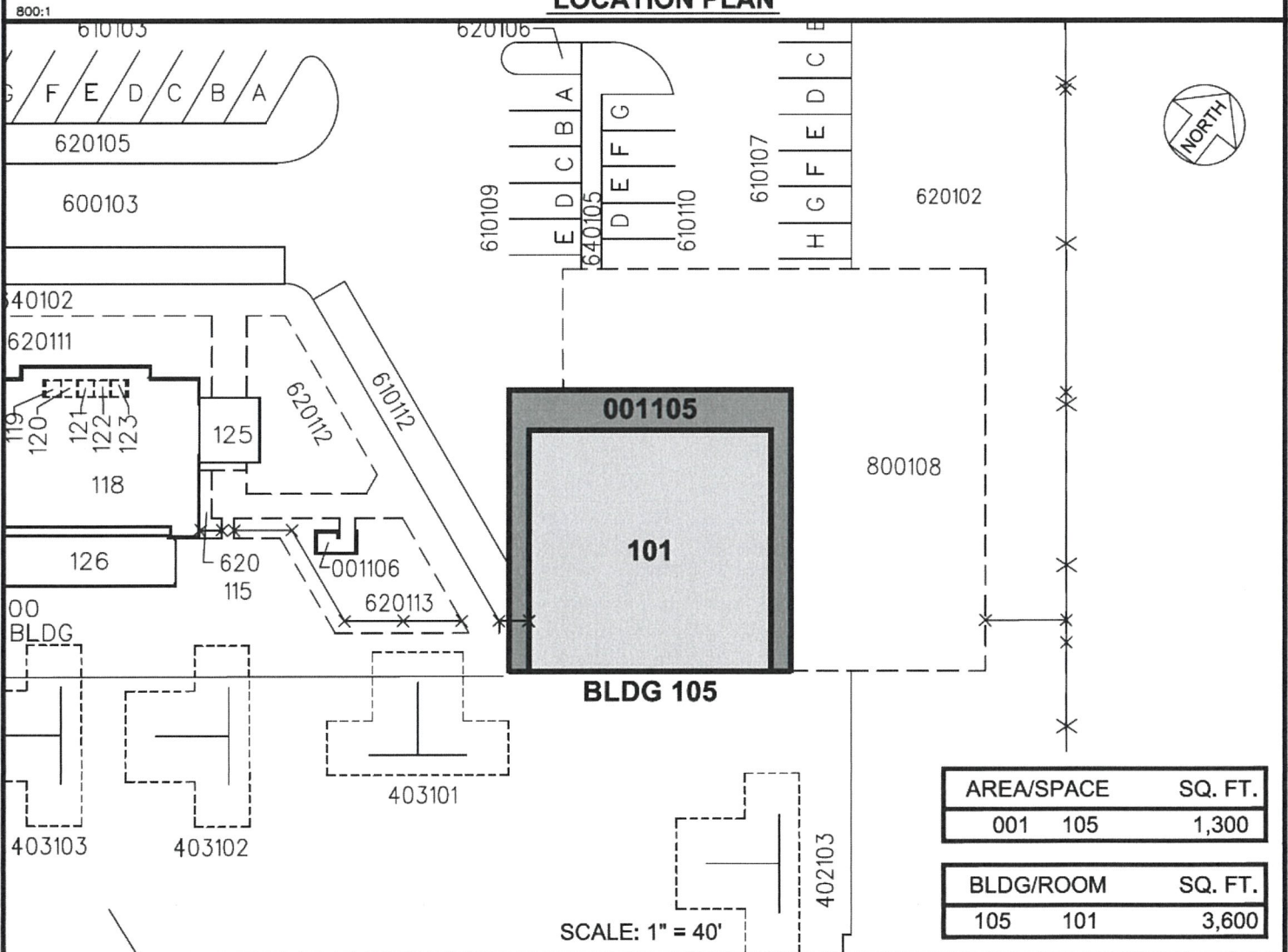

DATE : FEBRUARY 2023

EXHIBIT: **A**



Alports

SAFARI AVIATION, INC.

BLDG 105  
HANGAR BUILDING  
GROUND LEVEL

001105  
105101

PLAT A1,41

**WAIMEA-KOHALA AIRPORT**

N:\AIRPORTS\MUE\_WAIMEA-KOHALA\CADD\PM\MUE\_105101-01.DWG