



STATE OF HAWAII
DEPARTMENT OF TRANSPORTATION
869 PUNCHBOWL STREET
HONOLULU, HAWAII 96813-5097

Board of Land and
Natural Resources Hawaii
State of Hawaii
Honolulu, Hawaii

ISSUANCE OF A REVOCABLE PERMIT FOR USE OF A T-HANGAR
FOR STORAGE AND MAINTENANCE OF A PERSONAL AIRCRAFT
THE AFFORDABLE CASKET OUTLET, L.L.C.
KALAELOA AIRPORT
TAX MAP KEY: (1) 9-1-013: PORTION OF 32

OAHU

REQUEST:

Issuance of a revocable permit for use of a T-Hangar for storage and maintenance of a personal aircraft to The Affordable Casket Outlet, L.L.C., situated at Kalaeloa Airport.

LEGAL REFERENCE:

Section 171-55, Hawaii Revised Statutes (HRS) as amended.

APPLICANT:

The Affordable Casket Outlet L.L.C., whose mailing address is P.O. Box 23131, Honolulu, Hawaii 96823.

LOCATION AND TAX MAP KEY:

A portion of Kalaeloa Airport, Kapolei, Island of Oahu, State of Hawaii, identified by Tax Map Key: 1st Division, 9-1-13: portion of 32.

AREA:

Large Plane Hangar Unit No. 410-106, containing an area of approximately 1,763 square feet, as shown and delineated on the attached map labeled Exhibit "A".

ITEM M-3

BLNR – ISSUANCE OF A REVOCABLE PERMIT FOR USE OF A T-HANGAR
FOR STORAGE AND MAINTENANCE OF A PERSONAL AIRCRAFT
THE AFFORDABLE CASKET OUTLET, L.L.C.

Page 2

ZONING:

State Land Use District: Urban
City and County of Honolulu LUO: P-2 (To be rezoned in the future)

LAND TITLE STATUS:

Non-Ceded - Section 5(a) lands of the Hawaii Admission Act
DHHL 30% entitlement lands pursuant to Hawaii Admission Act YES ___ NO X

CURRENT USE STATUS:

Land presently encumbered by Governor's Executive Order No. 3861, setting aside
Kalaeloa Airport under the control and management of the State of Hawaii, Department
of Transportation for Airport Purposes.

CHARACTER OF USE:

T-Hangar for storage and maintenance of a personal aircraft (1984 Yakovlev YAK52,
Tail No. N-9859).

COMMENCEMENT DATE:

To be determined by the Director of Transportation at a later date.

MONTHLY RENTAL:

\$875.00 (as determined from the Schedule of Rates and Charges established by appraisal
of Airport properties statewide).

SECURITY DEPOSIT:

\$2,625.00, or three times the monthly rental in effect.

DCCA VERIFICATION:

| | | |
|---|--------------|----------|
| Place of business registration confirmed: | YES <u>X</u> | NO _____ |
| Registered business name confirmed: | YES <u>X</u> | NO _____ |
| Good standing confirmed: | YES <u>X</u> | NO _____ |

BLNR – ISSUANCE OF A REVOCABLE PERMIT FOR USE OF A T-HANGAR
FOR STORAGE AND MAINTENANCE OF A PERSONAL AIRCRAFT
THE AFFORDABLE CASKET OUTLET, L.L.C.

Page 3

CHAPTER 343, HRS - ENVIRONMENTAL ASSESSMENT:

The subject land area is covered by the Final Environmental Assessment for the Kalaeloa Airfield Development Plan Improvements, State Project No. AO5011-02 dated June 2010. This Environmental Assessment was prepared by Wilson Okamoto Corp. for the State of Hawaii, Department of Transportation, in part to evaluate the environmental effects of the recommended Kalaeloa Airfield Master Plan to meet existing and forecast general aviation demands.

REMARKS:

In accordance with Section 171-55 HRS, relating to Permits, the Department of Transportation proposes to issue a month-to-month revocable permit to The Affordable Casket Outlet, L.L.C., situated at Kalaeloa Airport for use of a T-Hangar for storage and maintenance of a personal aircraft.

RECOMMENDATION:

Based on this submittal, and testimony and facts presented, the Department of Transportation recommends the Board finds that approving the issuance of a month-to-month revocable permit to The Affordable Casket Outlet, L.L.C., including its conditions and rent, will serve the best interests of the State.

Respectfully submitted,



EDWIN H. SNIFFEN
Director of Transportation

APPROVED FOR SUBMITTAL:



DAWN N. S. CHANG
Chairperson
Board of Land and Natural Resources

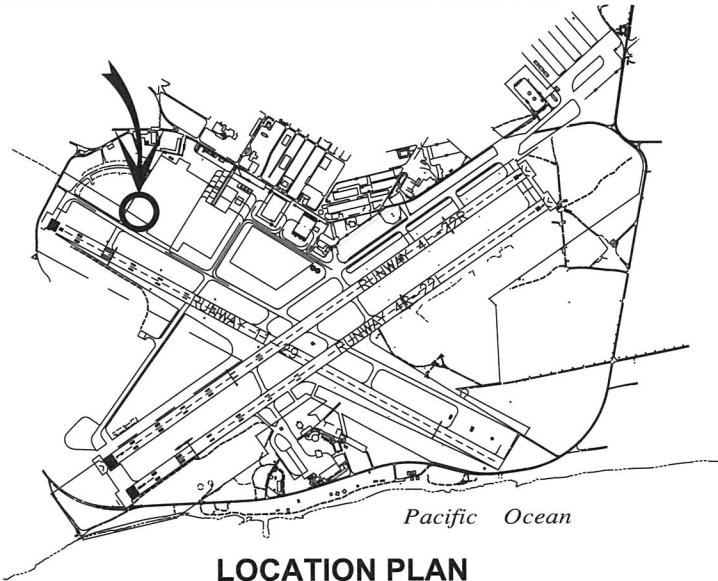

LOCATION PLAN

3000:1

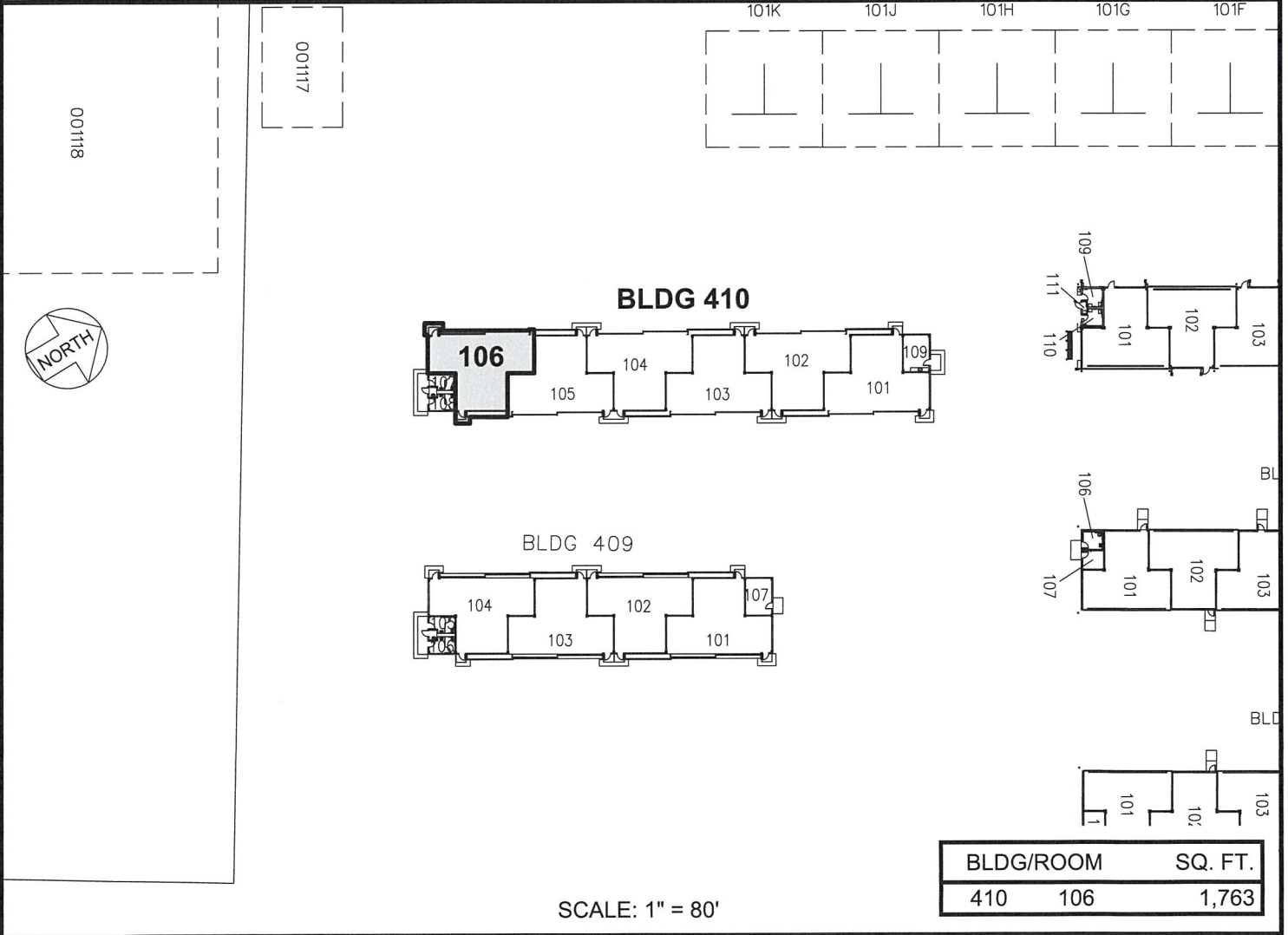

SCALE: 1" = 80'

| BLDG/ROOM | SQ. FT. |
|-----------|---------|
| 410 106 | 1,763 |

RP-9461

DATE : JULY 2023

EXHIBIT: **A**



AIRPORTS

THE AFFORDABLE CASKET
OUTLET, L.L.C.

T-HANGAR

410106

KALAELOA AIRPORT

N:\AIRPORTS\RP_9461\CAD\DWG_410106-01.DWG