

JOSH GREEN, M.D.
GOVERNOR



STATE OF HAWAII
DEPARTMENT OF TRANSPORTATION
869 PUNCHBOWL STREET
HONOLULU, HAWAII 96813-5097

EDWIN H. SNIFFEN
DIRECTOR

Deputy Directors
FORD N. FUCHIGAMI
DREANALEE K. KALILI
TAMMY L. LEE
ROBIN K. SHISHIDO

IN REPLY REFER TO:

Board of Land and
Natural Resources
State of Hawaii
Honolulu, Hawaii

ISSUANCE OF A REVOCABLE PERMIT FOR TERMINAL
OFFICE SPACE TO SUPPORT FIXED-BASE OPERATIONS
SIGNATURE FLIGHT SUPPORT LLC
HILO INTERNATIONAL AIRPORT
TAX MAP KEY: (3) 2-1-12: PORTION OF 009

HAWAII

LEGAL REFERENCE:

Section 171-55, Hawaii Revised Statutes (HRS), as amended.

APPLICANT:

Signature Flight Support LLC (SFS), whose mailing address is 98 Kapalulu Place,
Honolulu, Hawaii 96819.

LOCATION AND TAX MAP KEY:

Portion of Hilo International Airport (ITO), Hilo, Island of Hawaii, identified by
Tax Map Key: 3rd Division, 2-1-12: Portion of 009.

AREA:

Area/Space No. 307-232B, containing an area of approximately 520 square feet, as
shown and delineated on the attached Exhibit A.

ZONING:

State Land Use District: Urban
County of Hawaii: Industrial (ML-20)

ITEM M-5

LAND TITLE STATUS:

Section 5(a) lands of the Hawaii Admission Act: Ceded
DHHL 30% entitlement lands pursuant to the Hawaii Admission Act: YES ___ NO X

CURRENT USE STATUS:

Land presently encumbered by Governor's Executive Order No. 1519, dated July 17, 1952, setting aside 550.881 acres, being a portion of General Lyman Field under the control and management of the Hawaii Aeronautics Commission (subsequently transferred to the Department of Transportation) as a site for the Hilo Airport, now known as Hilo International Airport.

CHARACTER OF USE:

SFS will use the space as an office to support its fixed-base operation (FBO) at ITO.

COMMENCEMENT DATE:

To be determined by the Director of Transportation at a later date.

MONTHLY RENTAL:

\$1,008.80 (\$676.00 based on a rate of \$15.60 per square foot, per annum, as determined from the State of Hawaii, Department of Transportation (HDOT) schedule of rates and charges established by appraisal of Airports property statewide, plus \$202.80 for utilities and \$130.00 for maintenance.)

SECURITY DEPOSIT:

\$3,026.40, or three times the monthly rental in effect.

DCCA VERIFICATION:

Place of business registration confirmed: YES X NO _____
Registered business name confirmed: YES X NO _____
Good standing confirmed: YES X NO _____

CHAPTER 343, HRS - ENVIRONMENTAL ASSESSMENT:

The HDOT, has determined that the environmental impacts of the subject land area and use is covered by the General Lyman Field, New Passenger Terminal, Final Environmental Impact Statement (FEIS), published by the Office of Environmental Quality Control (OEQC) in the October 17, 1973, issue of EIS Newsletter. Accordingly,

BLNR – ISSUANCE OF A REVOCABLE PERMIT FOR TERMINAL OFFICE SPACE TO
SUPPORT FIXED-BASE OPERATIONS, SIGNATURE FLIGHT SUPPORT LLC

Page 3

all relevant mitigation from the FEIS and best management practices will be implemented to address the minimum impacts of this action.

REMARKS:

In accordance with Section 171-55, HRS, relating to Permits, the HDOT proposes to issue a month-to-month Revocable Permit to SFS for Terminal office space to support its FBO at ITO.

RECOMMENDATION:

Based on this submittal, and testimony and facts presented, the HDOT recommends the Board finds that approving the issuance of a month-to-month Revocable Permit to SFS, including its conditions and rent, will serve the best interests of the State.

Respectfully submitted,



EDWIN H. SNIFFEN
Director of Transportation

APPROVED FOR SUBMITTAL:



DAWN N. S. CHANG
Chairperson
Board of Land and Natural Resources

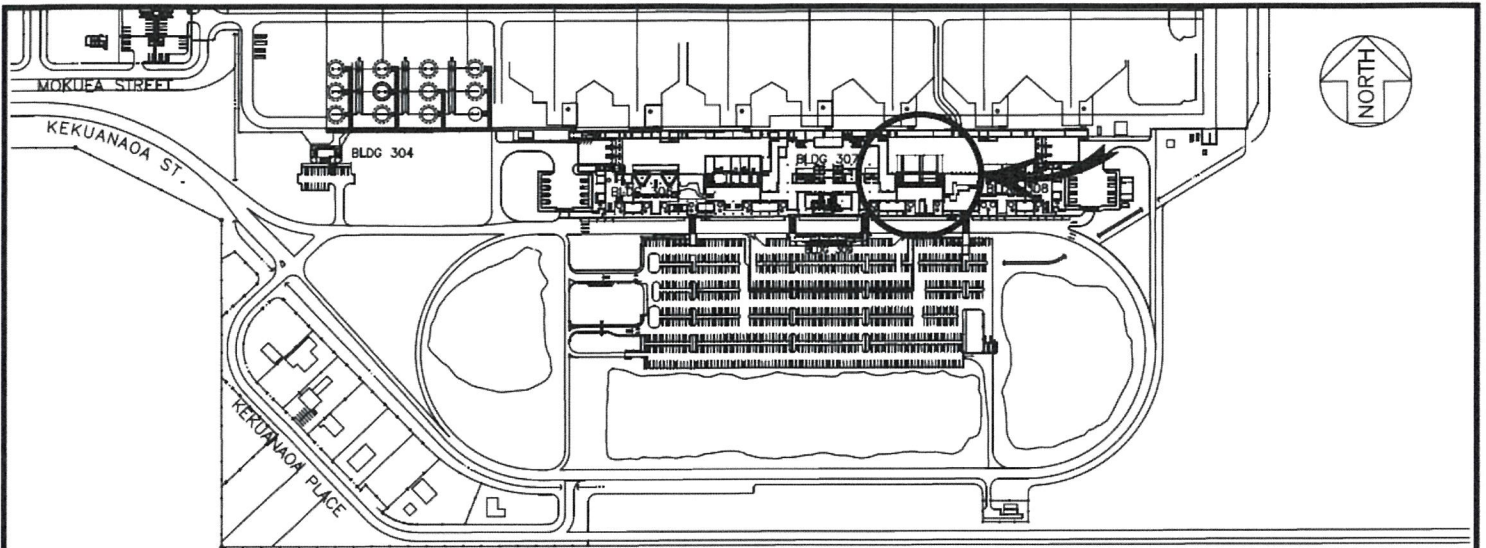

LOCATION PLAN

500:1

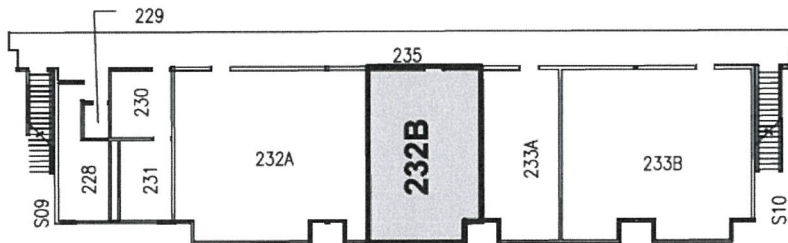

CHECK-IN/ TICKETING

**BLDG 307
(B-7)**

SCALE: 1" = 30'

BLDG/ROOM	SQ. FT.
307 232B	520

RP-9475

DATE : JANUARY 2023

EXHIBIT: **A**



Airports

SIGNATURE FLIGHT
SUPPORT LLC

BUILDING 307
CHECK-IN/TICKETING
SECOND LEVEL

307232B
PLAT C2,42

HILO INTERNATIONAL AIRPORT

N:\AIRPORTS\HILO\CAD\PM\ITO_307232B-01.DWG