



**STATE OF HAWAII**  
**DEPARTMENT OF TRANSPORTATION**  
869 PUNCHBOWL STREET  
HONOLULU, HAWAII 96813-5097

Board of Land and  
Natural Resources  
State of Hawaii  
Honolulu, Hawaii

ISSUANCE OF A REVOCABLE PERMIT FOR  
PARKING AND STORAGE OF RENTAL CAR VEHICLES  
EAN HOLDINGS, LLC  
HILO INTERNATIONAL AIRPORT  
TAX MAP KEY: (3) 2-1-12: PORTION OF 009

HAWAII

LEGAL REFERENCE:

Section 171-55, Hawaii Revised Statutes (HRS), as amended.

APPLICANT:

EAN Holdings, LLC, whose business address is 820 Mililani Street, Suite 800,  
Honolulu, Hawaii 96819.

LOCATION AND TAX MAP KEY:

Portion of Hilo International Airport (ITO), Hilo, Island of Hawaii, identified by  
Tax Map Key: 3<sup>rd</sup> Division, 2-1-12: Portion of 009.

AREAS:

IMPROVED, UNPAVED LAND

Area/Space Nos. 800-119G, containing an area of approximately 15,000 square feet, and  
Area/Space 800-119H, containing an area of approximately 5,000 square feet, as  
shown and delineated on the attached Exhibit A.

ZONING:

State Land Use District: Urban  
County of Hawaii: Industrial (ML-20)

**ITEM M-6**

BLNR – ISSUANCE OF A REVOCABLE PERMIT FOR PARKING AND STORAGE OF RENTAL CAR VEHICLES, EAN HOLDINGS, LLC

Page 2

LAND TITLE STATUS:

Section 5(a) lands of the Hawaii Admissions Act: Ceded  
DHHL 30% entitlement lands pursuant to the Hawaii State Constitution: No

CURRENT USE STATUS:

Land presently encumbered by Governor’s Executive Order No. 1519, dated July 17, 1952, setting aside 550.881 acres, being a portion of General Lyman Field under the control and management of the Hawaii Aeronautics Commission (subsequently transferred to the Department of Transportation) as a site for the Hilo Airport, now known as Hilo International Airport.

CHARACTER OF USE:

EAN Holdings, LLC will use the space for parking and storage of rental car vehicles.

COMMENCEMENT DATE:

Upon execution of the document.

MONTHLY RENTAL:

\$ 1,566.67 (based on a rate of \$0.94 per square foot per annum for unimproved, unpaved land, as determined from the State of Hawaii, Department of Transportation (HDOT) schedule of rates and charges by appraisal of Airports property statewide).

SECURITY DEPOSIT:

\$ 4,700.01, or three times the monthly rental in effect.

DCCA VERIFICATION:

Place of business registration confirmed:	YES <u>X</u>	NO <u>    </u>
Registered business name confirmed:	YES <u>X</u>	NO <u>    </u>
Good standing confirmed:	YES <u>X</u>	NO <u>    </u>

CHAPTER 343, HRS – ENVIRONMENTAL ASSESSMENT:

This action is de minimis and is exempt from the preparation of an exemption notice in accordance with HAR, Section 11-200.1-16(b) and the HDOT, Comprehensive Exemption List, concurred to by the Environmental Advisory Council on

BLNR – ISSUANCE OF A REVOCABLE PERMIT FOR PARKING AND STORAGE OF RENTAL CAR VEHICLES, EAN HOLDINGS, LLC

Page 3

February 1, 2022, Exemption Type 8, Part 1 (8)g: Creation or extensions of leases, revocable permits or easements involving negligible or minor expansion of change of use beyond that previously existing.

REMARKS:

In accordance with Section 171-55, HRS, relating to Permits, HDOT proposes to issue a month-to-month revocable permit to EAN Holdings, LLC for parking and storage of rental car vehicles at ITO.

RECOMMENDATION:

That the Board authorize HDOT to issue a month-to-month revocable permit to EAN Holdings, LLC, subject to: (1) terms and conditions herein outlined, which are by reference incorporated herein; and (2) such additional terms and conditions as may be prescribed by the Director of Transportation to best serve the interests of the State.

Respectfully submitted,



EDWIN H. SNIFFEN  
Director of Transportation

APPROVED FOR SUBMITTAL:



DAWN N. S. CHANG  
Chairperson  
Board of Land and Natural Resources

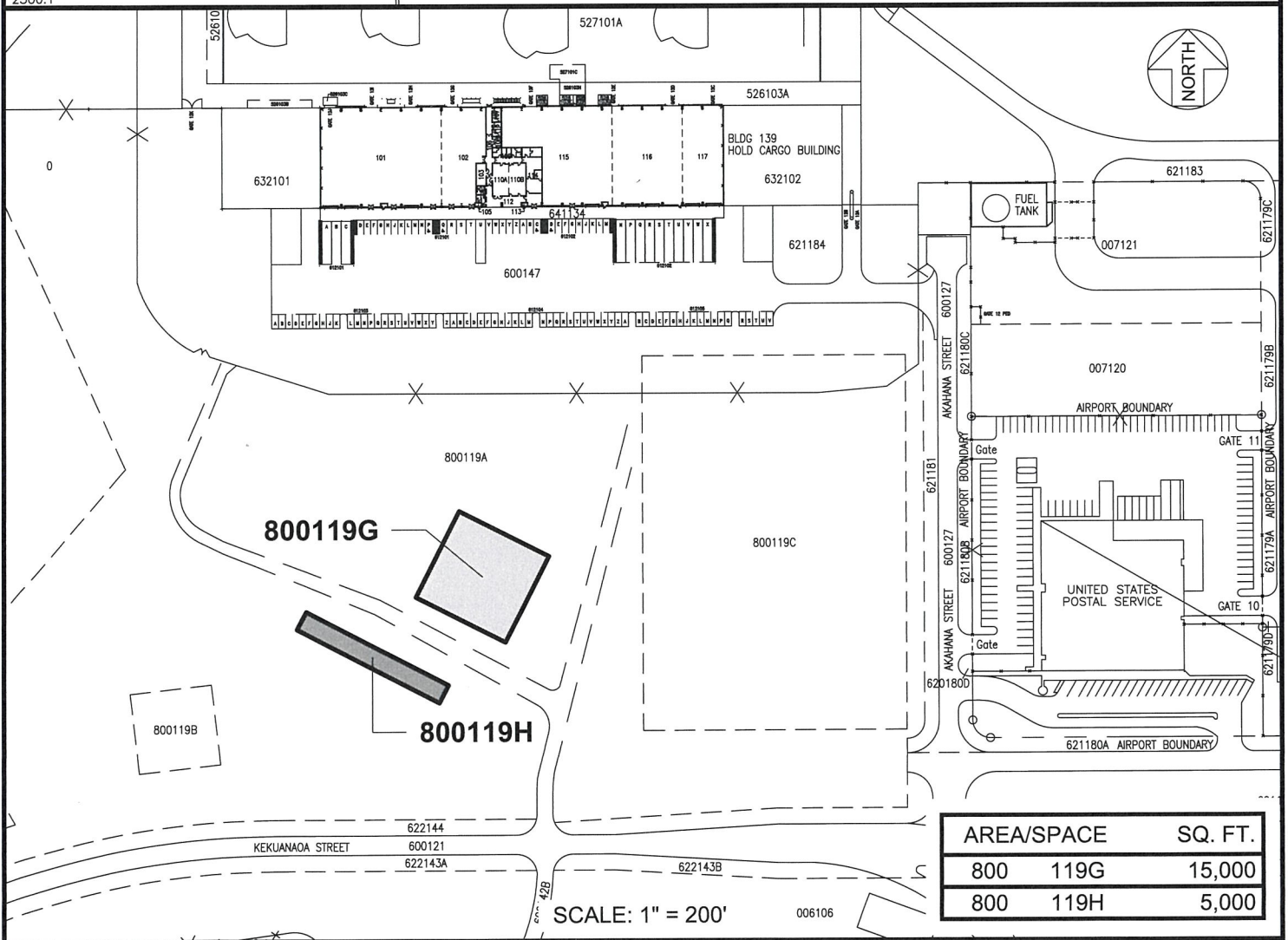
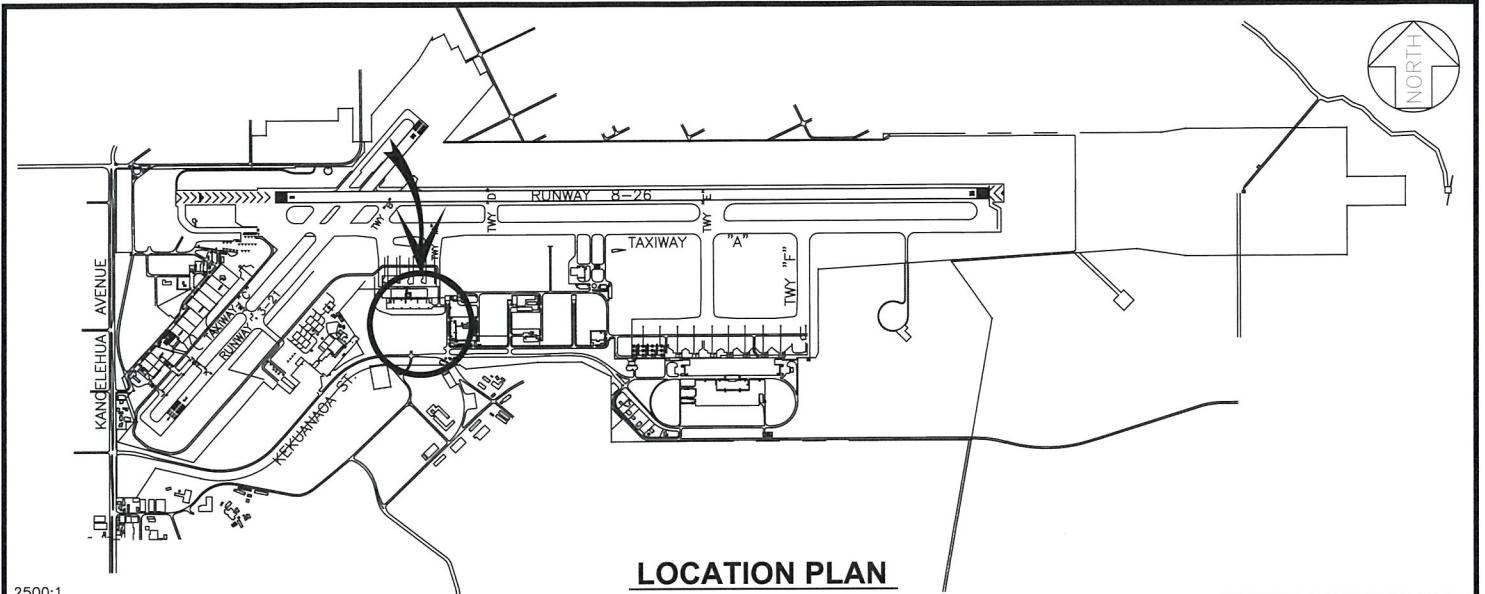

RP-9477	DATE : JULY 2023	EXHIBIT: <b>A</b>
	EAN HOLDINGS, LLC	LOT
		800119G 800119H

**HILO INTERNATIONAL AIRPORT**

N:\AIRPORTS\ITO\_HILO\CAD\PM\ITO\_800119G-02.DWG