



**STATE OF HAWAII  
DEPARTMENT OF TRANSPORTATION  
869 PUNCHBOWL STREET  
HONOLULU, HAWAII 96813-5097**

Board of Land and  
Natural Resources  
State of Hawaii  
Honolulu, Hawaii

ISSUANCE OF REVOCABLE PERMIT FOR LAND FOR TRAILER AND PARKING  
ALCLEAR, LLC DBA CLEAR  
KAHULUI AIRPORT  
TAX MAP KEY: (2) 3-8-001: 019 (PORTION) MAUI

APPLICANT/LESSEE:

ALCLEAR, LLC DBA CLEAR (CLEAR), whose mailing address is 85 Tenth Avenue,  
9th Floor, New York, New York 10011.

LEGAL REFERENCE:

Section 171-55, Hawaii Revised Statutes (HRS), as amended.

LOCATION AND TAX MAP KEY:

Portions of Kahului Airport (Airport), Kahului, Island of Maui, State of Hawaii,  
identified by Tax Map Key: 2<sup>nd</sup> Division, 3-8-001: 019 (Portion).

AREA:

Area/Space No. 630-119, consisting of an area of approximately 1,008 square feet;  
Area/Space No. 610-111L, consisting of an area of approximately 162 square feet;  
Area/Space No. 610-111M, consisting of an area of approximately 162 square feet; and  
Area/Space No. 610-111N, consisting of an area of approximately 162 square feet,  
as shown on the attached map labeled Exhibit "A".

ZONING:

State Land Use District:	Urban
County of Maui	Airport

**ITEM M-8**

BLNR – ISSUANCE OF A REVOCABLE PERMIT FOR LAND FOR TRAILER AND PARKING, ALCLEAR, LLC DBA CLEAR

Page 2

LAND TITLE STATUS:

Section 5(a) lands of the Hawaii Admissions Act: Non-ceded  
DHHL 30% entitlement lands pursuant to the Hawaii State Constitution: YES \_\_\_ NO X

CURRENT USE STATUS:

Land presently encumbered by Governor’s Executive Order No. 2427, dated February 12, 1969, setting aside 1,268.938 acres designated as the Airport under the control and management of the State of Hawaii, Department of Transportation (HDOT) for Airport purposes.

CHARACTER OF USE:

Land for trailer space and parking to support CLEAR’s Registered Traveler Program at the Airport.

COMMENCEMENT DATE:

Upon complete execution of the revocable permit.

MONTHLY RENTAL:

\$568.97 (land rate of \$4.57 per square foot, per annum, as determined from the HDOT schedule of rates and charges established by appraisal of Airport property statewide).

SECURITY DEPOSIT:

\$1,706.91, or three times the monthly rent in effect.

DCCA VERIFICATION:

Place of business registration confirmed: YES X NO \_\_\_  
Registered business name confirmed: YES X NO \_\_\_  
Good standing confirmed: YES X NO \_\_\_

CHAPTER 343, HRS - ENVIRONMENTAL ASSESSMENT:

HDOT has determined that the subject land area and use is covered by the Kahului Airport Terminal Complex Expansion Negative Declaration, published by the Environmental Quality Commission (EQC) in the September 8, 1981, issue of the EQC Bulletin. Accordingly, all relevant mitigation from the Negative Declaration and best management practices will be implemented to address the minimum impacts of this action.

BLNR – ISSUANCE OF A REVOCABLE PERMIT FOR LAND FOR TRAILER AND  
PARKING, ALCLEAR, LLC DBA CLEAR

Page 3

REMARKS:

In accordance with Section 171-55, HRS, relating to Permits, HDOT proposes to issue a month-to-month revocable permit to CLEAR for trailer and parking space to support CLEAR's Registered Traveler Program at the Airport.

RECOMMENDATION:

Based on this submittal, and testimony and facts presented, HDOT recommends the Board finds that approving the issuance of a month-to-month Revocable Permit to CLEAR, including its conditions and rent, will serve the best interests of the State.

Respectfully submitted,



EDWIN H. SNIFFEN  
Director of Transportation

APPROVED FOR SUBMITTAL:



DAWN N. S. CHANG  
Chairperson  
Board of Land and Natural Resources

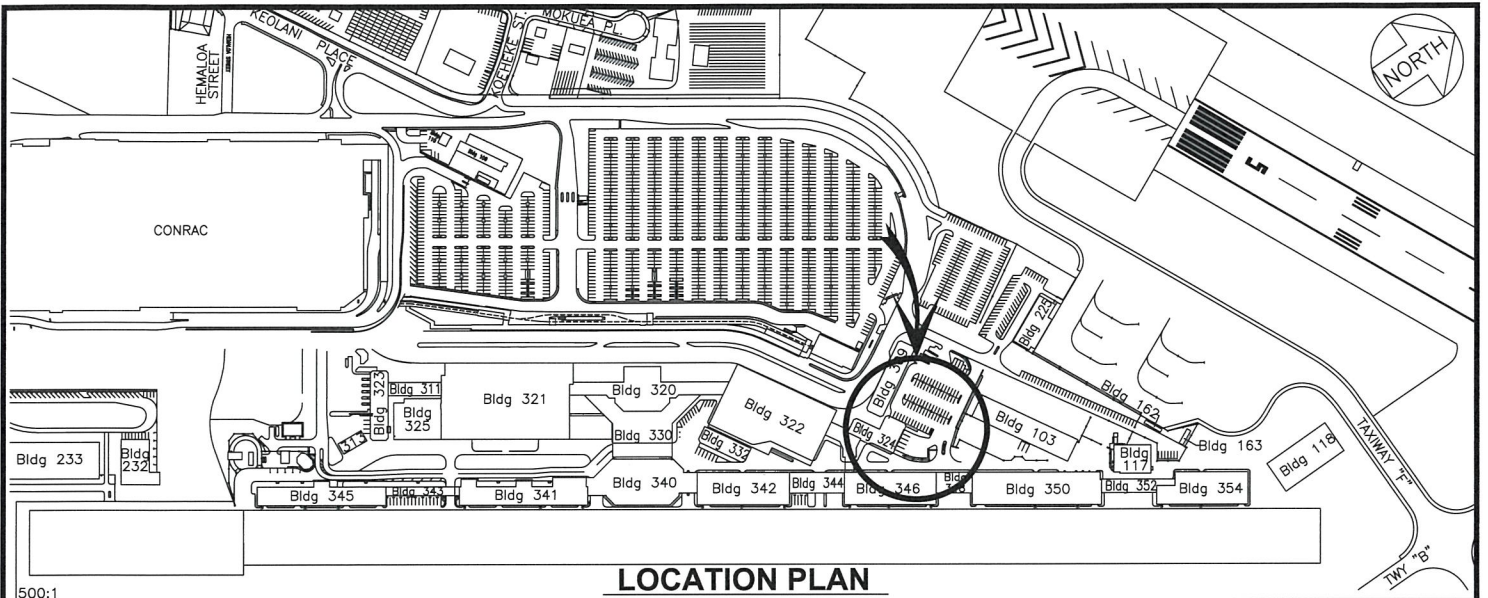

**LOCATION PLAN**

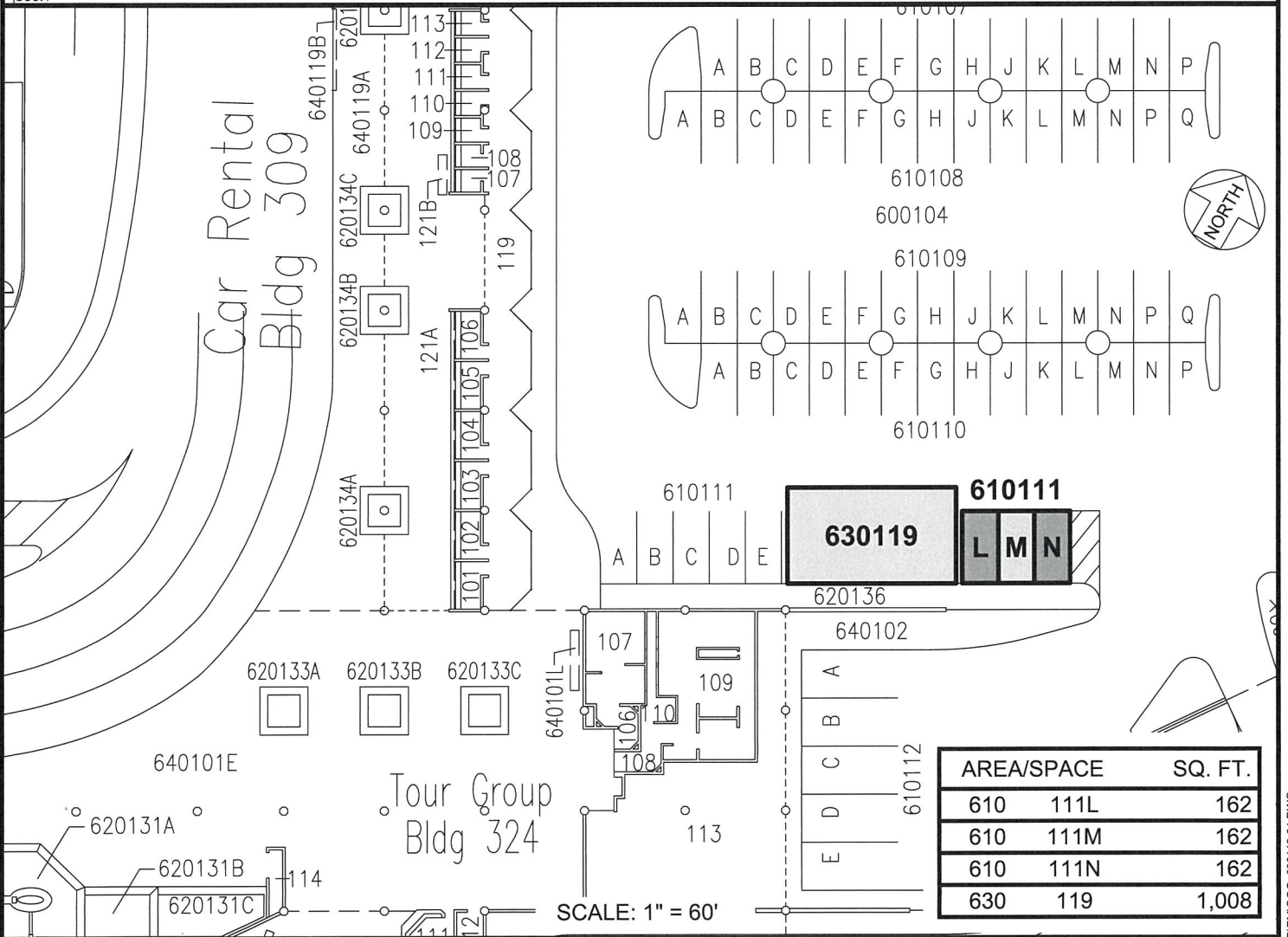

AREA/SPACE	SQ. FT.
610 111L	162
610 111M	162
610 111N	162
630 119	1,008

SCALE: 1" = 60'

DATE : AUGUST 2023

EXHIBIT: **A**

DEPARTMENT OF TRANSPORTATION  
STATE OF HAWAII  
AIRPORTS

ALCLEAR, LLC DBA CLEAR

TRAILER AND PARKING

610111L-N  
630119

**KAHULUI AIRPORT**

N:\AIRPORTS\OGG\_KAHULUI\CAD\PM\OGG\_630119-01.DWG