



STATE OF HAWAII
DEPARTMENT OF TRANSPORTATION
869 PUNCHBOWL STREET
HONOLULU, HAWAII 96813-5097

EDWIN H. SNIFFEN
DIRECTOR

Deputy Directors
FORD N. FUCHIGAMI
DREANALEE K. KALILI
TAMMY L. LEE
ROBIN K. SHISHIDO

IN REPLY REFER TO:

Board of Land and
Natural Resources
State of Hawaii
Honolulu, Hawaii

ISSUANCE OF A REVOCABLE PERMIT FOR VEHICLE PARKING
FOR CARGO OPERATIONS
FEDERAL EXPRESS CORPORATION
ELLISON ONIZUKA KONA INTERNATIONAL AIRPORT AT KEAHOLE
TAX MAP KEY: (3) 7-3-43: PORTION OF 003

HAWAII

LEGAL REFERENCE:

Section 171-55, Hawaii Revised Statutes (HRS), as amended.

APPLICANT:

Federal Express Corporation (FedEx), whose business address is 73-220 Uu Street,
Kailua-Kona, Hawaii 96740.

LOCATION AND TAX MAP KEY:

Portion of Ellison Onizuka Kona International Airport at Keahole (KOA), Kailua-Kona,
Island of Hawaii, identified by Tax Map Key: 3rd Division, 7-3-43: Portion of 003.

AREA:

Area/Space No. 610-154C, containing an area of approximately 513 square feet of
uncovered, paved parking, as shown and delineated on the attached Exhibit A.

ZONING:

State Land Use District:
County of Hawaii:

Urban & Conservation
Industrial (MG-1a) and Open

ITEM M-9

BLNR – ISSUANCE OF A REVOCABLE PERMIT FOR VEHICLE PARKING
FOR CARGO OPERATIONS, FEDERAL EXPRESS CORPORATION

Page 2

LAND TITLE STATUS:

Section 5(a) lands of the Hawaii Admission Act: Ceded
DHHL 30% entitlement lands pursuant to Hawaii Admission Act YES ___ NO X

CURRENT USE STATUS:

Land presently encumbered by Governor's Executive Order No. 3074, dated August 20, 1981, setting aside 4,204.10 acres designated as KOA under the control and management of the State of Hawaii, Department of Transportation (HDOT) for Airport Purposes.

CHARACTER OF USE:

FedEx will use the three vehicle parking spaces to support its cargo operations at KOA.

COMMENCEMENT DATE:

Upon execution of the revocable permit.

MONTHLY RENTAL:

\$165.00 (\$55.00 per stall as determined from the HDOT schedule of rates and charges established by appraisal of Airports property statewide).

SECURITY DEPOSIT:

\$495.00, or three times the monthly rental in effect.

DCCA VERIFICATION:

Place of business registration confirmed:	YES <u>X</u>	NO ___
Registered business name confirmed:	YES <u>X</u>	NO ___
Good standing confirmed:	YES <u>X</u>	NO ___

CHAPTER 343, HRS - ENVIRONMENTAL ASSESSMENT:

The HDOT, has determined that the subject land area and use is covered by the Keahole Airport General Aviation and Maintenance Baseyard Facilities Negative Declaration, published by the Environmental Quality Commission (EQC) in the December 23, 1980, issue of the EQC Bulletin. Accordingly, all relevant mitigation from the Negative Declaration and best management practices will be implemented to address the minimum impacts of this action.

BLNR – ISSUANCE OF A REVOCABLE PERMIT FOR VEHICLE PARKING
FOR CARGO OPERATIONS, FEDERAL EXPRESS CORPORATION

Page 3

REMARKS:

In accordance with Section 171-55, HRS, relating to Permits, HDOT proposes to issue a month-to-month Revocable Permit to FedEx for three vehicle parking spaces as part of its cargo operations at KOA.

RECOMMENDATION:

Based on this submittal, and testimony and facts presented, the HDOT recommends the Board finds that approving the issuance of a month-to-month Revocable Permit to FedEx, including its conditions and rent, will serve the best interests of the State.

Respectfully submitted,



EDWIN H. SNIFFEN
Director of Transportation

APPROVED FOR SUBMITTAL:



DAWN N. S. CHANG
Chairperson
Board of Land and Natural Resources

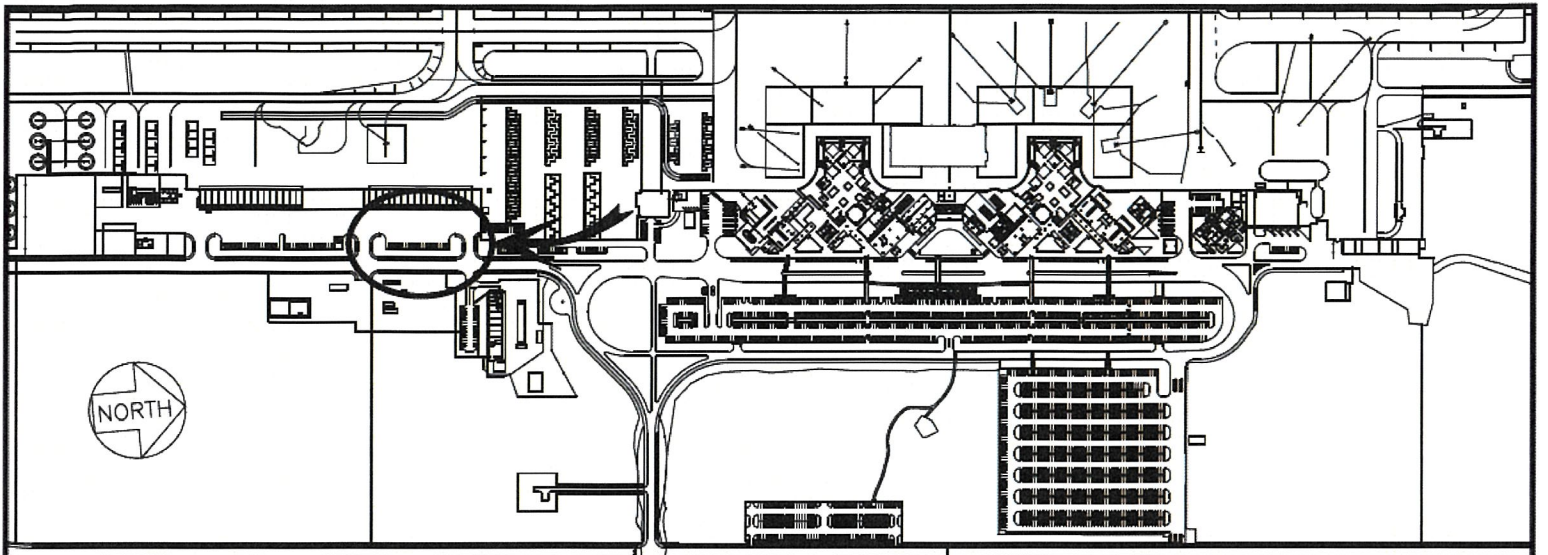

LOCATION PLAN

600:1

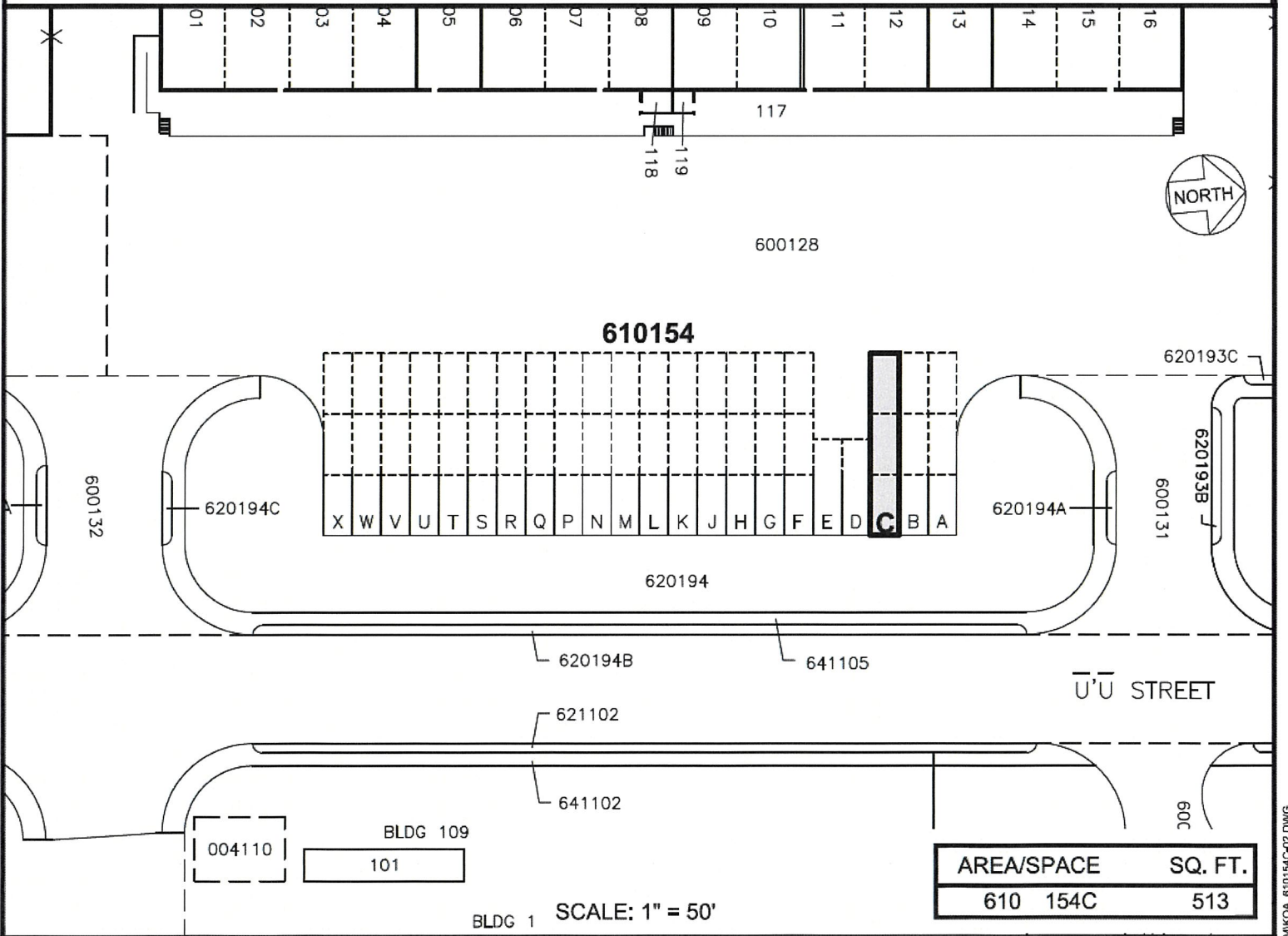

610154

600128

620193C

600132

620194C

X W V U T S R Q P N M L K J H G F E D **C** B A

620194A

620193B
600131

620194

620194B

641105

U'U STREET

621102

641102

60C

004110

BLDG 109
101

BLDG 1 SCALE: 1" = 50'

AREA/SPACE	SQ. FT.
610 154C	513

DATE : SEPTEMBER 2022

EXHIBIT: **A**



Airports

FEDERAL EXPRESS CORPORATION

PARKING STALLS

610154C
PLAT C1,39

ELLISON ONIZUKA KONA INTERNATIONAL AIRPORT AT KEAHOLE

M:\AIRPORTS\KOA_KONA\CAD\PM\KOA_610154C-02.DWG