



STATE OF HAWAII
DEPARTMENT OF TRANSPORTATION
869 PUNCHBOWL STREET
HONOLULU, HAWAII 96813-5097

Deputy Directors
FORD N. FUCHIGAMI
DREANALEE K. KALILI
TAMMY L. LEE
ROBIN K. SHISHIDO

IN REPLY REFER TO:

Board of Land and
Natural Resources
State of Hawaii
Honolulu, Hawaii

ISSUANCE OF A REVOCABLE PERMIT FOR VEHICLE PARKING AND
CONSTRUCTION LAYDOWN AREAS IN THE MAUKA CONCOURSE
AS PART OF ITS SIGNATORY AIRLINE OPERATIONS
HAWAIIAN AIRLINES, INC
DANIEL K. INOUE INTERNATIONAL AIRPORT
TAX MAP KEY: (1) 1-1-003: 073 (PORTION)

OAHU

APPLICANT:

Hawaiian Airlines, Inc. (Hawaiian Airlines), whose business address is 3375 Koapaka Street, Suite G350, Honolulu, Hawaii 96819.

LEGAL REFERENCE:

Section 171-55, Hawaii Revised Statutes, as amended.

LOCATION AND TAX MAP KEY:

Parking spaces in Mauka Concourse, Ground Level at Daniel K. Inouye International Airport (Airport), Island of Oahu, State of Hawaii, identified by Tax Map Key: 1st Division, 1-1-003: 073 (Portion).

AREA:

Area/Space No. 617-103 through 617-106, containing an area of 300 square feet each;
Area/Space No. 617-122 through 617-124, containing an area of 480 square feet each;
Area/Space No. 617-125 and 617-126, each containing an area of 332 square feet,
as shown and delineated on the attached map labeled Exhibit "A".

ZONING:

State Land Use District: Urban
City and County of Honolulu LUO: Industrial (I-2)

ITEM M-2

BLNR – ISSUANCE OF A REVOCABLE PERMIT FOR VEHICLE PARKING AND CONSTRUCTION LAYDOWN AREAS IN THE MAUKA CONCOURSE AS PART OF ITS SIGNATORY AIRLINE OPERATIONS, HAWAIIAN AIRLINES, INC.

Page 2

LAND TITLE STATUS:

Non-Ceded - Section 5(a) lands of the Hawaii Admission Act
DHHL 30% entitlement lands pursuant to Hawaii Admission Act YES ___ NO X

CURRENT USE STATUS:

Land presently encumbered by Governor’s Executive Order No. 3201, dated June 8, 1983, setting aside 3,152.177 acres designated as the Airport under the control and management of the State of Hawaii, Department of Transportation (HDOT) for Airport Purposes.

CHARACTER OF USE:

Hawaiian Airlines will use the spaces for vehicle parking and construction laydown areas in the Mauka Concourse as part of their signatory airline operations at the Airport.

COMMENCEMENT DATE:

Upon execution of the revocable permit.

MONTHLY RENTAL:

\$20,587.03, as determined from the Airports Division Signatory Rates and Charges, Hawaii Airports System.

SECURITY DEPOSIT:

\$61,761.09, or three (3) times the monthly rental in effect.

DCCA VERIFICATION:

Place of business registration confirmed: YES X NO ___
Registered business name confirmed: YES X NO ___
Good standing confirmed: YES X NO ___

CHAPTER 343, HRS - ENVIRONMENTAL ASSESSMENT:

The environmental impacts of the proposed action to the subject land area are covered by the Honolulu International Airport Master Plan Update and Noise Compatibility Program Environmental Assessment (EA), State Project No. AO1011-033. The EA is a joint State and Federal document, dated September 1989 and published in the October 23, 1989 issue of the OEQC Bulletin. Accordingly, relevant mitigation from the EA and HDOT environmental best management practice will address minimal impacts from this action.

BLNR – ISSUANCE OF A REVOCABLE PERMIT FOR VEHICLE PARKING AND CONSTRUCTION LAYDOWN AREAS IN THE MAUKA CONCOURSE AS PART OF ITS SIGNATORY AIRLINE OPERATIONS, HAWAIIAN AIRLINES, INC.

Page 3

REMARKS:

In accordance with Section 171-55 HRS, relating to Permits, HDOT proposes to issue a month-to-month revocable permit to Hawaiian Airlines, for vehicle parking and construction laydown areas in the Mauka Concourse as part of their signatory airline operations at the Airport. Hawaiian Airlines is a signatory airline carrier with airline operations located mainly within the Terminal 1.

RECOMMENDATION:

That the Board authorize HDOT to issue a month-to-month revocable permit to Hawaiian Airlines, subject to: (1) terms and conditions herein outlined, which are by reference incorporated herein; and (2) such additional terms and conditions as may be prescribed by the Director of Transportation to best serve the interests of the State.

Respectfully submitted,



EDWIN H. SNIFFEN
Director of Transportation

APPROVED FOR SUBMITTAL:



DAWN N. S. CHANG
Chairperson
Board of Land and Natural Resources

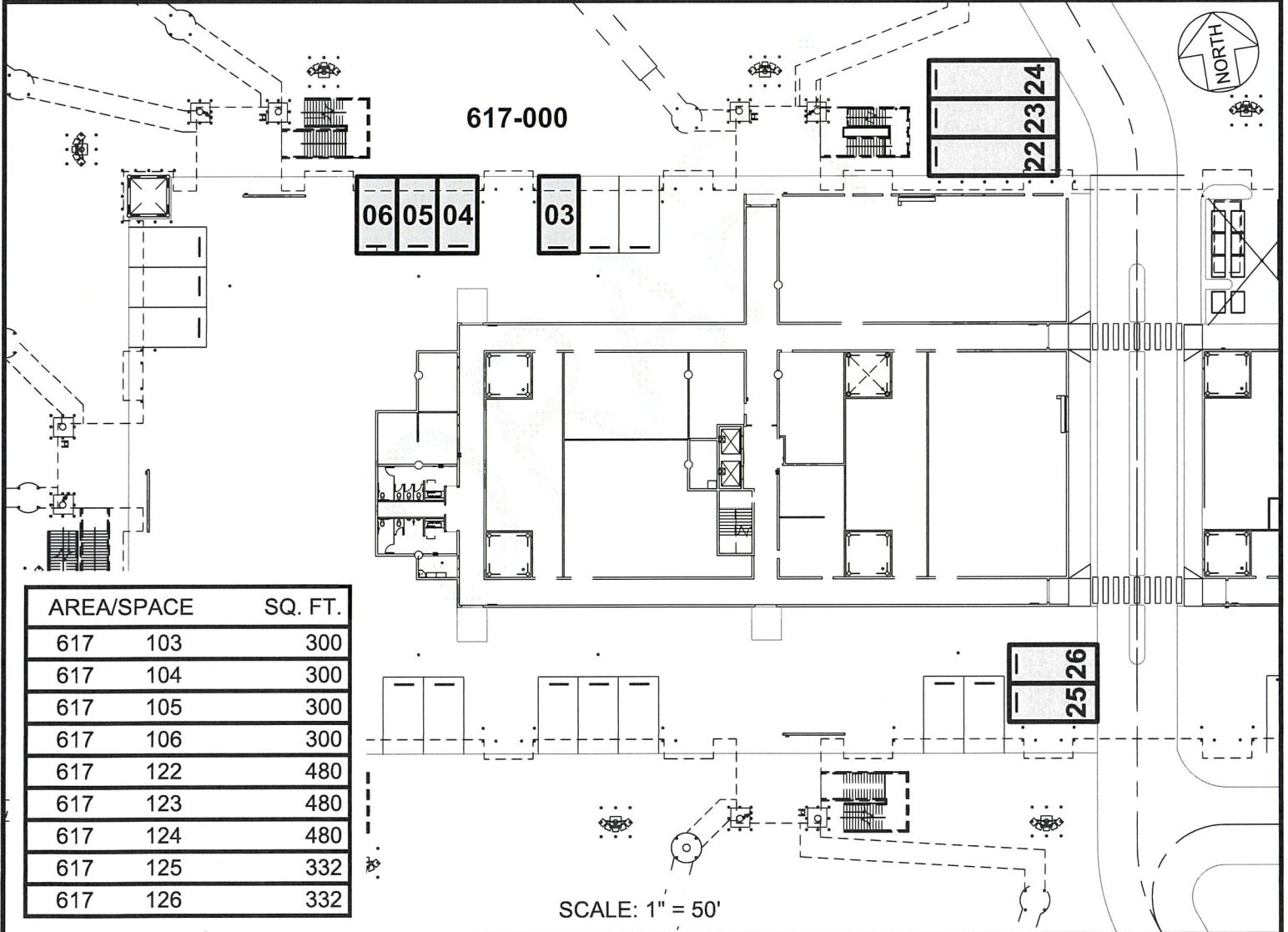
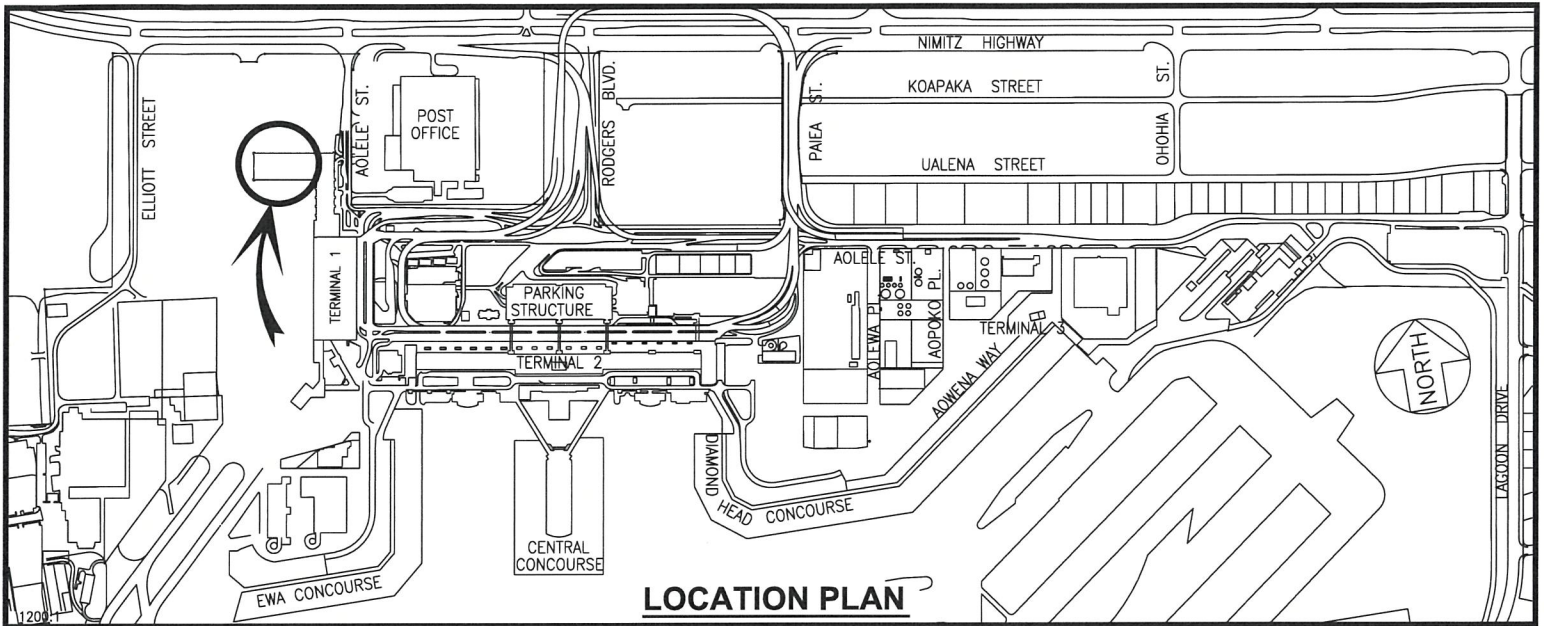

AREA/SPACE	SQ. FT.
617 103	300
617 104	300
617 105	300
617 106	300
617 122	480
617 123	480
617 124	480
617 125	332
617 126	332

RP-9483

DATE : AUGUST 2023

EXHIBIT: **A**



AIRPORTS

HAWAIIAN AIRLINES, INC.

**PARKING
MAUKA EXTENSION
GROUND LEVEL**

617103-106
617122-126