



STATE OF HAWAII
DEPARTMENT OF TRANSPORTATION
869 PUNCHBOWL STREET
HONOLULU, HAWAII 96813-5097

Board of Land and
Natural Resources
State of Hawaii
Honolulu, Hawaii

ISSUANCE OF A REVOCABLE PERMIT FOR RAMP SPACES
FOR GROUND SERVICE EQUIPMENT PARKING
AMERICAN AIRLINES, INC.
ELLISON ONIZUKA KONA INTERNATIONAL AIRPORT AT KEAHOLE
TAX MAP KEY: (3) 7-3-43: PORTION OF 003 HAWAII

LEGAL REFERENCE:

Section 171-55, Hawaii Revised Statutes (HRS), as amended.

APPLICANT:

American Airlines, Inc. (American), a Delaware corporation, whose mailing address is
1 Skyview Drive, MD8E100, Fort Worth, Texas 76155.

LOCATION AND TAX MAP KEY:

Portion of Ellison Onizuka Kona International Airport at Keahole (KOA), Kailua-Kona,
Island of Hawaii, identified by Tax Map Key: 3rd Division, 7-3-43: Portion of 003.

AREAS:

IMPROVED, PAVED LAND

Area/Space No. 617-103, containing an area of approximately 1,960 square feet as
shown and delineated on the attached Exhibit A;
Area/Space No. 617-122, containing an area of approximately 952 square feet as
shown and delineated on the attached Exhibit B; and
Area/Space No. 630-133A, containing an area of approximately 5,400 square feet as
shown and delineated on the attached Exhibit C.

ITEM M-20

BLNR – ISSUANCE OF A REVOCABLE PERMIT FOR RAMP SPACES FOR
GROUND SERVICE EQUIPMENT PARKING, AMERICAN AIRLINES, INC.
Page 2

ZONING:

State Land Use District: Urban & Conservation
County of Hawaii: Industrial (MG-1a) and Open

LAND TITLE STATUS:

Section 5(a) lands of the Hawaii Admission Act: Ceded
DHHL 30% entitlement lands pursuant to Hawaii Admission Act YES ___ NO X

CURRENT USE STATUS:

Land presently encumbered by Governor’s Executive Order No. 3074, dated August 20, 1981, setting aside 4,204.10 acres designated as KOA under the control and management of the State of Hawaii, Department of Transportation (HDOT), for Airport Purposes.

CHARACTER OF USE:

American will use the ramp spaces for ground service equipment parking as part of its signatory airline carrier operation at KOA.

COMMENCEMENT DATE:

To be determined by the Director of Transportation at a later date.

MONTHLY RENTAL:

\$2,375.84 (based on a rate of \$3.43 per square foot per annum, for improved, paved land as determined from the HDOT schedule of rates and charges established by appraisal of Airports property statewide).

SECURITY DEPOSIT:

\$7,127.52, or three times the monthly rental in effect.

DCCA VERIFICATION:

Place of business registration confirmed: YES X NO ___
Registered business name confirmed: YES X NO ___
Good standing confirmed: YES X NO ___

CHAPTER 343, HRS - ENVIRONMENTAL ASSESSMENT:

For Exhibits A & C, HDOT has determined the subject land area pertaining to this action was evaluated for environmental impact by the Keahole Airport Master Plan Final Environmental Impact Statement (EIS), published in The Environmental Notice on November 8, 1988, and accepted by the Governor on December 19, 1988. This action is consistent with the 1988 EIS and the same mitigation conditions apply.

For Exhibit B, HDOT has determined the subject land areas are covered by the Final Environmental Assessment (EA)/Finding of No Significant Impact (FONSI), Airfield, Terminal, and Facility Improvements for the Kona International Airport at Keahole, published by the Office of Environmental Quality Control (OEQC) in the March 23, 2013, issue of The Environmental Notice. Accordingly, all relevant mitigation from the EA and best management practices will be implemented to address the minimum impacts of this action.

REMARKS:

In accordance with Section 171-55, HRS, relating to Permits, the HDOT proposes to issue a month-to-month revocable permit to American for ramp spaces for ground service equipment parking as part of its signatory airline carrier operation at KOA.

RECOMMENDATION:

Based on this submittal, and testimony and facts presented, the HDOT recommends the Board finds that approving the issuance of a month-to-month revocable permit to American, including its conditions and rent, will serve the best interests of the State.

Respectfully submitted,



EDWIN H. SNIFFEN
Director of Transportation

APPROVED FOR SUBMITTAL:



DAWN N. S. CHANG
Chairperson
Board of Land and Natural Resources

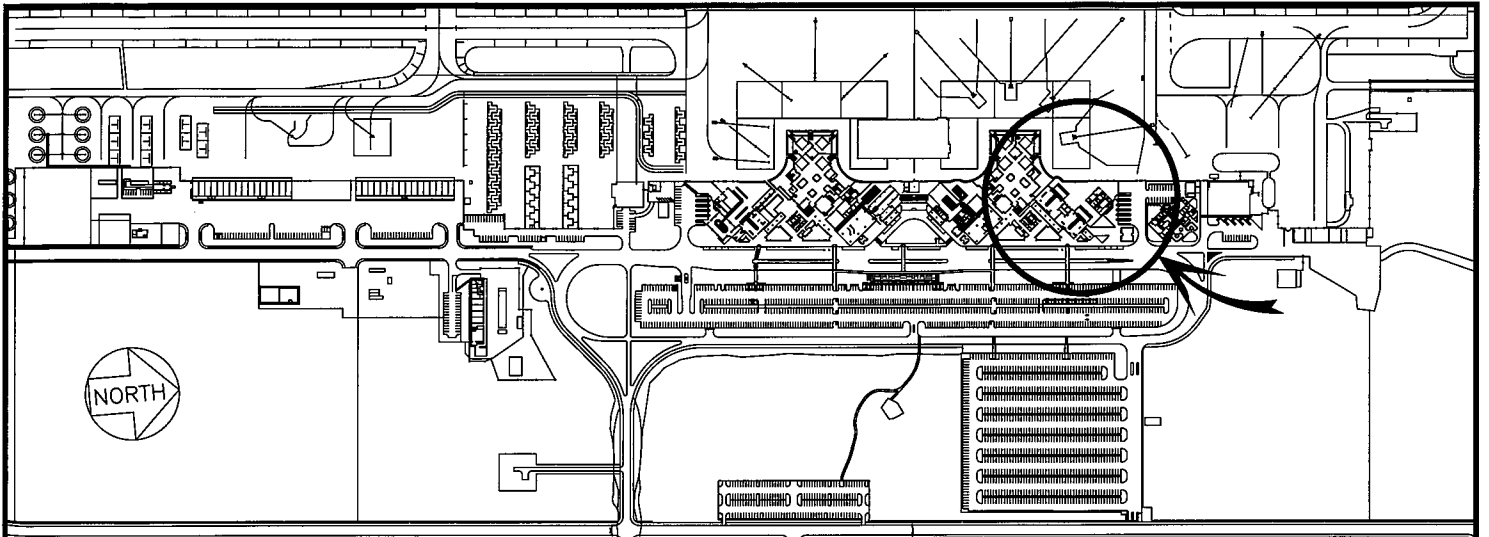

LOCATION PLAN

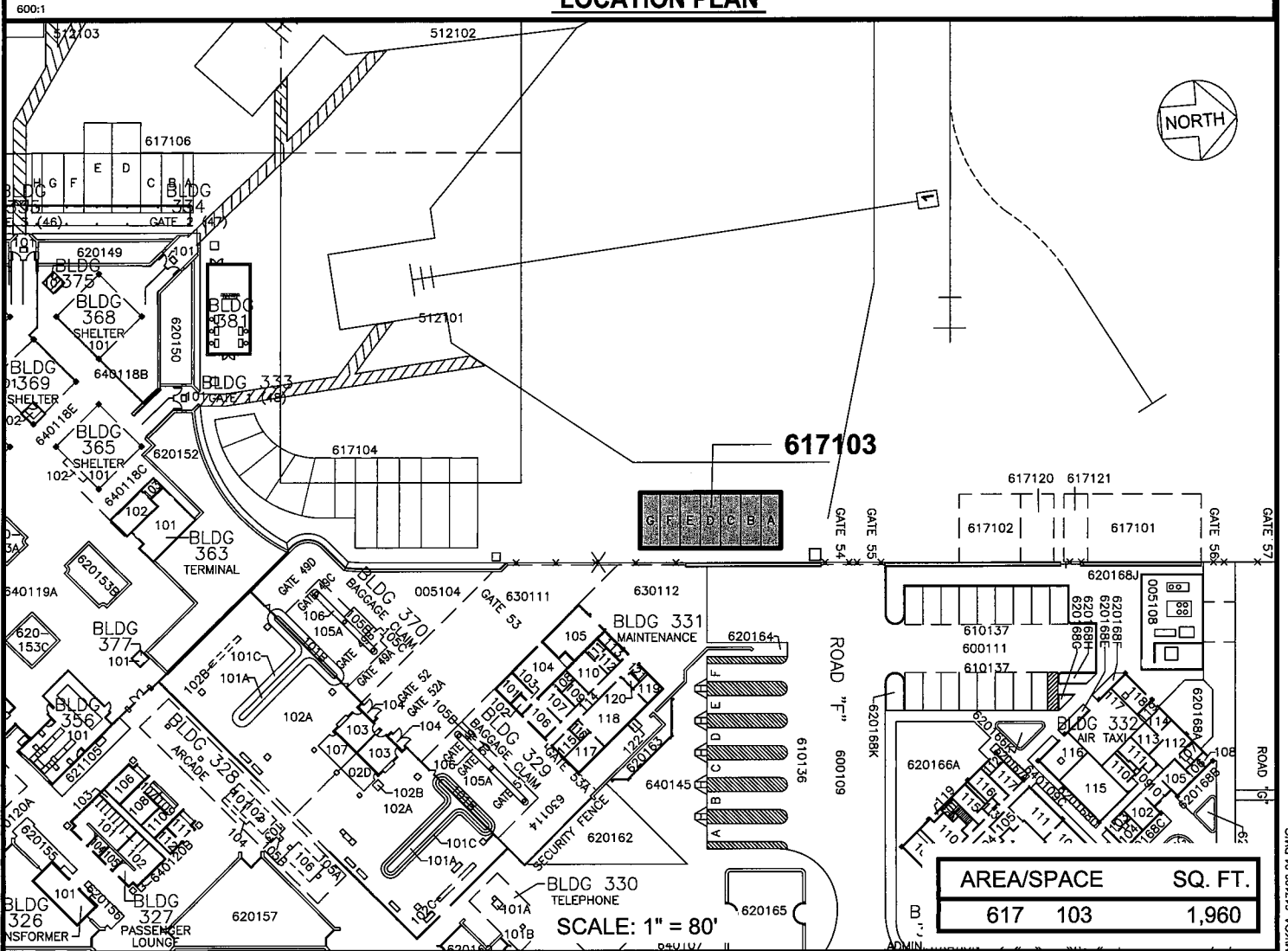

RP-9481

DATE : APRIL 2023

EXHIBIT: **A**

AMERICAN AIRLINES, INC.

RAMP SPACES

617103

ELLISON ONIZUKA KONA INTERNATIONAL AIRPORT AT KEAHOLE

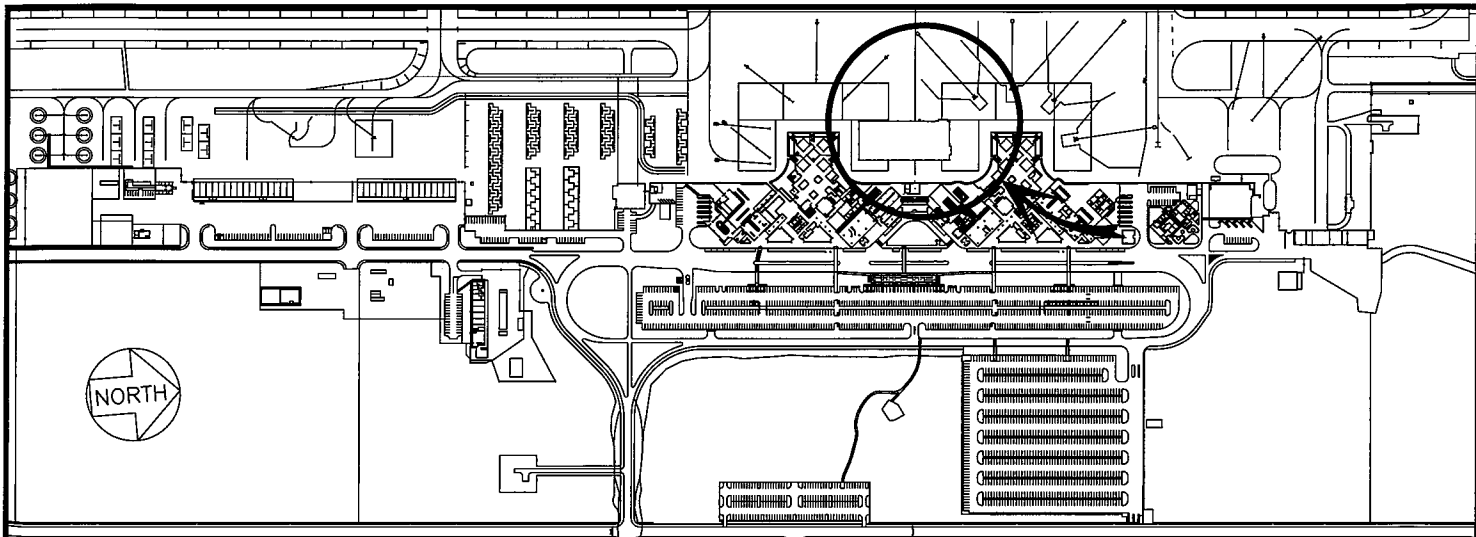

LOCATION PLAN

600:1

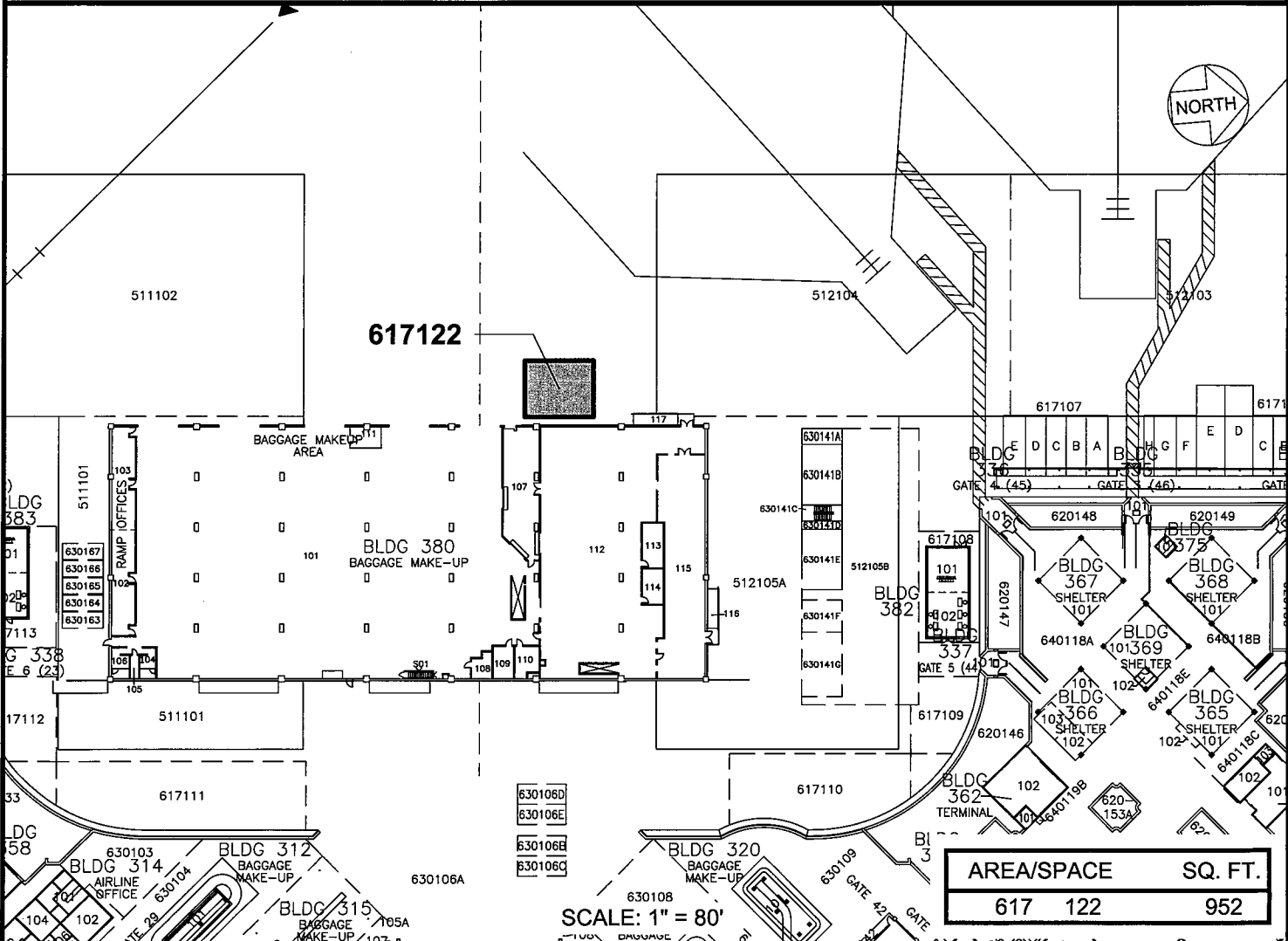

AREA/SPACE	SQ. FT.
617 122	952

SCALE: 1" = 80'

RP-9481

DATE: APRIL 2023

EXHIBIT: **B**

DEPARTMENT OF TRANSPORTATION
STATE OF HAWAII
AIRPORTS

AMERICAN AIRLINES, INC.

RAMP SPACES

617122

ELLISON ONIZUKA KONA INTERNATIONAL AIRPORT AT KEAHOLE

N:\AIRPORTS\KONA\KONACAD\PIK\KOA_617122-01_DRAFT.DWG

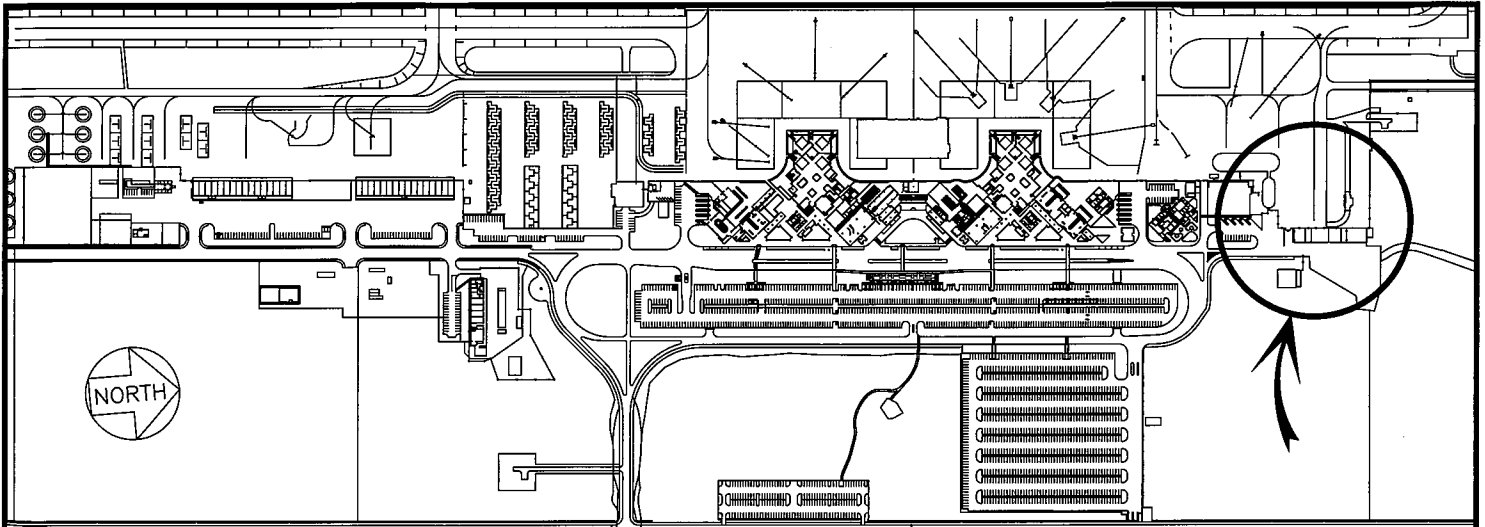

LOCATION PLAN

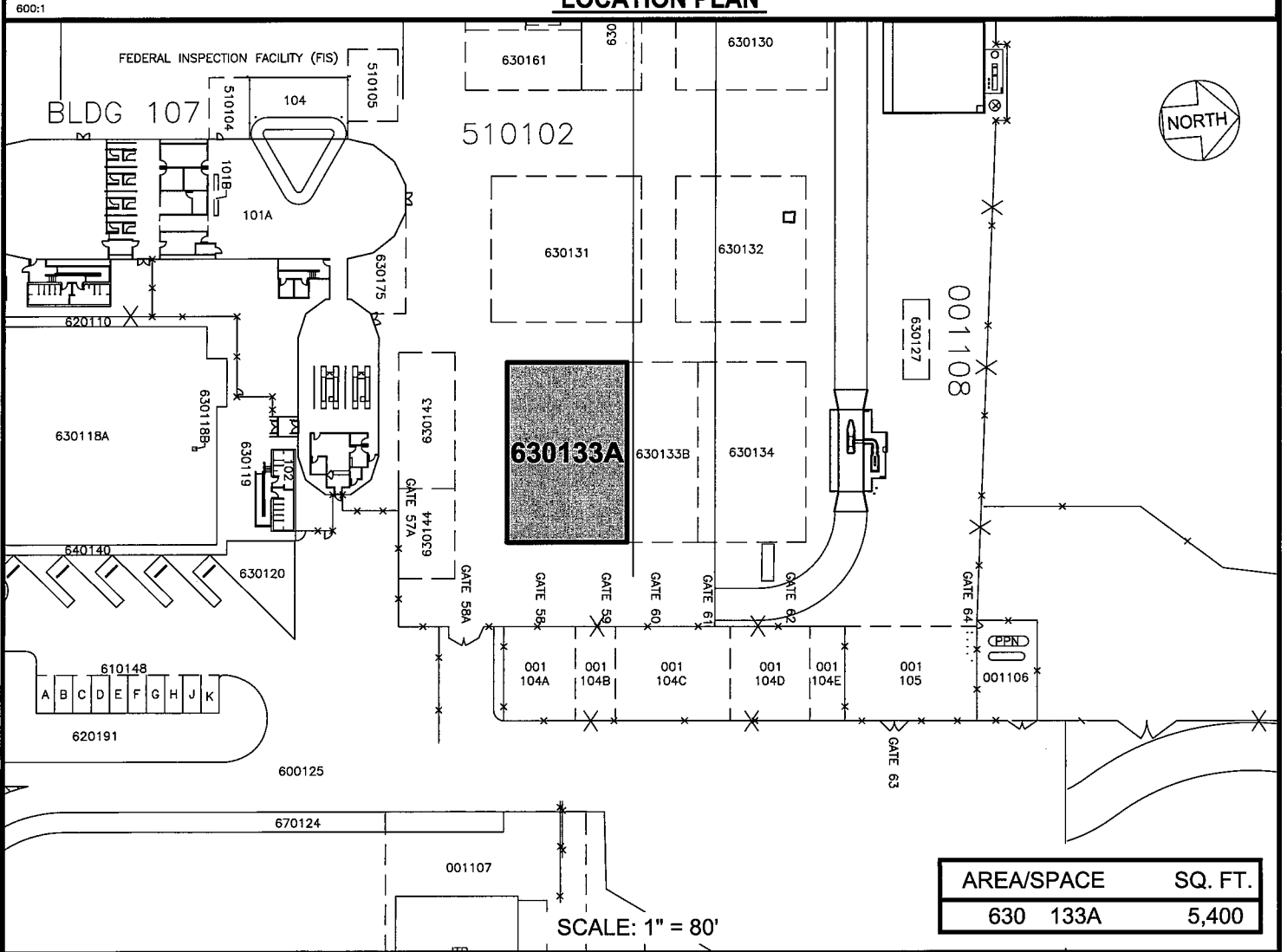

RP-9481

DATE : APRIL 2023

EXHIBIT: **C**



AIRPORTS

AMERICAN AIRLINES, INC.

PAVED AREA

630133A

ELLISON ONIZUKA KONA INTERNATIONAL AIRPORT AT KEAHOLE