



**STATE OF HAWAII**  
**DEPARTMENT OF TRANSPORTATION**  
869 PUNCHBOWL STREET  
HONOLULU, HAWAII 96813-5097

Board of Land and  
Natural Resources  
State of Hawaii  
Honolulu, Hawaii

ISSUANCE OF A REVOCABLE PERMIT FOR AIRCRAFT PARKING  
JONATHAN D. REAL  
WAIMEA-KOHALA AIRPORT  
TAX MAP KEY: (3) 6-7-001: PORTION OF 008

HAWAII

REQUEST:

Issuance of a Revocable Permit for Aircraft Parking (Parking Permit) to Jonathan D. Real for an aircraft tie-down space, situated at Waimea-Kohala Airport.

LEGAL REFERENCE:

Section 171-55, Hawaii Revised Statutes (HRS), as amended.

APPLICANT:

Jonathan D. Real, whose mailing address is 59-677 Kailiawa Place, Kamuela, Hawaii 96743.

LOCATION AND TAX MAP KEY:

Portion of Waimea-Kohala Airport (MUE), Kamuela, Island of Hawaii, identified by Tax Map Key: (3) 6-7-001: Portion of 008.

AREA:

Area/Space No. 401-103, containing an area of approximately 990 square feet of improved, paved land, as shown and delineated on the attached Exhibit A.

ZONING:

State Land Use District: Agricultural District  
County of Hawaii: A-40A Agriculture

**ITEM M-21**

LAND TITLE STATUS:

Section 5(a) lands of the Hawaii Admission Act: Non-Ceded  
DHHL 30% entitlement lands pursuant to Hawaii Admission Act YES \_\_\_ NO X

CURRENT USE STATUS:

Land presently encumbered by Governor's Executive Order No. 1789, dated May 21, 1957, setting aside a portion of the Airport under the control and management of the State of Hawaii, Department of Transportation (HDOT) for Airport Purposes.

CHARACTER OF USE:

Aircraft tie-down (1980 Cessna 172RG Cutlass II, N6523V).

COMMENCEMENT DATE:

To be determined by the Director of Transportation at a later date.

MONTHLY RENTAL:

\$55.00 (as determined from the HDOT schedule of rates and charges established by appraisal of Airports property statewide).

SECURITY DEPOSIT:

\$165.00, or three times the monthly rental in effect.

CHAPTER 343, HRS - ENVIRONMENTAL ASSESSMENT:

HDOT has determined that the environmental impacts of the proposed tenant lease for the subject land use is covered by the Waimea-Kohala Airport Final Environmental Assessment (FEA), published by the Office of Environmental Quality Control (OEQC) in the November 8, 1999, issue of The Environmental Notice. Accordingly, all relevant mitigation from the FEA and best management practices will be implemented to address the minimum impacts of this action.

REMARKS:

In accordance with Section 171-55, HRS, relating to Permits, HDOT proposes to issue a month-to-month Parking Permit to Jonathan D. Real for an aircraft parking space at MUE.

BLNR – ISSUANCE OF A REVOCABLE PERMIT FOR AIRCRAFT PARKING

JONATHAN D. REAL

Page 3

RECOMMENDATION:

Based on this submittal, and testimony and facts presented, HDOT recommends the Board finds that approving the issuance of a month-to-month Parking Permit to Jonathan D. Real, including its conditions and rent, will serve the best interests of the State.

Respectfully submitted,



EDWIN H. SNIFFEN  
Director of Transportation

APPROVED FOR SUBMITTAL:



DAWN N. S. CHANG  
Chairperson  
Board of Land and Natural Resources

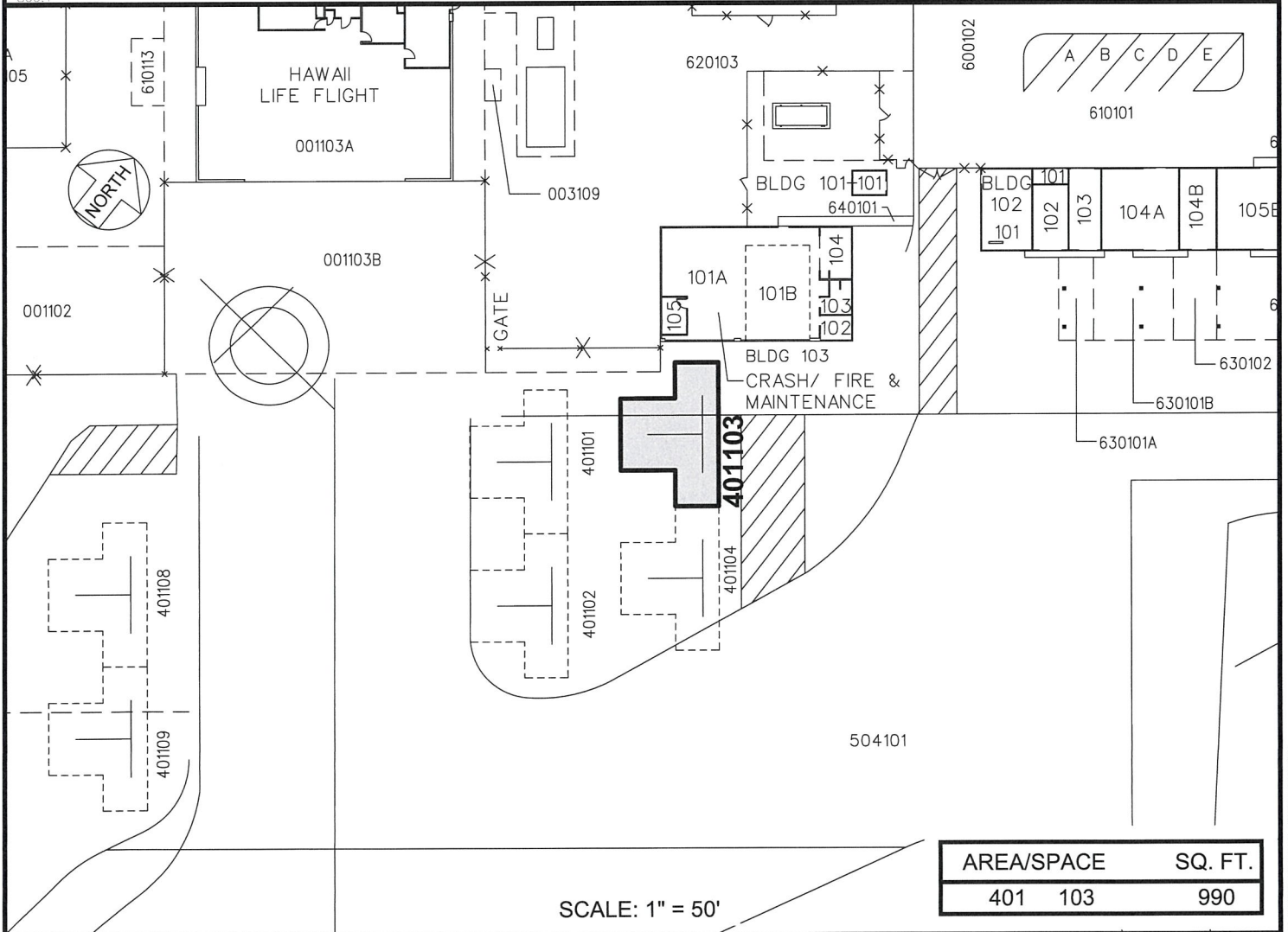
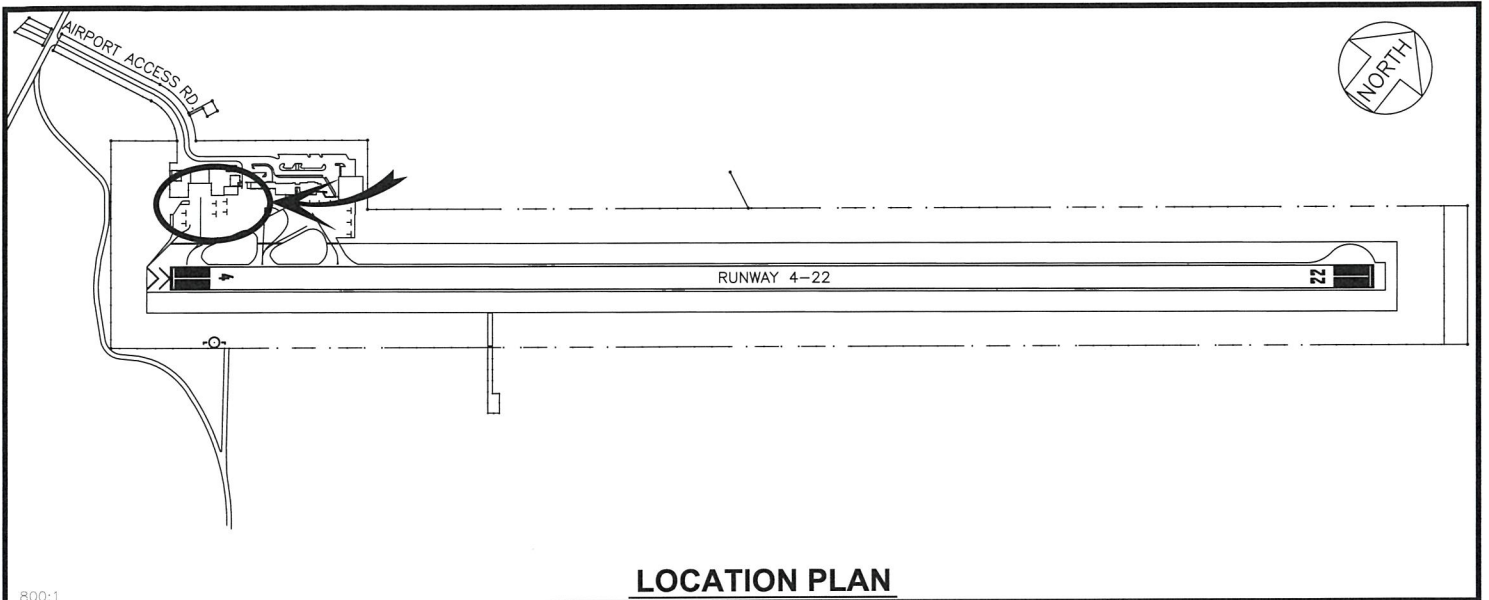

AREA/SPACE	SQ. FT.
401 103	990

DATE : MAY 2023

EXHIBIT: **A**

DEPARTMENT OF TRANSPORTATION  
STATE OF HAWAII

**AIRPORTS**

JONATHAN D. REAL

TIE-DOWN

401103

WAIMEA-KOHALA AIRPORT

N:\AIRPORTS\WAE\_WAIMEA-KOHALA\CADD\PM\WAE\_401103-01.DWG