

JOSH GREEN, M.D.
GOVERNOR



STATE OF HAWAII
DEPARTMENT OF TRANSPORTATION
869 PUNCHBOWL STREET
HONOLULU, HAWAII 96813-5097

EDWIN H. SNIFFEN
DIRECTOR

Deputy Directors
FORD N. FUCHIGAMI
DREANALEE K. KALILI
TAMMY L. LEE
ROBIN K. SHISHIDO

IN REPLY REFER TO:

Board of Land and
Natural Resources
State of Hawaii
Honolulu, Hawaii

ISSUANCE OF A REVOCABLE PERMIT FOR USE OF A T-HANGAR
FOR STORAGE AND MAINTENANCE OF A PRIVATE AIRCRAFT
GEORGE K. HANZAWA
DANIEL K. INOUYE INTERNATIONAL AIRPORT
TAX MAP KEY: (1) 1-1-076: PORTION OF 020

OAHU

REQUEST:

Issuance of a Revocable Permit for use of a T-Hangar for the storage and maintenance of a private aircraft to George K. Hanzawa, situated at Daniel K. Inouye International Airport.

LEGAL REFERENCE:

Section 171-55, Hawaii Revised Statutes (HRS), as amended.

APPLICANT:

George K. Hanzawa, whose mailing address is 18 Lagoon Drive, Honolulu, Hawaii 96819.

LOCATION AND TAX MAP KEY:

Daniel K. Inouye International Airport, Island of Oahu, State of Hawaii, identified by Tax Map Key: 1st Division, 1-1-076: portion of 020.

AREA:

Building/Room No. 420-114, containing an area of approximately 1,247 square feet, as shown and delineated on the attached map labeled Exhibit "A".

ZONING:

State Land Use District: Urban
City and County of Honolulu LUO: Industrial (I-2)

ITEM M-1

BLNR – ISSUANCE OF A REVOCABLE PERMIT FOR A T-HANGAR FOR THE STORAGE AND MAINTENANCE OF A PRIVATE AIRCRAFT, GEORGE K. HANZAWA

Page 2

LAND TITLE STATUS:

Non-Ceded - Section 5(a) lands of the Hawaii Admission Act
DHHL 30% entitlement lands pursuant to Hawaii Admission Act YES ___ NO X

CURRENT USE STATUS:

Land presently encumbered by Governor's Executive Order No. 3201, dated June 8, 1983, setting aside 3,152.177 acres designated as Daniel K. Inouye International Airport under the control and management of the State of Hawaii, Department of Transportation (HDOT), for Airport Purposes.

CHARACTER OF USE:

T-Hangar for storage and maintenance of a private aircraft (1981 Cessna 152, Tail No. N-6243Q).

COMMENCEMENT DATE:

To be determined by the Director of Transportation at a later date.

MONTHLY RENTAL:

\$728.00 per month (\$673.00, as determined from the HDOT Schedule of Rates and Charges established by appraisal of Airport properties statewide plus \$55.00 for electricity).

SECURITY DEPOSIT:

\$2,184.00, or three times the monthly rental in effect.

CHAPTER 343, HRS - ENVIRONMENTAL ASSESSMENT:

The environmental impacts of the proposed action to the subject land area are covered by the Honolulu International Airport Master Plan Update and Noise Compatibility Program Environmental Assessment (EA), State Project No. AO1011-03. The EA is a joint State and Federal document, dated September 1989 and published in the October 23, 1989, issue of the OEQC Bulletin. Accordingly, relevant mitigation from the EA and HDOT environmental best management practice will address minimal impacts from this action.

BLNR – ISSUANCE OF A REVOCABLE PERMIT FOR A T-HANGAR FOR THE STORAGE AND MAINTENANCE OF A PRIVATE AIRCRAFT, GEORGE K. HANZAWA

Page 3

REMARKS:

In accordance with Section 171-55, HRS, relating to Permits, the HDOT proposes to issue a month-to-month revocable permit to George K. Hanzawa, for a T-Hangar for the storage and maintenance of a private aircraft, situated at Daniel K. Inouye International Airport.

RECOMMENDATION:

Based on this submittal, and testimony and facts presented, the HDOT recommends the Board finds that approving the issuance of a month-to-month Revocable Permit to George K. Hanzawa, including its conditions and rent, will serve the best interests of the State.

Respectfully submitted,



EDWIN H. SNIFFEN
Director of Transportation

APPROVED FOR SUBMITTAL:



DAWN N. S. CHANG
Chairperson
Board of Land and Natural Resources

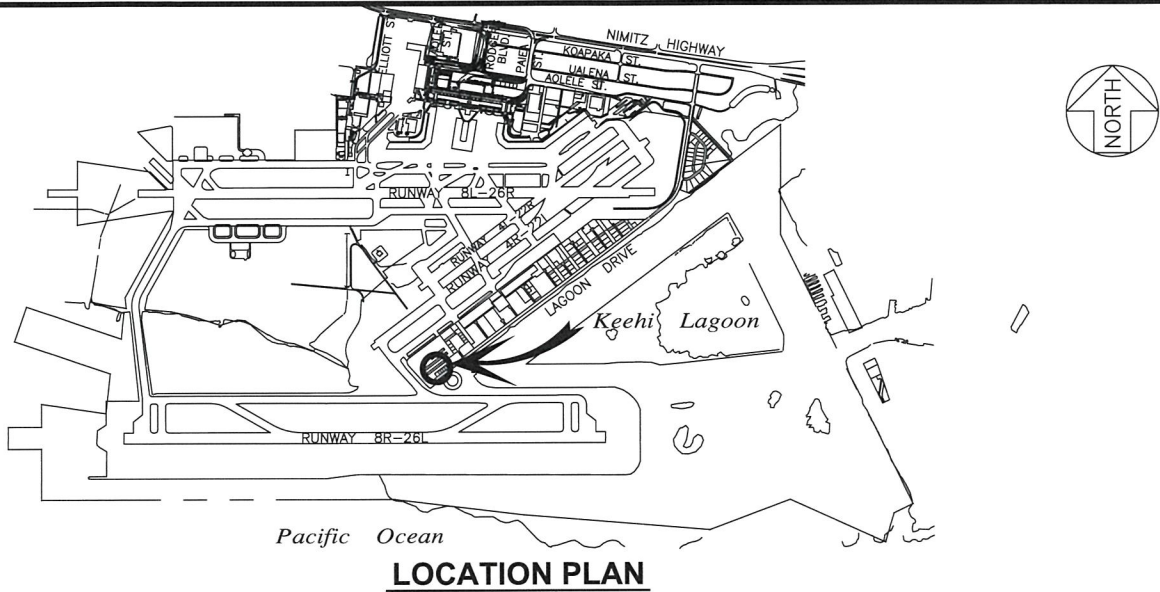

5000:1

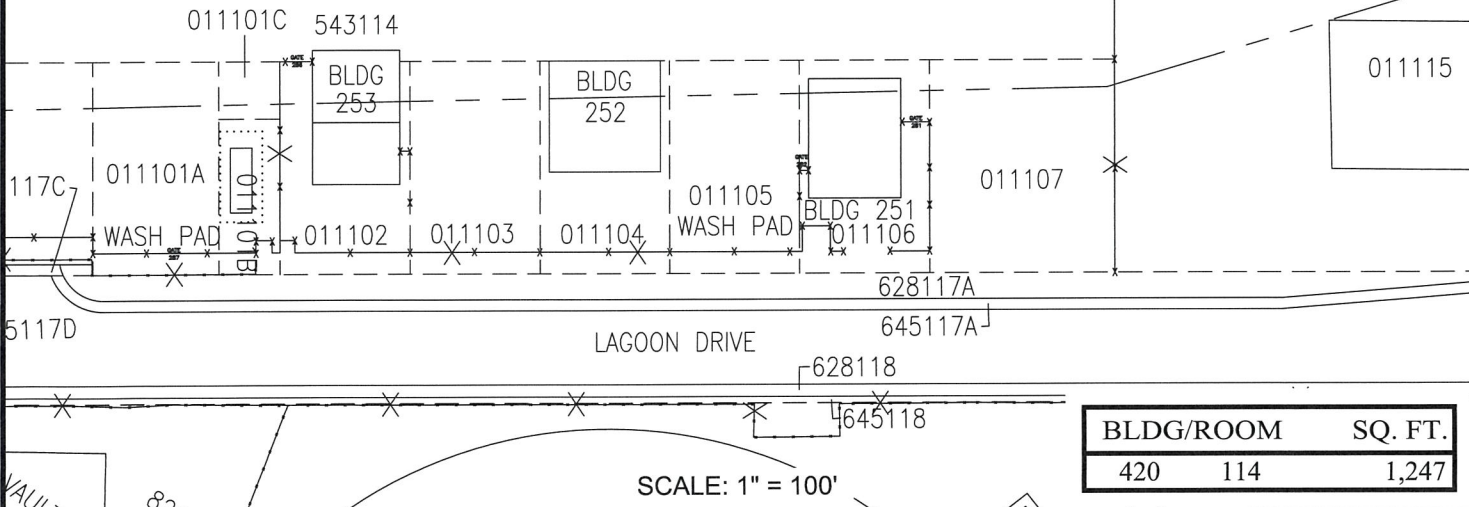
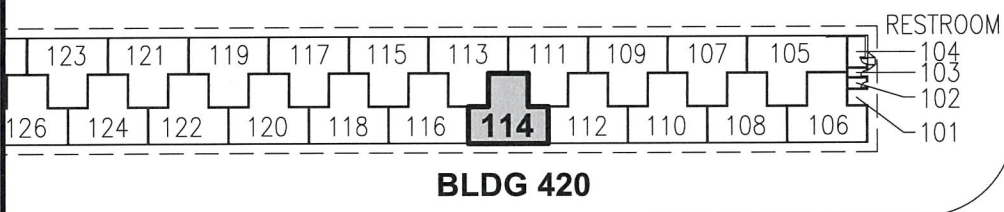
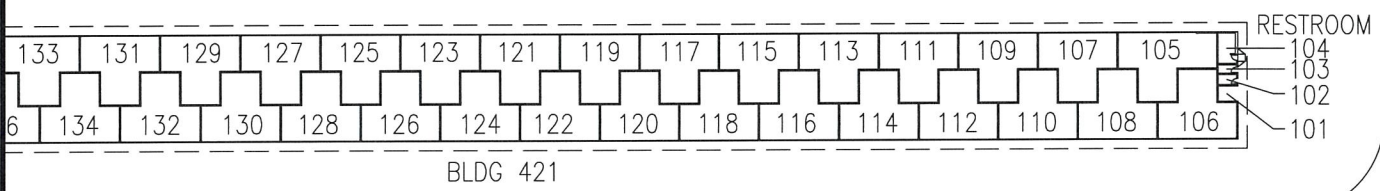

RP-9219	DATE : MARCH 2022	EXHIBIT: A
	HANZAWA, GEORGE K.	T-HANGAR GENERAL AVIATION SOUTH RAMP
		420114 PLAT 45

DANIEL K. INOUE INTERNATIONAL AIRPORT

N:\AIRPORTS\SIHNL_HONOLULUCAD\PI\SIHNL_420114-01.DWG