



STATE OF HAWAII | KA MOKU'ĀINA 'O HAWAI'I
DEPARTMENT OF TRANSPORTATION | KA 'OIHANA ALAKAU
869 PUNCHBOWL STREET
HONOLULU, HAWAII 96813-5097

IN REPLY REFER TO:

Board of Land and
Natural Resources
State of Hawaii
Honolulu, Hawaii

ISSUANCE OF A REVOCABLE PERMIT FOR VEHICLE PARKING
FOR FREIGHT FORWARDING OPERATIONS
KAMUELA TRUCKING INCORPORATED
ELLISON ONIZUKA KONA INTERNATIONAL AIRPORT AT KEAHOLE
TAX MAP KEY: (3) 7-3-043: PORTION OF 003

HAWAII

LEGAL REFERENCE:

Hawaii Revised Statutes (HRS), Section 171-55, as amended.

APPLICANT:

Kamuela Trucking Incorporated (KTI), whose mailing address is 64-497 Mamalahoa Highway, Kamuela, Hawaii 96743.

LOCATION AND TAX MAP KEY:

Portion of Ellison Onizuka Kona International Airport at Keahole (KOA), Kailua-Kona, Island of Hawaii, identified by Tax Map Key: 3rd Division, 7-3-043: Portion of 003.

AREAS:

UNCOVERED, PAVED PARKING

Area/Space No. 610-155M, containing an area of approximately 450 square feet,
Area/Space No. 610-155N, containing an area of approximately 450 square feet,
Area/Space No. 610-155P, containing an area of approximately 450 square feet,
Area/Space No. 610-155Q, containing an area of approximately 450 square feet,
Area/Space No. 610-155R, containing an area of approximately 450 square feet,
Area/Space No. 610-155S, containing an area of approximately 450 square feet, and
Area/Space No. 610-155T, containing an area of approximately 450 square feet, as shown and delineated on the attached Exhibit A.

ITEM M-15

BLNR – ISSUANCE OF A REVOCABLE PERMIT FOR VEHICLE PARKING
FOR FREIGHT FORWARDING OPERATIONS, KAMUELA TRUCKING INCORPORATED
Page 2

ZONING:

State Land Use District: Urban & Conservation
County of Hawaii: Industrial (MG-1a) and Open

LAND TITLE STATUS:

Section 5(a) lands of the Hawaii Admission Act: Ceded
DHHL 30% entitlement lands pursuant to Hawaii Admission Act YES ___ NO X

CURRENT USE STATUS:

Land presently encumbered by Governors Executive Order No. 3074, dated August 20, 1981, setting aside 4,204.10 acres designated as KOA under the control and management of the State of Hawaii, Department of Transportation (HDOT) for Airport Purposes.

CHARACTER OF USE:

KTI will use the 21 parking spaces for delivery vehicles to support its freight forwarding operations at KOA.

COMMENCEMENT DATE:

To be determined by the Director of Transportation at a later date.

MONTHLY RENTAL:

\$1,155.00 (\$55.00 per stall as determined from the HDOT schedule of rates and charges established by appraisal of Airports property statewide).

SECURITY DEPOSIT:

\$3,465.00, or three times the monthly rental in effect.

DCCA VERIFICATION:

Place of business registration confirmed: YES X NO ___
Registered business name confirmed: YES X NO ___
Good standing confirmed: YES X NO ___

CHAPTER 343, HRS - ENVIRONMENTAL ASSESSMENT:

The subject land area pertaining to this action was evaluated for environmental impact by the Keahole Airport Master Plan Final Environmental Impact Statement (EIS), published

BLNR – ISSUANCE OF A REVOCABLE PERMIT FOR VEHICLE PARKING
FOR FREIGHT FORWARDING OPERATIONS, KAMUELA TRUCKING INCORPORATED
Page 3

in The Environmental Notice on November 8, 1988, and accepted by the Governor on December 19, 1988. This action is consistent with the 1988 EIS and the same mitigation conditions apply.

REMARKS:

In accordance with Section 171-55, HRS, relating to Permits, the HDOT proposes to issue a month-to-month revocable permit to KTI for 21 vehicle parking spaces to support its freight forwarding operations at KOA.

RECOMMENDATION:

Based on this submittal, and testimony and facts presented, the HDOT recommends the Board finds that approving the issuance of a month-to-month Revocable Permit to KTI, including its conditions and rent, will serve the best interests of the State.

Respectfully submitted,



EDWIN H. SNIFFEN
Director of Transportation

APPROVED FOR SUBMITTAL:



DAWN N. S. CHANG
Chairperson
Board of Land and Natural Resources

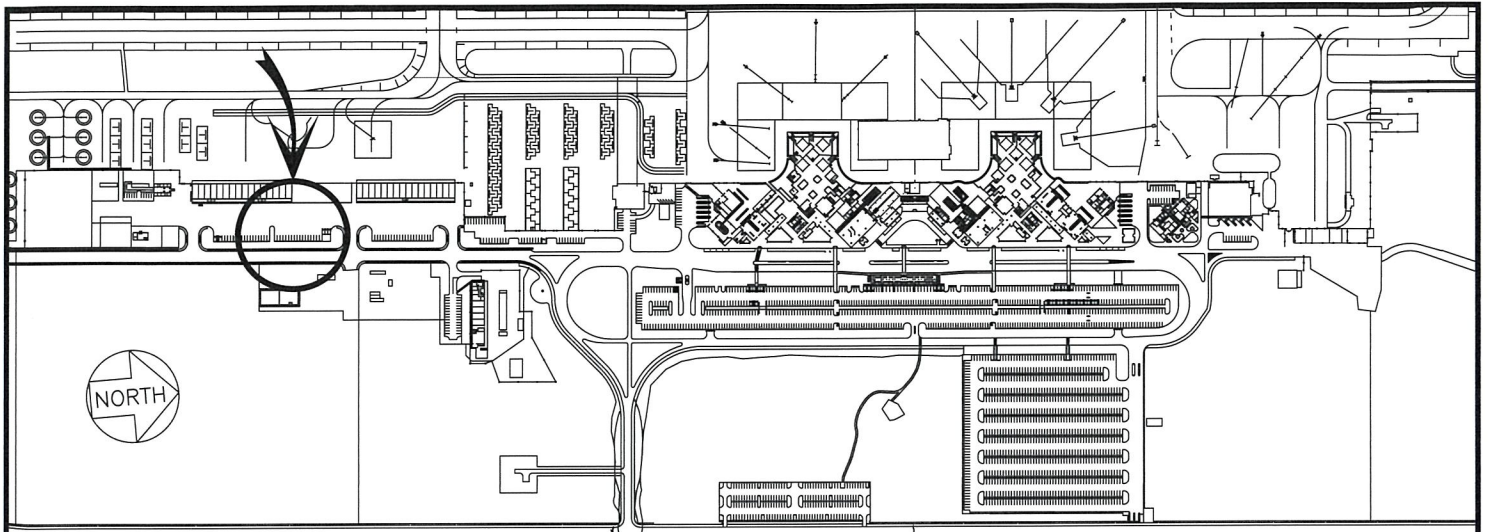

LOCATION PLAN

600:1

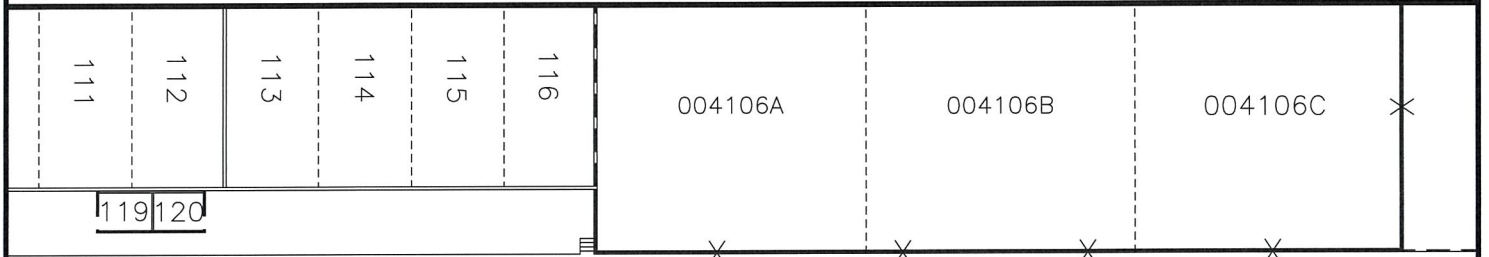

600129

610155

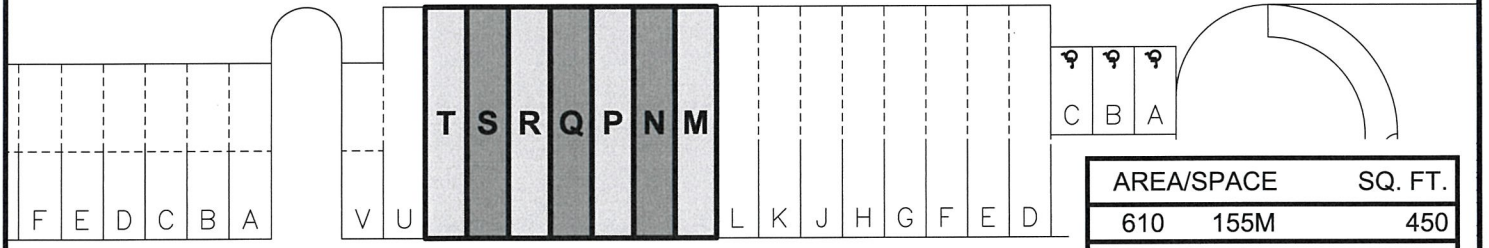

620195

641106

620195B

SCALE: 1" = 40'

DATE : OCTOBER 2023

EXHIBIT: **A**



**KAMUELA TRUCKING
INCORPORATED**

PARKING STALLS

610155M-T

ELLISON ONIZUKA KONA INTERNATIONAL AIRPORT AT KEAHOLE

N:\AIRPORTS\KOA_KONA\CAD\PM\KOA_610155T-02.DWG