

JOSH GREEN, M.D.  
GOVERNOR  
KE KIA'ĀINA



EDWIN H. SNIFFEN  
DIRECTOR  
KA LUNA HO'OKELE

Deputy Directors  
Nā Hope Luna Ho'okele  
DREANALEE K. KALILI  
TAMMY L. LEE  
ROBIN K. SHISHIDO

IN REPLY REFER TO:

**STATE OF HAWAII | KA MOKU'ĀINA 'O HAWAII'**  
**DEPARTMENT OF TRANSPORTATION | KA 'OIHANA ALAKAU**  
869 PUNCHBOWL STREET  
HONOLULU, HAWAII 96813-5097

Board of Land and  
Natural Resources  
State of Hawaii  
Honolulu, Hawaii

ISSUANCE OF A REVOCABLE PERMIT FOR OFFICE SPACE TO  
SUPPORT ITS COMMERCIAL AIRLINE SUPPORT SERVICE OPERATIONS  
PRIMEFLIGHT AVIATION SERVICES, INC.  
DANIEL K. INOUE INTERNATIONAL AIRPORT  
TAX MAP KEY: (1) 1-1-003: 058 (PORTION)

OAHU

APPLICANT:

PrimeFlight Aviation Services, Inc. (PrimeFlight), whose business address is  
300 Rodgers Boulevard, #25, Honolulu, Hawaii 96819.

LEGAL REFERENCE:

Hawaii Revised Statutes (HRS), Section 171-55, as amended.

LOCATION AND TAX MAP KEY:

Portion of Building 344, Ewa Extension Domestic Building, Ground Level at  
Daniel K. Inouye International Airport (Airport), Island of Oahu, State of Hawaii,  
identified by Tax Map Key: 1<sup>st</sup> Division, 1-1-003: 058 (Portion).

AREAS:

Bldg/Room No. 344-119A, containing an area of approximately 384 square feet; and  
Bldg/Room No. 344-119B, containing an area of approximately 111 square feet,  
as shown and delineated on the attached map labeled Exhibit "A".

ZONING:

State Land Use District: Urban  
City and County of Honolulu LUO: Industrial (I-2)

**ITEM M-22**

BLNR – ISSUANCE OF A REVOCABLE PERMIT FOR OFFICE SPACE TO SUPPORT ITS  
COMMERCIAL AIRLINE SUPPORT SERVICE OPERATIONS  
PRIMEFLIGHT AVIATION SERVICES, INC.

Page 2

LAND TITLE STATUS:

Non-Ceded - Section 5(a) lands of the Hawaii Admission Act  
DHHL 30% entitlement lands pursuant to Hawaii Admission Act YES \_\_\_ NO X

CURRENT USE STATUS:

Land presently encumbered by Governor's Executive Order No. 3201, dated  
June 8, 1983, setting aside 3,152.177 acres designated as the Airport under the control  
and management of the State of Hawaii, Department of Transportation (HDOT) for  
Airport Purposes.

CHARACTER OF USE:

PrimeFlight will use the office spaces to support its commercial airline support service  
operations under contract with airlines at the Airport.

COMMENCEMENT DATE:

To be determined by the Director of Transportation at a later date.

MONTHLY RENTAL:

\$1,084.05 (based on an office rate of \$18.60 per square foot per annum, as determined  
from the HDOT schedule of rates and charges established by appraisal of Airport  
property statewide plus \$123.75 for air conditioning and \$193.05 for electricity).

SECURITY DEPOSIT:

\$3,252.15, or three times the monthly rental in effect.

DCCA VERIFICATION:

Place of business registration confirmed:	YES <u>X</u>	NO ___
Registered business name confirmed:	YES <u>X</u>	NO ___
Good standing confirmed:	YES <u>X</u>	NO ___

CHAPTER 343, HRS - ENVIRONMENTAL ASSESSMENT:

The environmental impacts of the proposed action to the subject land area are covered by  
the Honolulu International Airport, Airport Modernization Program Environmental  
Assessment (EA), State Project No. AO1030-13. The EA is a joint State and Federal  
document dated January 2013, and published in the February 8, 2013, issue of the OEQC  
Bulletin. Accordingly, the actions have been determined to have little or no impact upon  
the environment.

BLNR – ISSUANCE OF A REVOCABLE PERMIT FOR OFFICE SPACE TO SUPPORT ITS  
COMMERCIAL AIRLINE SUPPORT SERVICE OPERATIONS  
PRIMEFLIGHT AVIATION SERVICES, INC.

Page 3

REMARKS:

In accordance with HRS, relating to Permits, HDOT proposes to issue a month-to-month revocable permit to PrimeFlight for office space to support its commercial airline support service operations at the Airport.

RECOMMENDATION:

Based on this submittal, and testimony and facts presented, the HDOT recommends the Board finds that approving the issuance of a month-to-month Revocable Permit to PrimeFlight, including its conditions and rent, will best serve the interests of the State.

Respectfully submitted,



EDWIN H. SNIFFEN  
Director of Transportation

APPROVED FOR SUBMITTAL:



DAWN N. S. CHANG  
Chairperson  
Board of Land and Natural Resources

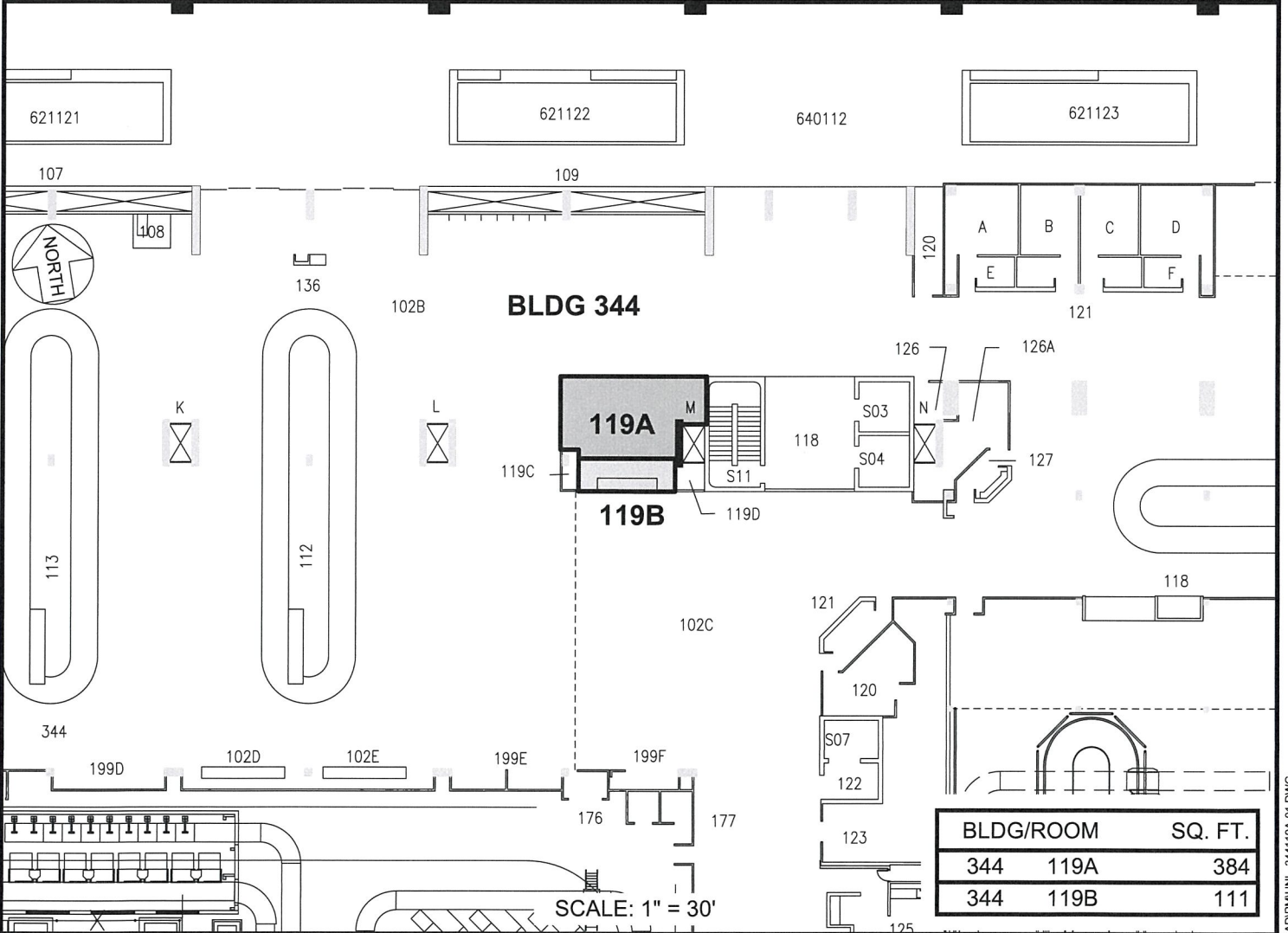
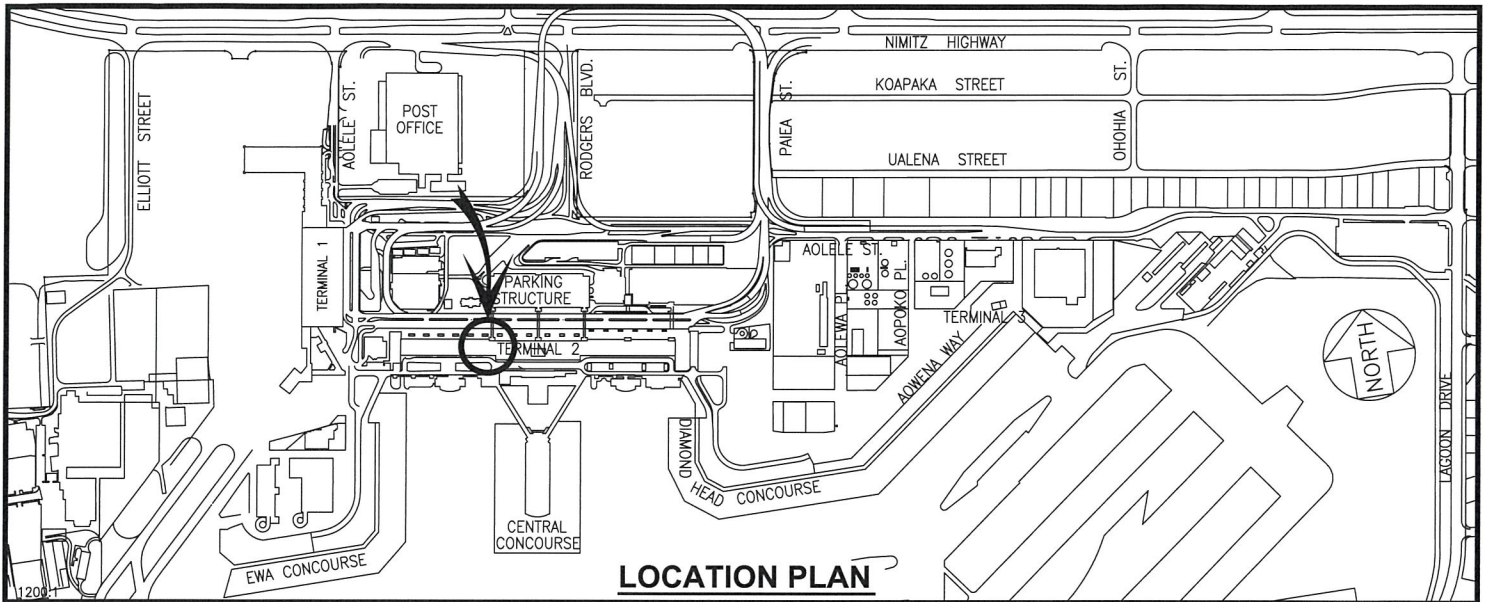

BLDG/ROOM	SQ. FT.
344 119A	384
344 119B	111

RP-9505

DATE : OCTOBER 2023

EXHIBIT: **A**



**PRIMEFLIGHT AVIATION SERVICES, INC.**

**BUILDING 344  
EWA EXT. DOMESTIC BLDG  
GROUND LEVEL**

**344119A-B**