



STATE OF HAWAII | KA MOKU'ĀINA 'O HAWAII
DEPARTMENT OF TRANSPORTATION | KA 'OIHANA ALAKAU
869 PUNCHBOWL STREET
HONOLULU, HAWAII 96813-5097

IN REPLY REFER TO:

Board of Land and
Natural Resources
State of Hawaii
Honolulu, Hawaii

ISSUANCE OF A REVOCABLE PERMIT FOR A T-HANGAR
FOR STORAGE OF MATERIALS AND EQUIPMENT
KCK BUILDERS LLC
DANIEL K. INOUE INTERNATIONAL AIRPORT
TAX MAP KEY: (1) 1-1-76: PORTION OF 20

OAHU

APPLICANT:

KCK Builders LLC (KCK), whose mailing address is 7192 Kalaniana'ole Highway,
Suite A143A #132, Honolulu, Hawaii 96825.

LEGAL REFERENCE:

Hawaii Revised Statutes (HRS), Section 171-55, as amended.

LOCATION AND TAX MAP KEY:

A portion of Daniel K. Inouye International Airport (Airport), Island of Oahu, State of
Hawaii, identified by Tax Map Key: 1st Division, 1-1-076: Portion of 20.

AREA:

Building/Room No. 420-111, containing an area of approximately 1,247 square feet,
as shown and delineated on the attached map labeled Exhibit "A".

ZONING:

State Land Use District: Urban
City and County of Honolulu LUO: Industrial (I-2)

BLNR - ISSUANCE OF A REVOCABLE PERMIT FOR A T-HANGAR
FOR STORAGE OF MATERIALS AND EQUIPMENT, KCK BUILDERS LLC

Page 2

LAND TITLE STATUS:

Non-Ceded - Section 5(a) lands of the Hawaii Admission Act
DHHL 30% entitlement lands pursuant to Hawaii Admission Act YES ___ NO X

CURRENT USE STATUS:

Land presently encumbered by Governor's Executive Order No. 3201, dated June 8, 1983, setting aside 3,152.177 acres designated as the Airport under the control and management of the State of Hawaii, Department of Transportation (HDOT) for Airport Purposes.

CHARACTER OF USE:

KCK will use the T-hangar to store materials and equipment, as specifically stated under Contract No. 71729, State Project No. BS1322-43R, Maintenance & Repairs of T-Hangar and Overhead Doors, Statewide Airports.

COMMENCEMENT DATE:

Upon execution of the revocable permit.

MONTHLY RENTAL:

\$25.00 per month, as stated in Change Order No. 1 of Contract No. 71729, State Project No. BS1322-43R, Maintenance & Repairs of T-Hangar and Overhead Doors, Statewide Airports.

SECURITY DEPOSIT:

\$75.00, or three times the monthly rental in effect.

DCCA VERIFICATION:

Place of business registration confirmed:	YES <u>X</u>	NO ___
Registered business name confirmed:	YES <u>X</u>	NO ___
Good standing confirmed:	YES <u>X</u>	NO ___

CHAPTER 343, HRS - ENVIRONMENTAL ASSESSMENT:

The subject land area is covered by the Environmental Impact Assessment (EA) for the South Ramp Expansion Area Project, dated March 1990, and published by the Office of Environmental Quality Control (OEQC) in the March 23, 1990 issue of the Environmental Notice. Accordingly, relevant mitigation from the EA and HDOT

BLNR - ISSUANCE OF A REVOCABLE PERMIT FOR A T-HANGAR
FOR STORAGE OF MATERIALS AND EQUIPMENT, KCK BUILDERS LLC

Page 3

environmental best management practices will be implemented to address the minimum impacts of this action.

REMARKS:

In accordance with HRS, relating to Permits, HDOT proposes to issue a permit to KCK for a T-Hangar to store materials and equipment, as specifically stated in Change Order No. 1, Contract No. 71729, State Project No. BS1322-43R, Maintenance & Repairs of T-Hangar and Overhead Doors, Statewide Airports, "Pending the availability of space on airport property, the State will issue Revocable Permit(s) to the Contractor for the use of the space, assessed at a monthly fee of \$25.00 for each Revocable Permit issued. The space(s) may be used for a field office, staging of materials and equipment, vehicle parking or other uses subject to the approval of the State...."

RECOMMENDATION:

Based on this submittal, and testimony and facts presented, HDOT recommends the Board finds that approving the issuance of a month-to-month Revocable Permit to KCK, including its conditions and rent, will serve the best interests of the State.

Respectfully submitted,



EDWIN H. SNIFFEN
Director of Transportation

APPROVED FOR SUBMITTAL:



DAWN N. S. CHANG
Chairperson
Board of Land and Natural Resources

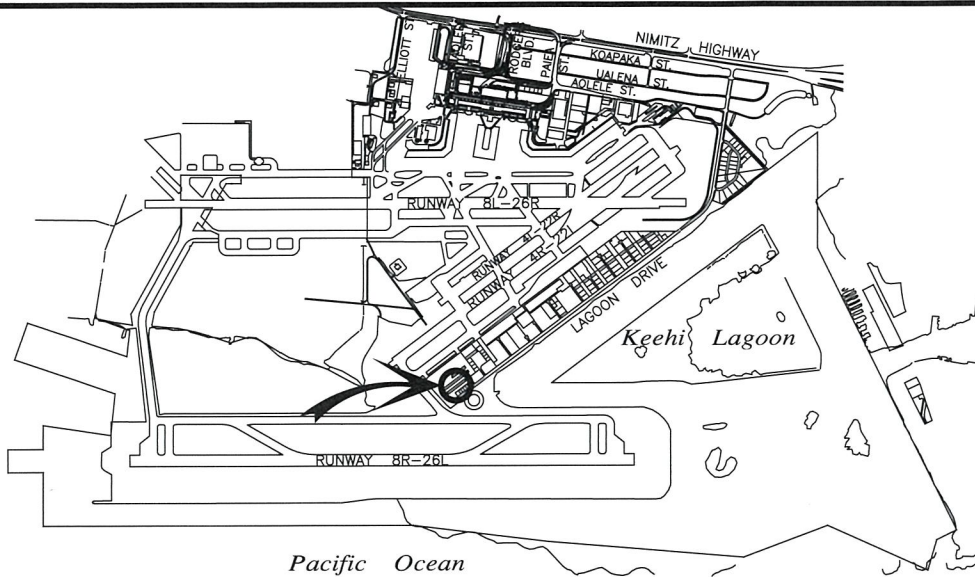

LOCATION PLAN

5000:1

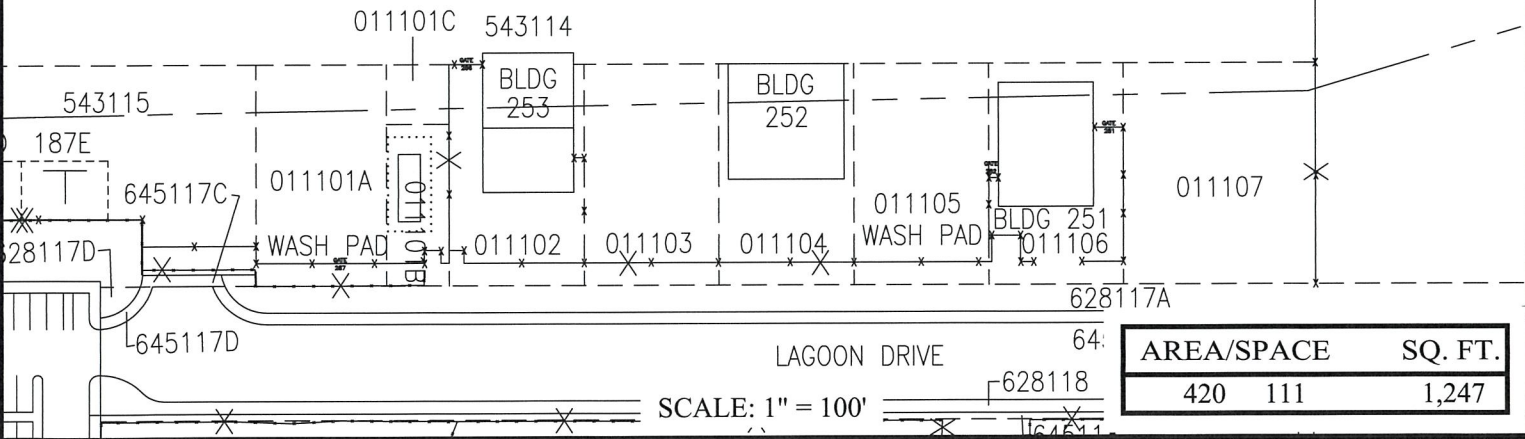
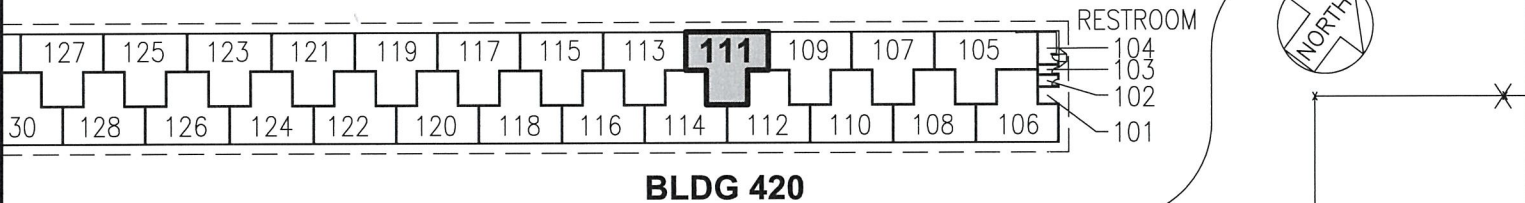
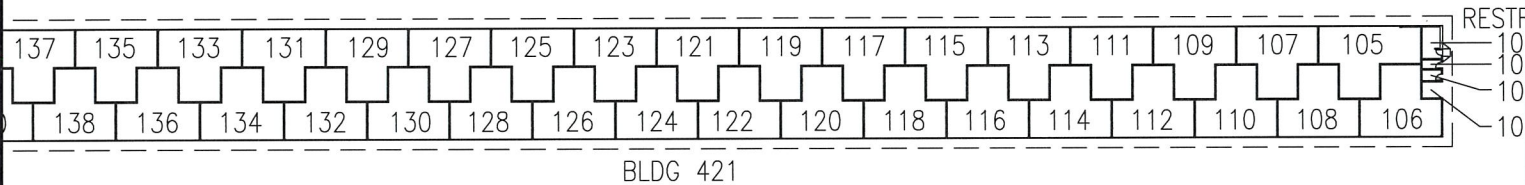
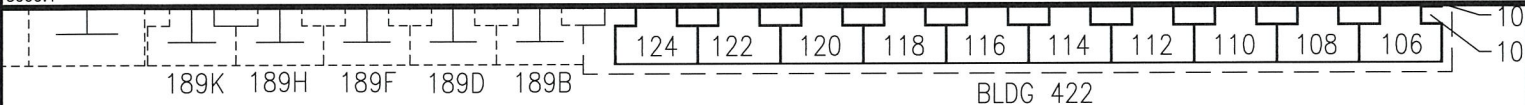

AREA/SPACE	SQ. FT.
420 111	1,247

SCALE: 1" = 100'

DATE : APRIL 2018

EXHIBIT: **A**



T-HANGAR
GENERAL AVIATION
SOUTH RAMP

420111
PLAT 45