



STATE OF HAWAII | KA MOKU'ĀINA 'O HAWAII'
DEPARTMENT OF TRANSPORTATION | KA 'OIHANA ALAKAU
869 PUNCHBOWL STREET
HONOLULU, HAWAII 96813-5097

Board of Land and
Natural Resources
State of Hawaii
Honolulu, Hawaii

ISSUANCE OF A REVOCABLE PERMIT FOR VEHICLE PARKING
HAWAIIAN AIRLINES, INC.
DANIEL K. INOUE INTERNATIONAL AIRPORT
TAX MAP KEY: (1) 1-1-003: 001 (PORTION)

OAHU

APPLICANT:

Hawaiian Airlines, Inc. (Hawaiian Airlines), whose business address is
3375 Koapaka Street, Suite G350, Honolulu, Hawaii 96819.

LEGAL REFERENCE:

Hawaii Revised Statutes (HRS), Section 171-55, as amended.

LOCATION AND TAX MAP KEY:

Parking stall, Third Level in Terminal 1, Daniel K. Inouye International Airport
(Airport), Island of Oahu, State of Hawaii, identified by Tax Map Key:
1st Division, 1-1-003: 001 (Portion).

AREA:

Area/Space No. 610-301C, containing an area of 153 square feet, as shown and
delineated on the attached map labeled Exhibit "A".

ZONING:

State Land Use District: Urban
City and County of Honolulu LUO: Industrial (I-2)

LAND TITLE STATUS:

Section 5(a) lands of the Hawaii Admissions Act: Non-ceded
DHHL 30% entitlement lands pursuant to the Hawaii State Constitution: YES ___ NO X

CURRENT USE STATUS:

Land presently encumbered by Governor's Executive Order No. 3201, dated June 8, 1983, setting aside 3,152.177 acres designated as the Airport under the control and management of the State of Hawaii, Department of Transportation (HDOT) for Airport Purposes.

CHARACTER OF USE:

Hawaiian Airlines will use the space for vehicle parking outside of the Hawaiian Airlines VIP Lounge as part of their signatory airline operations at the Airport.

COMMENCEMENT DATE:

Upon execution of the revocable permit.

MONTHLY RENTAL:

\$1,596.05, as determined from the Airports Division Signatory Rates and Charges, Hawaii Airports System.

SECURITY DEPOSIT:

\$4,788.15, or three times the monthly rental in effect.

DCCA VERIFICATION:

Place of business registration confirmed:	YES <u>X</u>	NO ___
Registered business name confirmed:	YES <u>X</u>	NO ___
Good standing confirmed:	YES <u>X</u>	NO ___

CHAPTER 343, HRS - ENVIRONMENTAL ASSESSMENT:

The environmental impacts of the proposed action to the subject land area are covered by the Honolulu International Airport Master Plan Update and Noise Compatibility Program Environmental Assessment (EA), State Project No. AO1011-03. The EA is a joint State and Federal document, dated September 1989 and published in the October 23, 1989 issue of the OEQC Bulletin. Accordingly, relevant mitigation from the EA and HDOT environmental best management practice will address minimal impacts from this action.

BLNR – ISSUANCE OF A REVOCABLE PERMIT FOR VEHICLE PARKING
HAWAIIAN AIRLINES, INC.

Page 3

REMARKS:

In accordance with HRS, relating to Permits, HDOT proposes to issue a month-to-month revocable permit to Hawaiian Airlines, for vehicle parking as part of their signatory airline operations at the Airport. Hawaiian Airlines is a signatory airline carrier with airline operations located mainly within Terminal 1.

RECOMMENDATION:

Based on this submittal, and testimony and facts presented, the HDOT recommends the Board finds that approving the issuance of a month-to-month Revocable Permit to Hawaiian Airlines, including its conditions and rent, will best serve the interests of the State.

Respectfully submitted,



EDWIN H. SNIFFEN
Director of Transportation

APPROVED FOR SUBMITTAL:



DAWN N. S. CHANG
Chairperson
Board of Land and Natural Resources

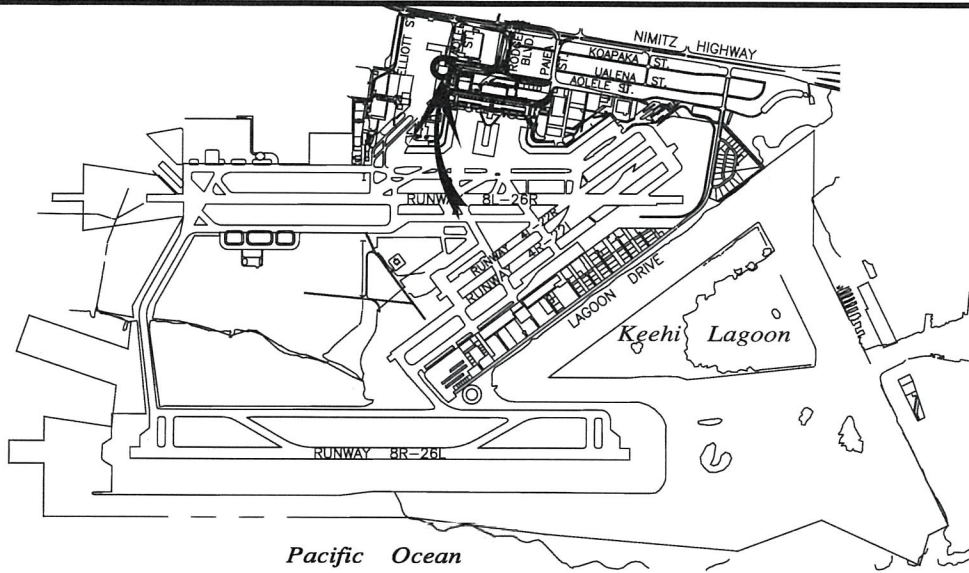

5000:1

LOCATION PLAN

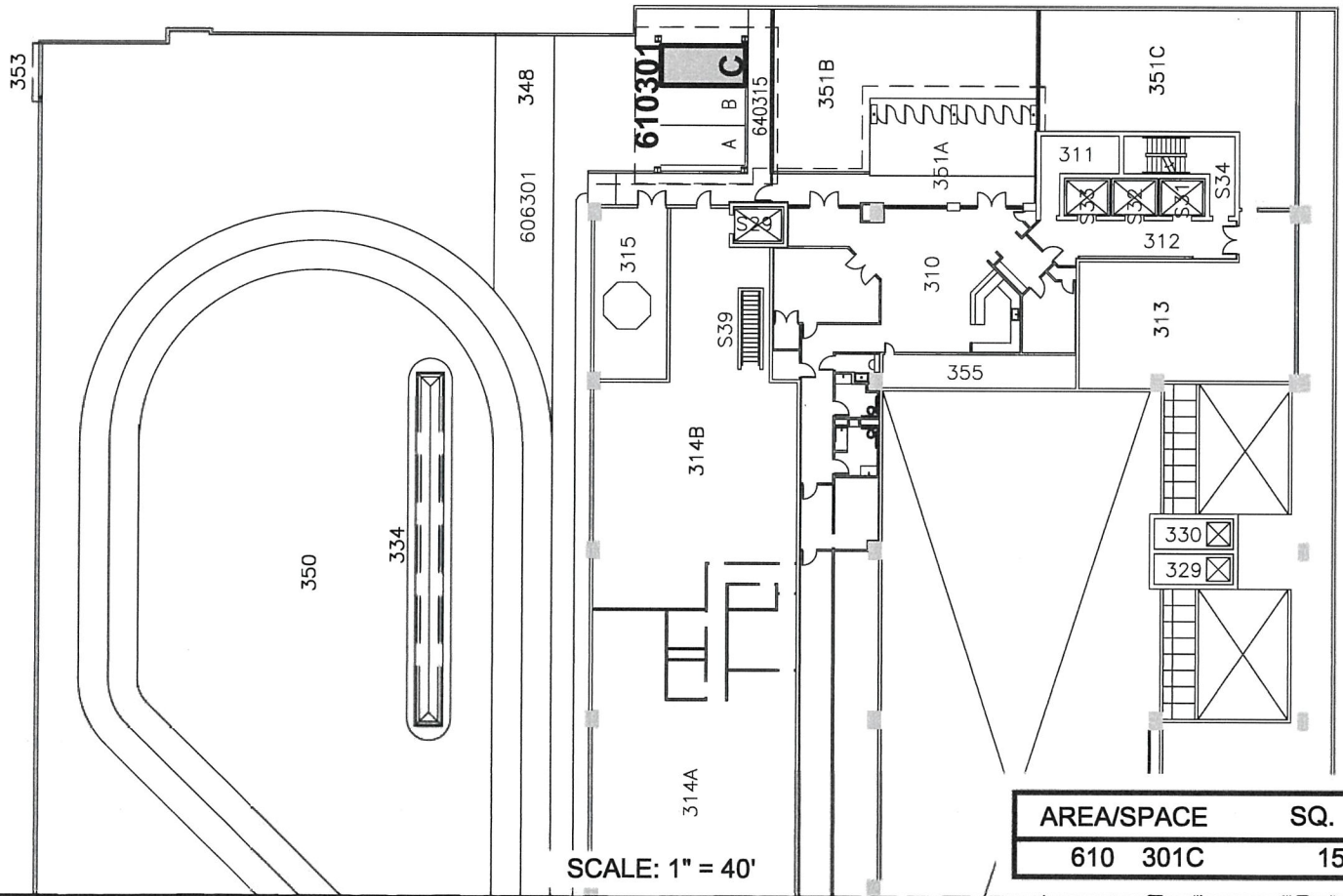

SCALE: 1" = 40'

AREA/SPACE	SQ. FT.
610 301C	153

RP-9519

DATE : NOVEMBER 2023

EXHIBIT: **A**



AIRPORTS

HAWAIIAN AIRLINES, INC.

PARKING STALL

610301C

DANIEL K. INOUE INTERNATIONAL AIRPORT

N:\AIRPORTS\HNL_HONOLULU\CAD\PM\HNL_610301C-01.DWG