

JOSH GREEN, M.D.
GOVERNOR
KE KIA'ĀINA



EDWIN H. SNIFFEN
DIRECTOR
KA LUNA HO'OKELE

Deputy Directors
Na Hope Luna Ho'okele
DREANALEE K. KALILI
TAMMY L. LEE
ROBIN K. SHISHIDO

STATE OF HAWAII | KA MOKU'ĀINA 'O HAWAII'
DEPARTMENT OF TRANSPORTATION | KA 'OIHANA ALAKAU
869 PUNCHBOWL STREET
HONOLULU, HAWAII 96813-5097

IN REPLY REFER TO:

Board of Land and
Natural Resources
State of Hawaii
Honolulu, Hawaii

ISSUANCE OF A REVOCABLE PERMIT FOR USE OF A T- HANGAR FOR
STORAGE AND MAINTENANCE OF A PRIVATE AIRCRAFT
TERRY GUMZ
KAHULUI AIRPORT
TAX MAP KEY: (2) 3-8-001: PORTION OF 212

MAUI

LEGAL REFERENCE:

Section 171-55, Hawaii Revised Statutes (HRS), as amended.

APPLICANT:

Terry Gumz, whose business address is 49 Kokea Street, Unit 1104, Wailuku,
Hawaii 96793.

LOCATION AND TAX MAP KEY:

Portion of Kahului Airport (OGG), Kahului, Island of Maui, identified by
Tax Map Key: 2nd Division, 3-8-001: Portion of 212.

AREA:

Building/Room No. 411-104, containing an area of approximately 1,063 square feet,
as shown and delineated on the attached Exhibit A.

ZONING:

State Land Use District:	Urban
County of Maui:	Airport

BLNR – ISSUANCE OF A REVOCABLE PERMIT FOR USE OF A T-HANGAR FOR
STORAGE AND MAINTENANCE OF A PRIVATE AIRCRAFT
TERRY GUMZ

Page 2

LAND TITLE STATUS:

Section 5(a) lands of the Hawaii Admission Act: Non-Ceded
DHHL 30% entitlement lands pursuant to Hawaii Admission Act YES ___ NO X

CURRENT USE STATUS:

Land presently encumbered by Governor's Executive Order No. 2427, dated February 12, 1969, setting aside 1,268.938 acres designated as OGG to be under the control and management of the State of Hawaii, Department of Transportation (HDOT) for Airport purposes.

CHARACTER OF USE:

Terry Gumz will use the T-Hangar for storage and maintenance of a private aircraft (1969 Cessna Cardinal C 177A / N-30446) for personal use only.

COMMENCEMENT DATE:

To be determined by the Director of Transportation at a later date.

MONTHLY RENTAL:

\$617.78 (\$554.00 per month, as determined from the HDOT schedule of rates and charges established by appraisal of Airports property statewide, plus \$63.78 for electricity).

SECURITY DEPOSIT:

\$1,853.34, or three times the monthly rental in effect.

CHAPTER 343, HRS - ENVIRONMENTAL ASSESSMENT:

The HDOT has determined that the environmental impacts for the subject land use is covered by the Kahului Airport Improvements Final Environmental Impact Statement (EIS), published by the Office of Environmental Quality Control (OEQC) in the October 23, 1997, issue of The Environmental Notice. The EIS was accepted by the Governor on February 18, 1998. Accordingly, all relevant mitigation from the EIS and best management practices will be implemented to address the minimum impacts of this action.

BLNR – ISSUANCE OF A REVOCABLE PERMIT FOR USE OF A T-HANGAR FOR
STORAGE AND MAINTENANCE OF A PRIVATE AIRCRAFT
TERRY GUMZ

Page 3

REMARKS:

In accordance with Section 171-55, HRS, relating to Permits, the HDOT proposes to issue a month-to-month revocable permit to Terry Gumz, for a T-Hangar for the storage and maintenance of a private aircraft situated at Kahului Airport.

RECOMMENDATION:

Based on this submittal, and testimony and facts presented, the HDOT recommends the Board finds that approving the issuance of a month-to-month revocable permit to Terry Gumz, including its conditions and rent, will serve the best interests of the State.

Respectfully submitted,



EDWIN H. SNIFFEN
Director of Transportation

APPROVED FOR SUBMITTAL:



DAWN N. S. CHANG
Chairperson
Board of Land and Natural Resources

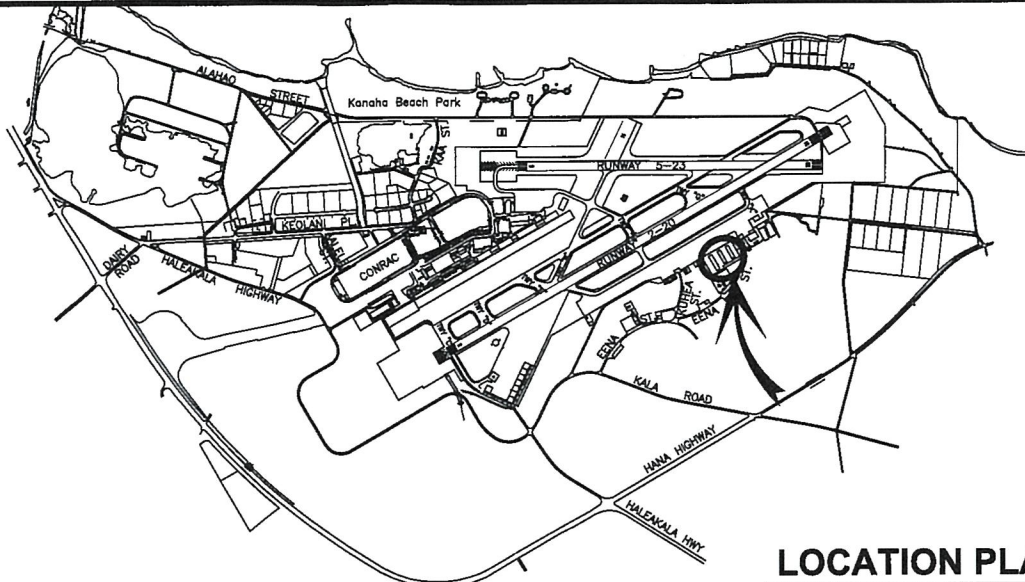

LOCATION PLAN

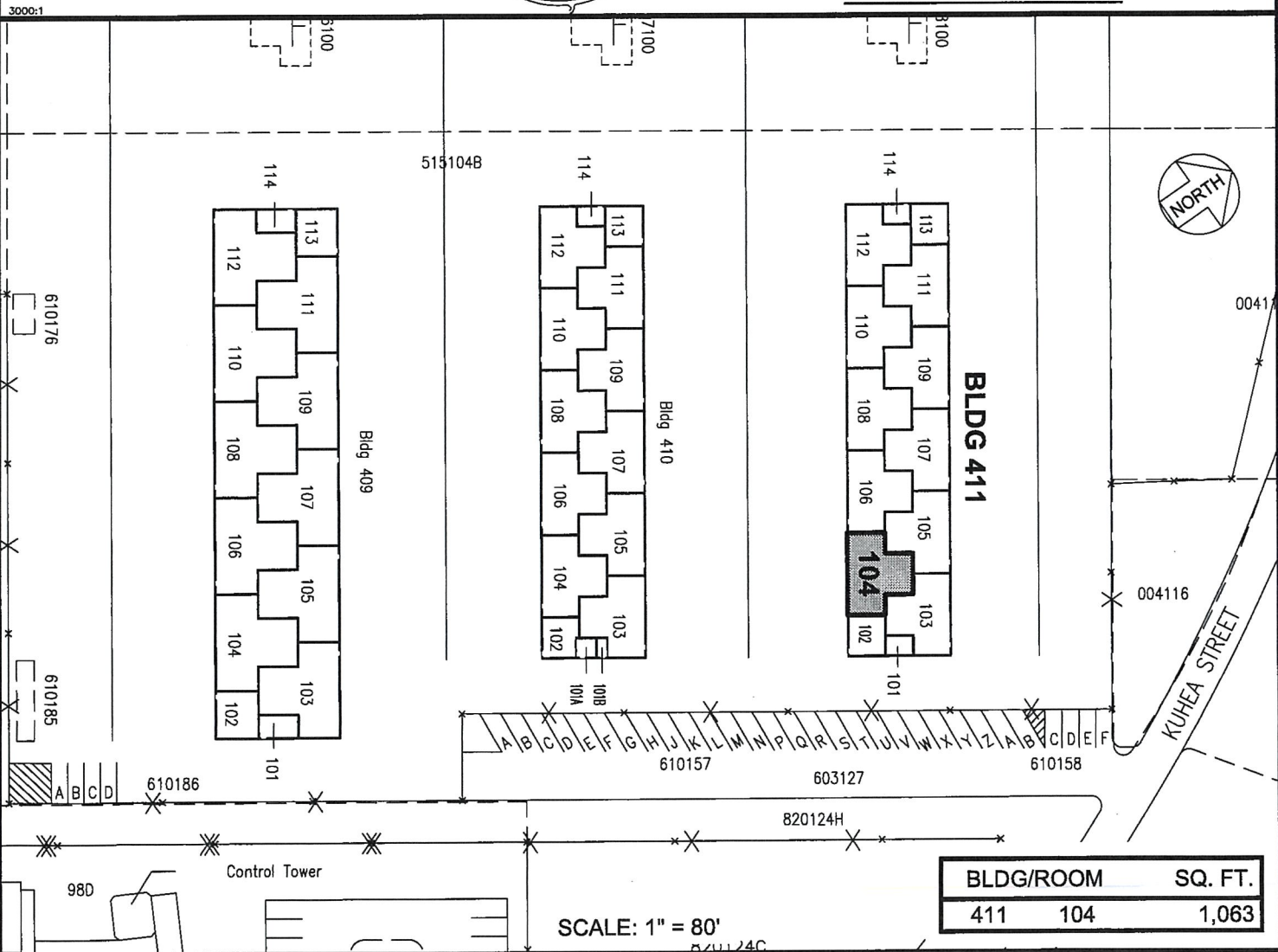

DATE : NOVEMBER 2023

EXHIBIT: **A**



TERRY GUMZ

T-HANGAR

411104

KAHULUI AIRPORT