



STATE OF HAWAII | KA MOKU'ĀINA 'O HAWAII'
DEPARTMENT OF TRANSPORTATION | KA 'OIHANA ALAKAU
869 PUNCHBOWL STREET
HONOLULU, HAWAII 96813-5097

IN REPLY REFER TO:

June 28, 2024

Board of Land and
Natural Resources
State of Hawaii
Honolulu, Hawaii

ISSUANCE OF A REVOCABLE PERMIT FOR WAREHOUSE,
PARTS STORAGE AND VEHICLE PARKING
OSHKOSH AEROTECH, LLC
DANIEL K. INOUE INTERNATIONAL AIRPORT
TAX MAP KEY: (1) 1-1-003: 001

OAHU

APPLICANT:

Oshkosh Aerotech, LLC, whose business address is 758 Kapahulu Avenue,
Suite 100-1133, Honolulu, Hawaii 96816

LEGAL REFERENCE:

Hawaii Revised Statutes (HRS), Section 171-55, as amended.

LOCATION AND TAX MAP KEY:

A portion of Daniel K. Inouye International Airport (Airport), Island of Oahu, State of
Hawaii, identified by Tax Map Key: 1st Division, 1-1-003: 001.

AREA:

Building/Room No. 313-107, containing an area of approximately 1,199 square feet;
Area/Space Nos. 610-120A, containing an area of approximately 127 square feet;
Area/Space Nos. 610-120B, containing an area of approximately 127 square feet; and
Building/Room No. 360-192C, containing an area of approximately 2,300 square feet;
as shown and delineated on the attached maps labeled Exhibit A and Exhibit B.

ZONING:

State Land Use District: Urban
City and County of Honolulu LUO: Industrial (I-2)

ITEM M-10

LAND TITLE STATUS:

Non-Ceded - Section 5(a) lands of the Hawaii Admission Act
DHHL 30% entitlement lands pursuant to Hawaii Admission Act YES ___ NO X

CURRENT USE STATUS:

Land presently encumbered by Governor’s Executive Order No. 3201, dated June 8, 1983, setting aside 3,152.177 acres designated as Airport under the control and management of the State of Hawaii, Department of Transportation (HDOT), for Airport Purposes.

CHARACTER OF USE:

Oshkosh Aerotech, LLC will use the spaces for warehouse, parts storage and vehicle parking in support of its contract to service and maintain the Mauka Extension of Terminal 1 Baggage Handling System.

COMMENCEMENT DATE:

Upon execution of the revocable permit.

MONTHLY RENTAL:

\$4,525.46 (as determined from the Schedule of Rates and Charges established by appraisal of Airports property statewide plus \$897.00 for utilities).

SECURITY DEPOSIT:

\$13,576.38, or three (3) times the monthly rental in effect.

DCCA VERIFICATION:

Place of business registration confirmed:	YES <u>X</u>	NO ___
Registered business name confirmed:	YES <u>X</u>	NO ___
Good standing confirmed:	YES <u>X</u>	NO ___

CHAPTER 343, HRS - ENVIRONMENTAL ASSESSMENT:

The environmental impacts of the proposed action to the subject land area are covered by the Honolulu International Airport Master Plan Update and Noise Compatibility Program Environmental Assessment (EA), State Project No. AO1011-03. The EA is a joint State and Federal document, dated September 1989 and published in the October 23, 1989 issue of the OEQC Bulletin. Accordingly, relevant mitigation from the EA and HDOT environmental best management practice will address minimal impacts from this action.

BLNR – ISSUANCE OF A REVOCABLE PERMIT FOR WAREHOUSE, PARTS STORAGE AND VEHICLE PARKING, OSHKOSH AEROTECH, LLC

Page 3

REMARKS:

In accordance with HRS, relating to Permits, the HDOT proposes to issue a month-to-month revocable permit to Oshkosh Aerotech, LLC for warehouse, parts storage and vehicle parking in support of its contract to service and maintain the Mauka Extension of Terminal 1 Baggage Handling System at the Airport.

RECOMMENDATION:

Based on this submittal, and testimony and facts presented, the HDOT recommends the Board finds that approving the issuance of a month-to-month Revocable Permit to Oshkosh Aerotech, LLC, including its conditions and rent, will serve the best interests of the State.

Respectfully submitted,



EDWIN H. SNIFFEN
Director of Transportation

APPROVED FOR SUBMITTAL:



DAWN N. S. CHANG
Chairperson
Board of Land and Natural Resources

Attachments

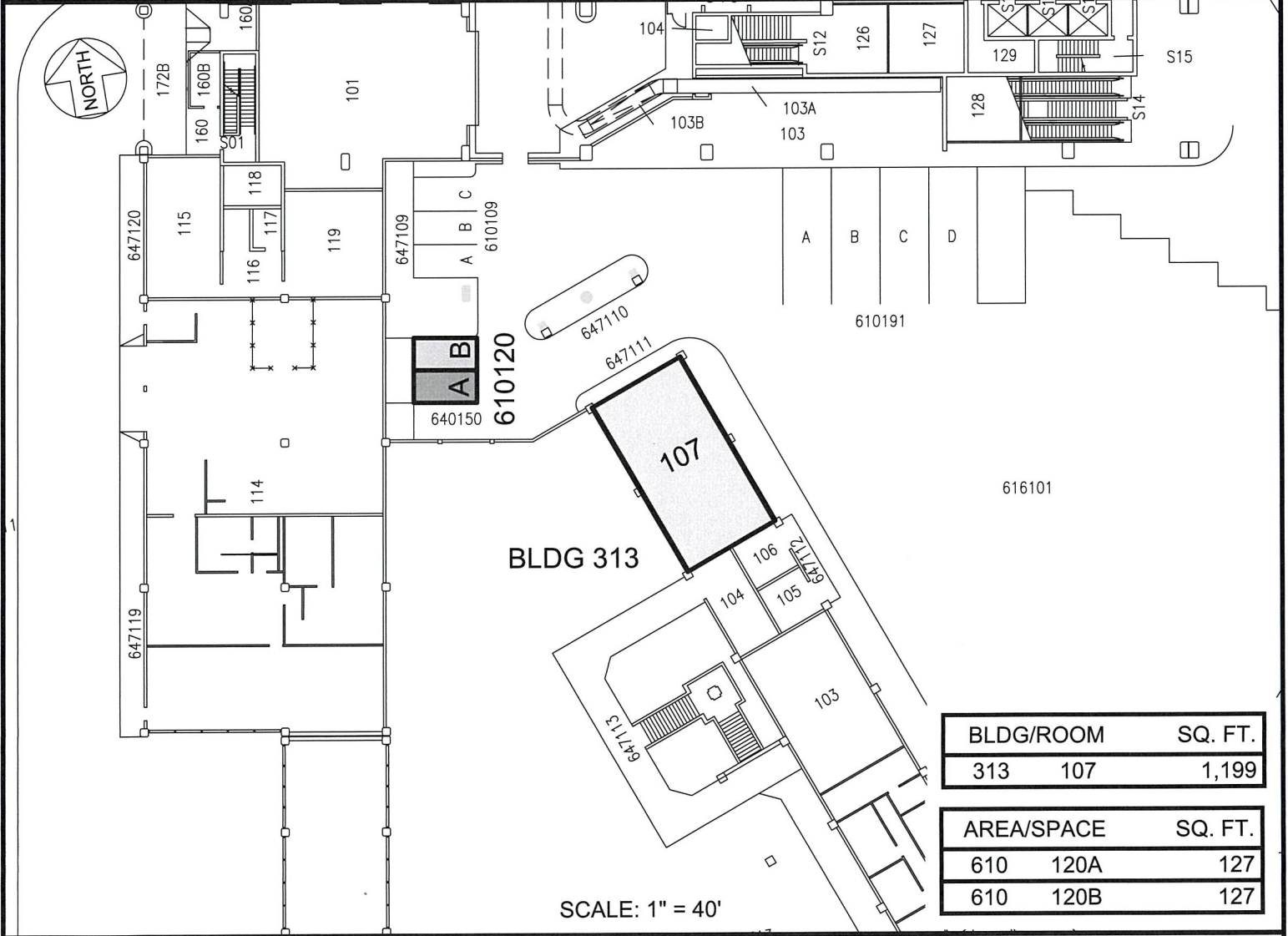
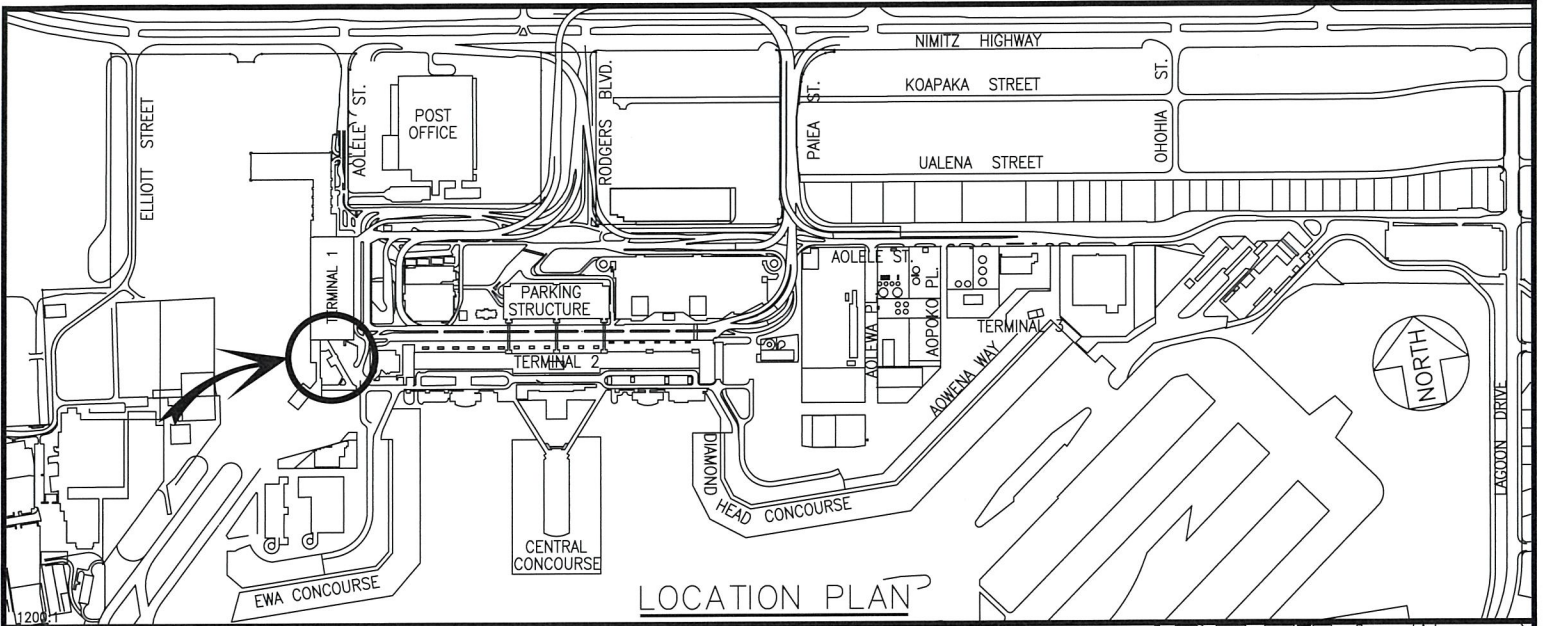

BLDG/ROOM	SQ. FT.
313 107	1,199

AREA/SPACE	SQ. FT.
610 120A	127
610 120B	127

RP-9566 DATE: MAY 30 24 EXHIBIT: **A**



OSHKOSH AERO TECH, LLC

**BUILDING 313,
PASSENGER TERMINAL
COMPLEX & PKG STALLS
GROUND LEVEL**

313107
610120A-B

DANIEL K. INOUE INTERNATIONAL AIRPORT

N:\AIRPORTS\HNL_HONOLULU\CAD\PM\HNL_313107-01.DWG

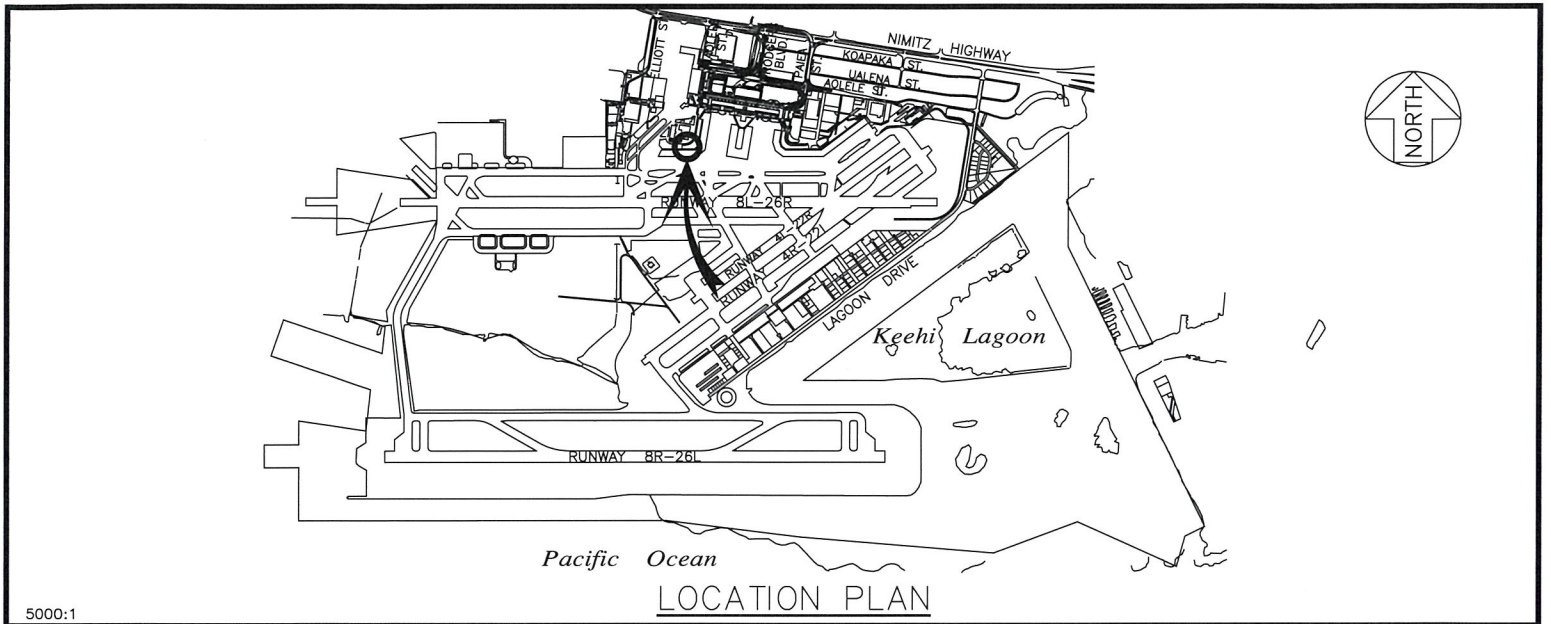

5000:1

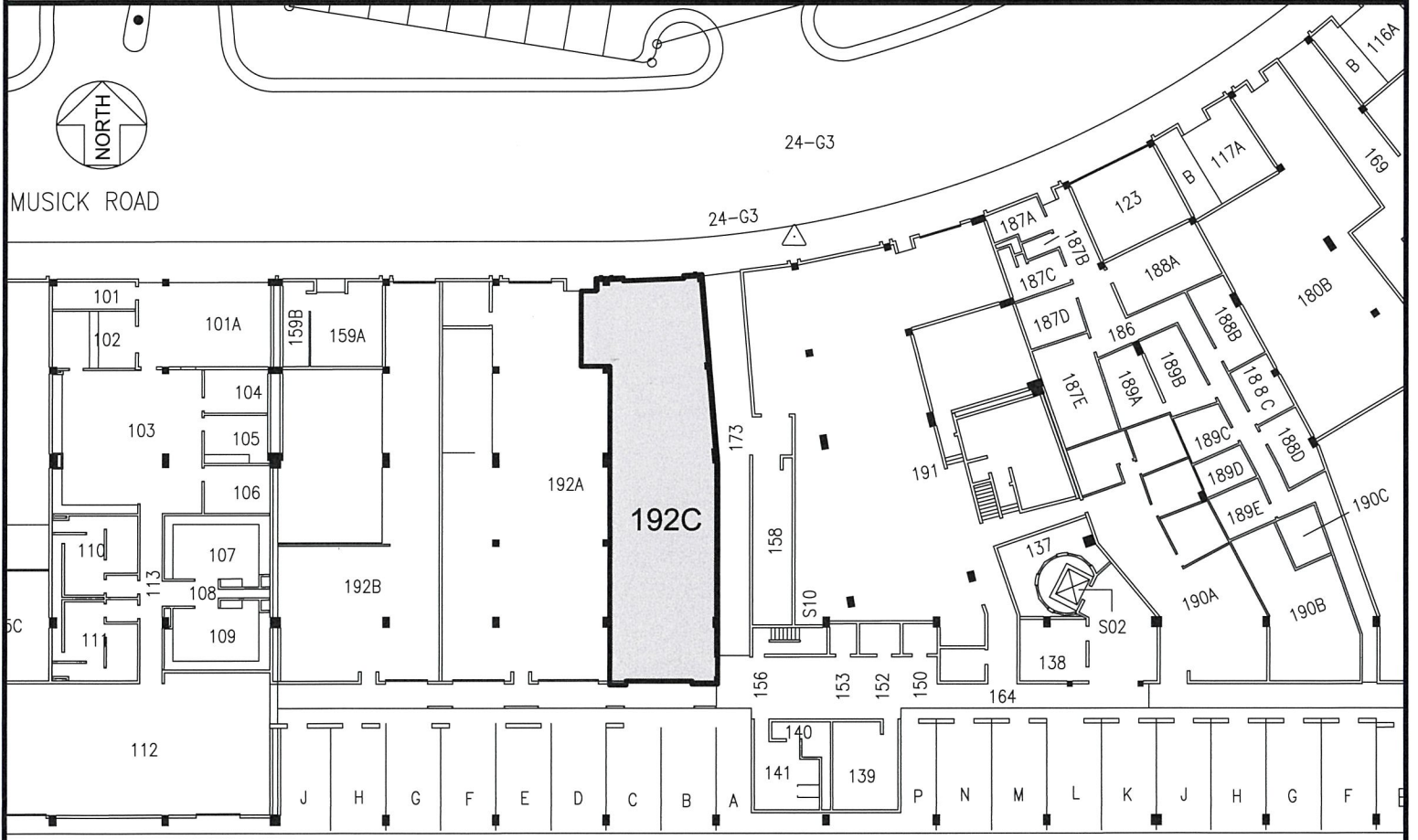

BLDG 360

EWA CONCOURSE

AREA/SPACE	SQ. FT.
360 192C	2,300

SCALE: 1" = 40'

RP-9566

DATE : MAY 2024

EXHIBIT: **B**



OSHKOSH AEROTECH, LLC

**BUILDING 360
EWA CONCOURSE
GROUND LEVEL**

360192C

DANIEL K. INOUE INTERNATIONAL AIRPORT

N:\AIRPORTS\HNL_HONOLULU\CAD\FM\HNL_360192C-01.DWG