



STATE OF HAWAII | KA MOKU'ĀINA 'O HAWAII'
DEPARTMENT OF TRANSPORTATION | KA 'OIHANA ALAKAU
869 PUNCHBOWL STREET
HONOLULU, HAWAII 96813-5097

June 28, 2024

EDWIN H. SNIFFEN
DIRECTOR
KA LUNA HO'OKELE

Deputy Directors
Nā Hope Luna Ho'okele
DREANALEE K. KALILI
TAMMY L. LEE
CURT T. OTAGURO
ROBIN K. SHISHIDO

IN REPLY REFER TO:

Board of Land and
Natural Resources
State of Hawaii
Honolulu, Hawaii

ISSUANCE OF A REVOCABLE PERMIT FOR TERMINAL
SPACE FOR EMPLOYEE LOCKERS TO SUPPORT SIGNATORY
AIRLINE CARRIER OPERATIONS
SOUTHWEST AIRLINES CO.
KAHULUI AIRPORT
TAX MAP KEY: (2) 3-8-001: PORTION OF 224

MAUI

LEGAL REFERENCE:

Section 171-55, Hawaii Revised Statutes (HRS), as amended.

APPLICANT:

Southwest Airlines Co. (SWA), whose business address is 2702 Love Field Drive,
Dallas, Texas 75235.

LOCATION AND TAX MAP KEY:

Portion of Kahului Airport (OGG), Kahului, Island of Maui, identified by
Tax Map Key: 2nd Division, 3-8-001: Portion of 224.

AREA:

Building/Room No. 341-105H, containing an area of approximately 9 square feet,
as shown and delineated on the attached Exhibit A.

ZONING:

State Land Use District:
County of Maui:

Urban
Airport

ITEM M-22

BLNR – ISSUANCE OF A REVOCABLE PERMIT FOR TERMINAL SPACE FOR
EMPLOYEE LOCKERS TO SUPORT SIGNATORY AIRLINE CARRIER
OPERATIONS, SOUTHWEST AIRLINES CO.

Page 2

LAND TITLE STATUS:

Section 5(a) lands of the Hawaii Admission Act: Non-Ceded
DHHL 30% entitlement lands pursuant to Hawaii Admission Act YES ___ NO X

CURRENT USE STATUS:

Land presently encumbered by Governor's Executive Order No. 2427, dated
February 12, 1969, setting aside 1,268.938 acres designated as Kahului Airport to be
under the control and management of the State of Hawaii, Department of Transportation
(HDOT) for Airport purposes.

CHARACTER OF USE:

SWA will use the space for employee lockers to support its signatory airline carrier
operations at OGG.

COMMENCEMENT DATE:

To be determined by the Director of Transportation at a later date.

MONTHLY RENTAL:

\$77.86 (based on a rate of \$103.81 per square foot, per annum, as determined
from the Airports Signatory Rates and Charges, Hawaii Airports System, effective
July 1, 2023).

SECURITY DEPOSIT:

\$233.58, or three times the monthly rental in effect.

DCCA VERIFICATION:

Place of business registration confirmed:	YES <u>X</u>	NO ___
Registered business name confirmed:	YES <u>X</u>	NO ___
Good standing confirmed:	YES <u>X</u>	NO ___

CHAPTER 343, HRS - ENVIRONMENTAL ASSESSMENT:

The HDOT has determined that the subject area and use is covered by the Kahului
Airport Terminal Complex Expansion Negative Declaration, published by the
Environmental Quality Commission (EQC) in the September 8, 1981, issue of the EQC
Bulletin. Accordingly, all relevant mitigation from the Negative Declaration and best
management practices will be implemented to address the minimum impacts of this
action.

BLNR – ISSUANCE OF A REVOCABLE PERMIT FOR TERMINAL SPACE FOR
EMPLOYEE LOCKERS TO SUPORT SIGNATORY AIRLINE CARRIER
OPERATIONS, SOUTHWEST AIRLINES CO.

Page 3

REMARKS:

In accordance with Section 171-55, HRS, relating to Permits, HDOT proposes to issue a month-to-month revocable permit to SWA for terminal space for employee lockers to support its signatory airline carrier operation at OGG.

RECOMMENDATION:

Based on this submittal, and testimony and facts presented, the HDOT recommends the Board finds that approving the issuance of a month-to-month Revocable Permit to SWA, including its conditions and rent, will serve the best interests of the State.

Respectfully submitted,



EDWIN H. SNIFFEN
Director of Transportation

APPROVED FOR SUBMITTAL:



DAWN N. S. CHANG
Chairperson
Board of Land and Natural Resources

Attachment

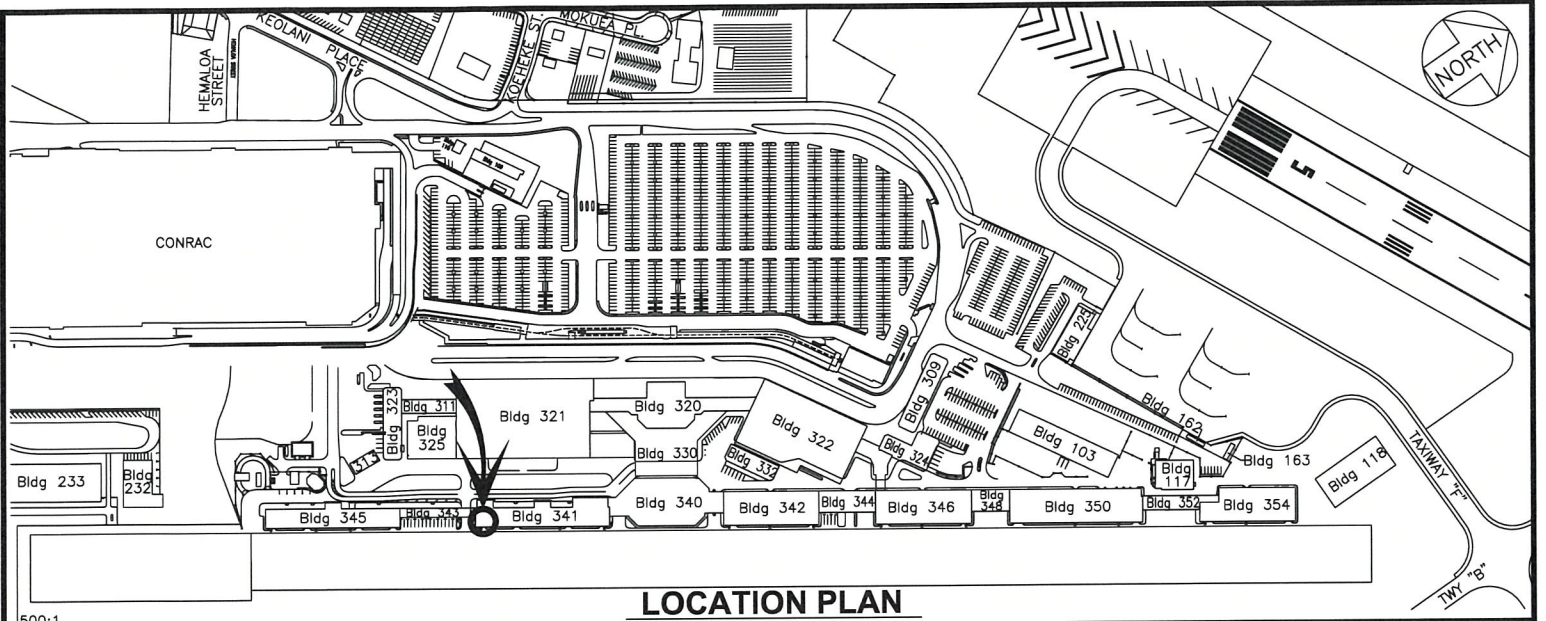

LOCATION PLAN

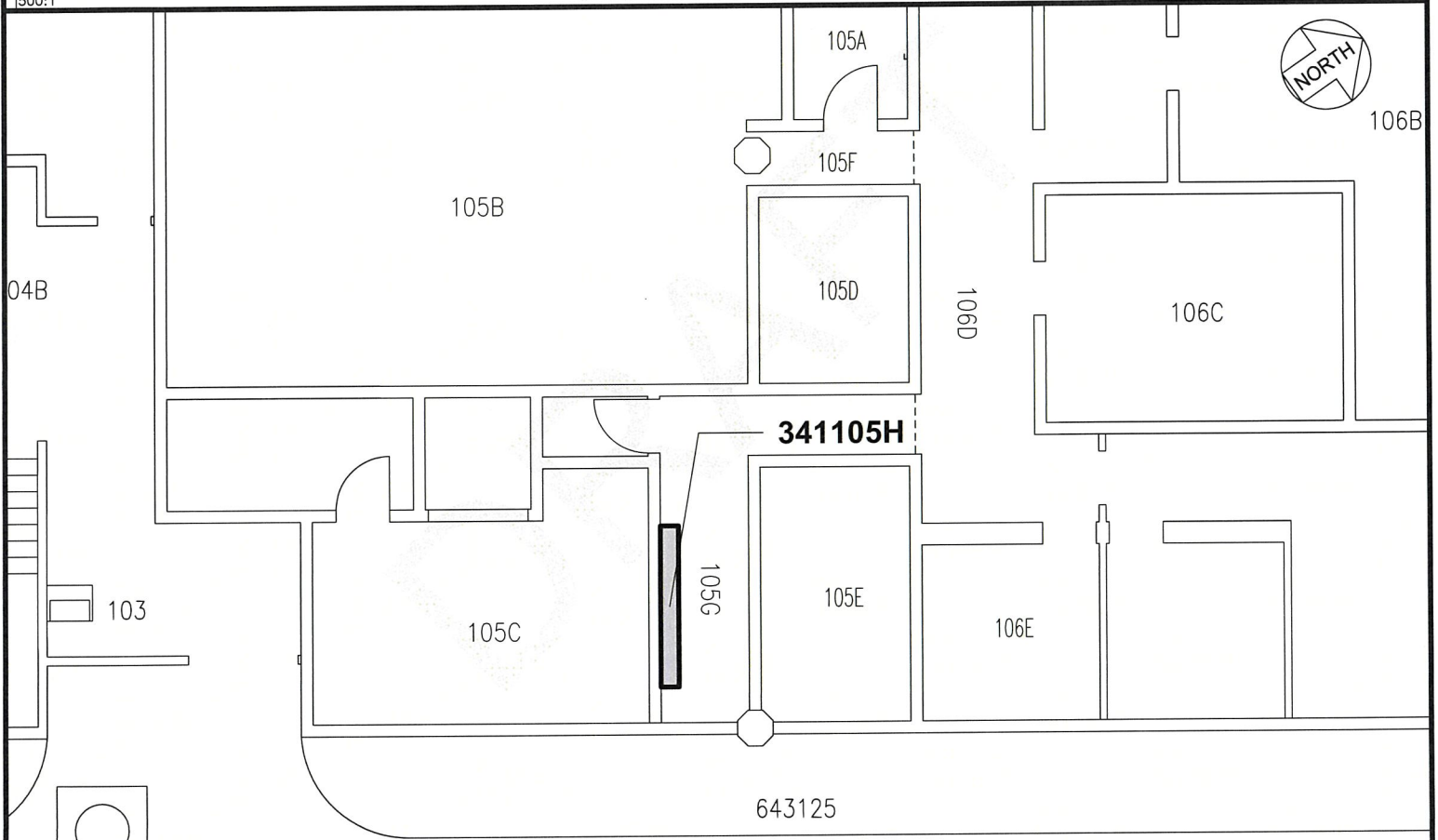

341105H

BLDG/ROOM	SQ. FT.
341 105H	9

SCALE: 1" = 10'

DRAFT	DATE : APRIL 2024	EXHIBIT: A	
 AIRPORTS	SOUTHWEST AIRLINES CO.	BLDG 341 HOLDING ROOMS B GROUND LEVEL	341105H

KAHULUI AIRPORT

DRAWING: 341105H-01 DRAFT.DWG