



STATE OF HAWAII | KA MOKU'ĀINA 'O HAWAII'
DEPARTMENT OF TRANSPORTATION | KA 'OIHANA ALAKAU
869 PUNCHBOWL STREET
HONOLULU, HAWAII 96813-5097

IN REPLY REFER TO:

June 28, 2024

Board of Land and
Natural Resources
State of Hawaii
Honolulu, Hawaii

ISSUANCE OF A REVOCABLE PERMIT FOR
STAGING AND PARKING OF SCHOOL BUSES
GROUND TRANSPORT, INC.
DANIEL K. INOUE INTERNATIONAL AIRPORT
TAX MAP KEY: (1) 1-1-004: 007 AND (1) 1-1-004: 087

OAHU

APPLICANT/LESSEE:

Ground Transport, Inc., whose business address is P. O. Box 29540,
Honolulu, Hawaii 96820.

LEGAL REFERENCE:

Section 171-55, Hawaii Revised Statutes (HRS), as amended.

LOCATION AND TAX MAP KEY:

2855 and 2865 Ualena Street, portion of Daniel K. Inouye International Airport (Airport),
Island of Oahu, State of Hawaii, identified by Tax Map Key: 1st Division, 1-1-004: 007
and 1-1-004: 087.

AREA:

Area/Space No. 005-125, containing an area of approximately 19,025 square feet;
Area/Space No. EAS-125, containing an area of approximately 2,318 square feet;
Area/Space No. 005-126, containing an area of approximately 20,367 square feet; and
Area/Space No. EAS-126, containing an area of approximately 2,168 square feet,
as shown and delineated on the attached map labeled Exhibit A.

ITEM M-3

BLNR – ISSUANCE OF A REVOCABLE PERMIT FOR STAGING AND PARKING OF SCHOOL BUSES, GROUND TRANSPORT, INC.

Page 2

ZONING:

State Land Use District: Urban
City and County of Honolulu: I-2 (Industrial)

LAND TITLE STATUS:

Non-ceded – Direct purchase from private landowner.

DHHL 30% entitlement lands pursuant to the Hawaii State Constitution: YES ___ NO X

CURRENT USE STATUS:

Land presently encumbered by Governor’s Executive Order No. 3894, setting aside a portion of the Airport under the control and management of the State of Hawaii, Department of Transportation (HDOT), for Airport purposes.

The HDOT acquired the subject property together with most of the remaining properties (except one) along the ocean (makai) side of Ualena Street, between Lagoon Drive and Paiea Street, in the mid 1990’s from Loyalty Enterprises, Ltd.

CHARACTER OF USE:

Ground Transport, Inc. will use the unpaved, improved land for staging and parking of school buses for its school bus transportation operations.

COMMENCEMENT DATE:

Upon execution of the revocable permit.

MONTHLY RENTAL:

\$27,082.00 (based on a rate of \$8.25 per square foot per annum for unpaved, improved land, as determined from the Schedule of Rates and Charges established by appraisal of Airports property statewide).

SECURITY DEPOSIT:

\$108,353.00, or three times the monthly rent in effect.

DCCA VERIFICATION:

Place of business registration confirmed: YES X NO ___
Registered business name confirmed: YES X NO ___
Good standing confirmed: YES X NO ___

CHAPTER 343, HRS - ENVIRONMENTAL ASSESSMENT:

The HDOT has determined that the subject land areas are covered by the Honolulu International Airport Ualena Street Industrial Lots Acquisition and Chevron Property Acquisition Environmental Assessment (EA) dated October 1990. The EA is published by the Office of Environmental Quality Control (OEQC) in the November 8, 1990, issue of the Environmental Notice. Accordingly, the actions have been determined to have little or no impact upon the environment.

REMARKS:

In accordance with Section 171-55, HRS, relating to Permits, the HDOT proposes to issue a month-to-month revocable permit to Ground Transport, Inc. for staging and parking of school buses for its school bus transportation operations.

RECOMMENDATION:

Based on this submittal, and testimony and facts presented, the HDOT recommends the Board finds that approving the issuance of a month-to-month Revocable Permit to Ground Transport, Inc., including its conditions and rent, will serve the best interests of the State.

Respectfully submitted,



EDWIN H. SNIFFEN
Director of Transportation

APPROVED FOR SUBMITTAL:



DAWN N. S. CHANG
Chairperson
Board of Land and Natural Resources

Attachment

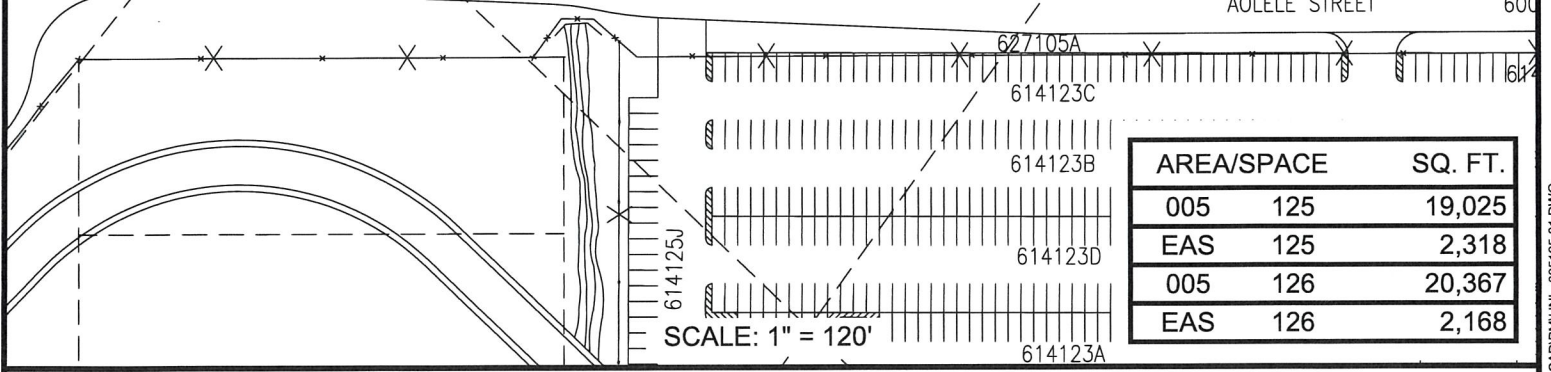
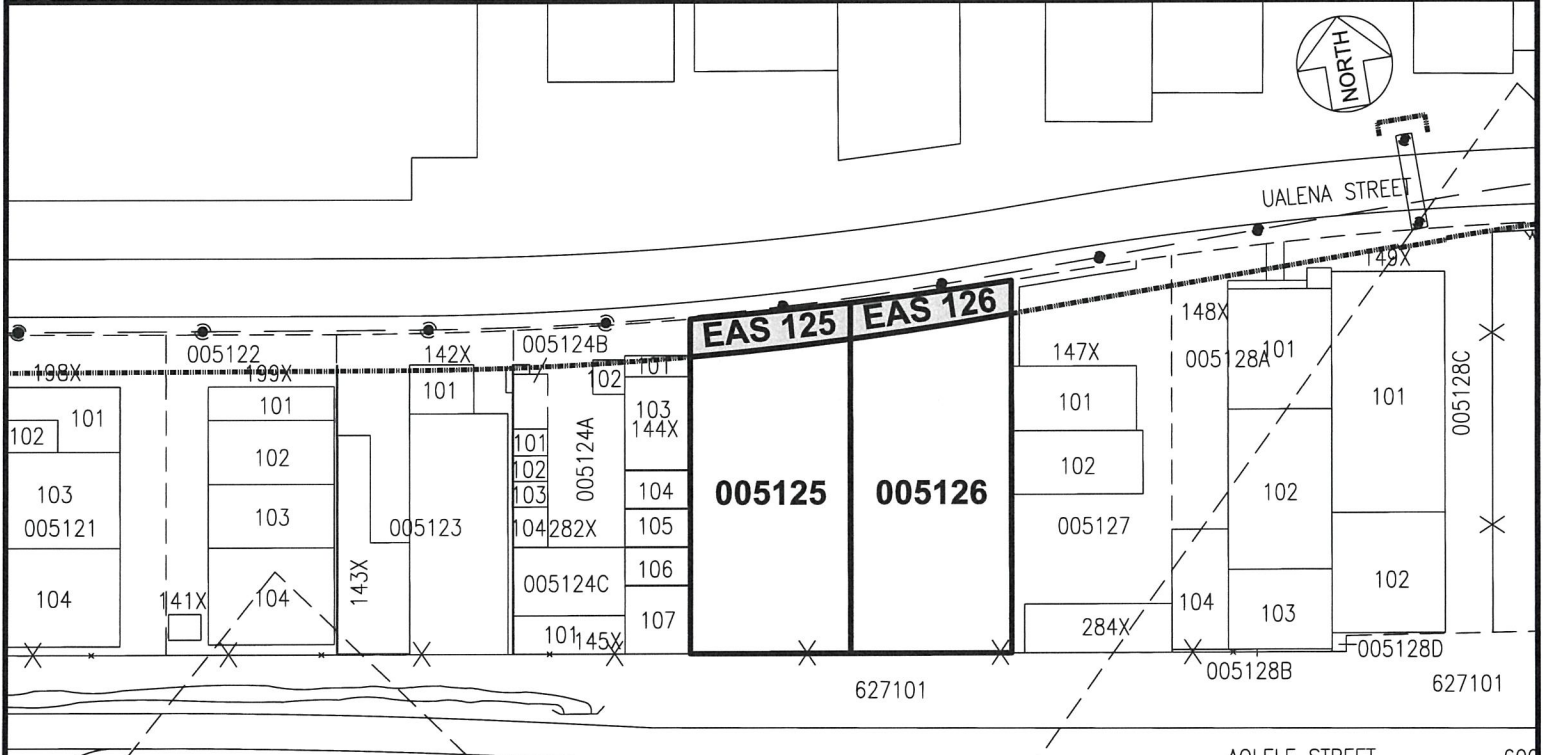
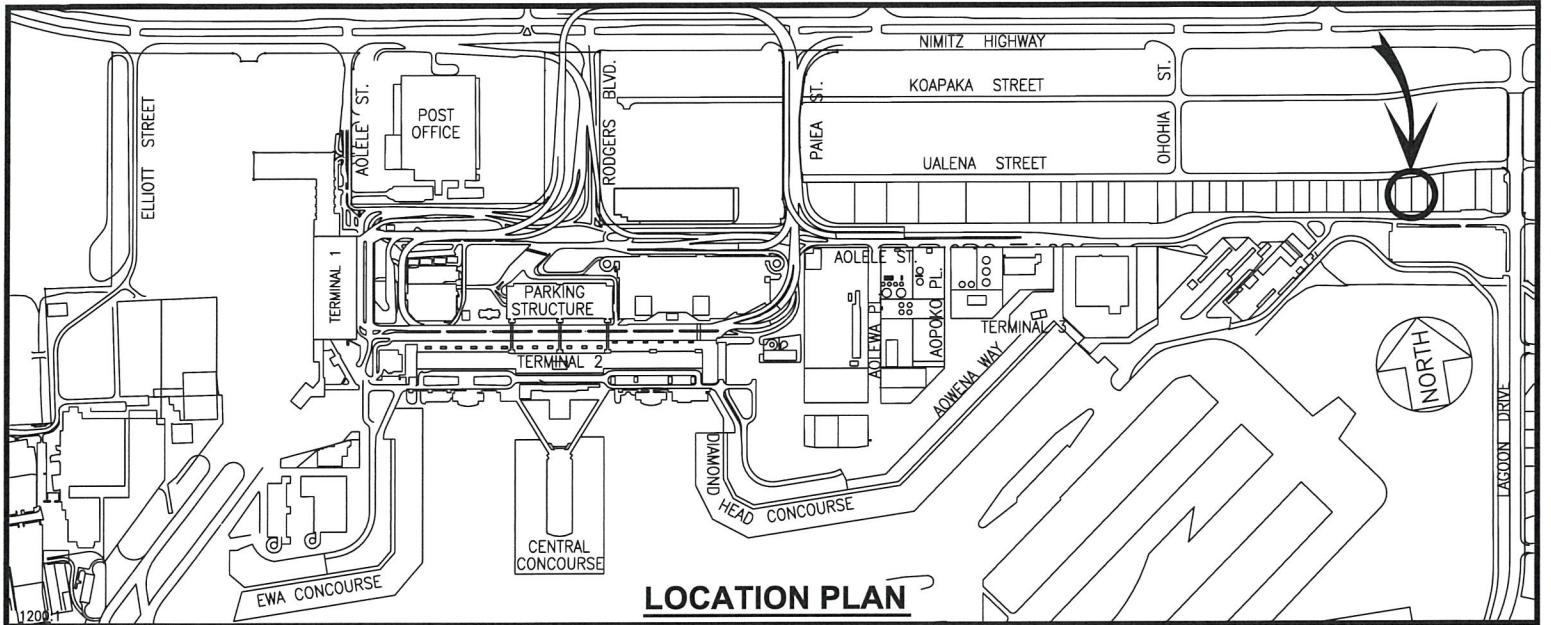

AREA/SPACE	SQ. FT.
005 125	19,025
EAS 125	2,318
005 126	20,367
EAS 126	2,168

SCALE: 1" = 120'

RP-9568

DATE : MAY 2024

EXHIBIT: **A**



AIRPORTS

GROUND TRANSPORT, INC.

2865 UALENA STREET
2855 UALENA STREET

005125-126
EAS125-126

DANIEL K. INOUE INTERNATIONAL AIRPORT

N:\AIRPORTS\HNL_HONOLULU\CAD\PA\HNL_005125-01.DWG