



STATE OF HAWAI'I | KA MOKU'ĀINA 'O HAWAI'I
DEPARTMENT OF TRANSPORTATION | KA 'OIHANA ALAKAU
869 PUNCHBOWL STREET
HONOLULU, HAWAII 96813-5097

IN REPLY REFER TO:

June 28, 2024

Board of Land and
Natural Resources
State of Hawaii
Honolulu, Hawaii

ISSUANCE OF A REVOCABLE PERMIT FOR
PASSENGER CHECK-IN COUNTERS
HAWAIIAN AIRLINES, INC.
DANIEL K. INOUE INTERNATIONAL AIRPORT
TAX MAP KEY: (1) 1-1-003: PORTION OF 058

OAHU

APPLICANT:

Hawaiian Airlines, Inc., whose mailing address is 3375 Koapaka Street, Suite G350,
Honolulu, Hawaii 96819.

LEGAL REFERENCE:

Hawaii Revised Statutes (HRS), Section 171-55, as amended.

LOCATION AND TAX MAP KEY:

A portion of Daniel K. Inouye International Airport (Airport), Island of Oahu, State of
Hawaii, identified by Tax Map Key: 1st Division, 1-1-003: Portion of 058.

AREA:

Building/Room No. 344-221C, containing an area of approximately 496 square feet,
as shown and delineated on the attached map labeled Exhibit A.

ZONING:

State Land Use District: Urban
City and County of Honolulu LUO: Industrial (I-2)

ITEM M-5

BLNR – ISSUANCE OF A REVOCABLE PERMIT FOR PASSENGER CHECK-IN
COUNTERS, HAWAIIAN AIRLINES, INC.
PAGE 2

LAND TITLE STATUS:

Non-ceded - Section 5(a) lands of the Hawaii Admission Act
DHHL 30% entitlement lands pursuant to Hawaii Admission Act YES ___ NO X

CURRENT USE STATUS:

Land presently encumbered by Governor's Executive Order No. 3201, dated June 8, 1983, setting aside 3,152.177 acres designated as the Airport under the control and management of the State of Hawaii, Department of Transportation (HDOT), for Airport Purposes.

CHARACTER OF USE:

Hawaiian Airlines, Inc. will use the space for a passenger check-in counter, as part of their Signatory Airline Carrier Operations at Daniel K. Inouye International Airport.

COMMENCEMENT DATE:

To be determined by the Director of Transportation at a later date.

MONTHLY RENTAL:

\$5,174.11 as determined from the HDOT Signatory Carrier Rates and Charges, Hawaii Airports System, effective July 1, 2023.

SECURITY DEPOSIT:

\$15,522.33 or three times the monthly rental in effect.

DCCA VERIFICATION:

Place of business registration confirmed:	YES <u>X</u>	NO ___
Registered business name confirmed:	YES <u>X</u>	NO ___
Good standing confirmed:	YES <u>X</u>	NO ___

CHAPTER 343, HRS - ENVIRONMENTAL ASSESSMENT:

The environmental impacts of the proposed action to the subject land area is covered by the Honolulu International Airport, Airport Modernization Program Environmental Assessment (EA), State Project No. AO1030-13. The EA is a joint State and Federal document dated January 2013, and published in the February 8, 2013 issue of the OEQC Bulletin. Accordingly, the actions have been determined to have little or no impact upon the environment.

BLNR – ISSUANCE OF A REVOCABLE PERMIT FOR PASSENGER CHECK-IN
COUNTERS, HAWAIIAN AIRLINES, INC.
PAGE 3

REMARKS:

In accordance with HRS, relating to Permits, the HDOT proposes to issue a month-to-month Revocable Permit to Hawaiian Airlines, Inc., for a passenger check-in counter as part of its Signatory Commercial Air Carrier Operations, situated at the Airport.

RECOMMENDATION:

Based on this submittal, and testimony and facts presented, the HDOT recommends the Board finds that approving the issuance of a month-to-month Revocable Permit to Hawaiian Airlines, Inc., including its conditions and rent, will serve the best interests of the State.

Respectfully submitted,



EDWIN H. SNIFFEN
Director of Transportation

APPROVED FOR SUBMITTAL:



DAWN N. S. CHANG
Chairperson
Board of Land and Natural Resources

Attachment

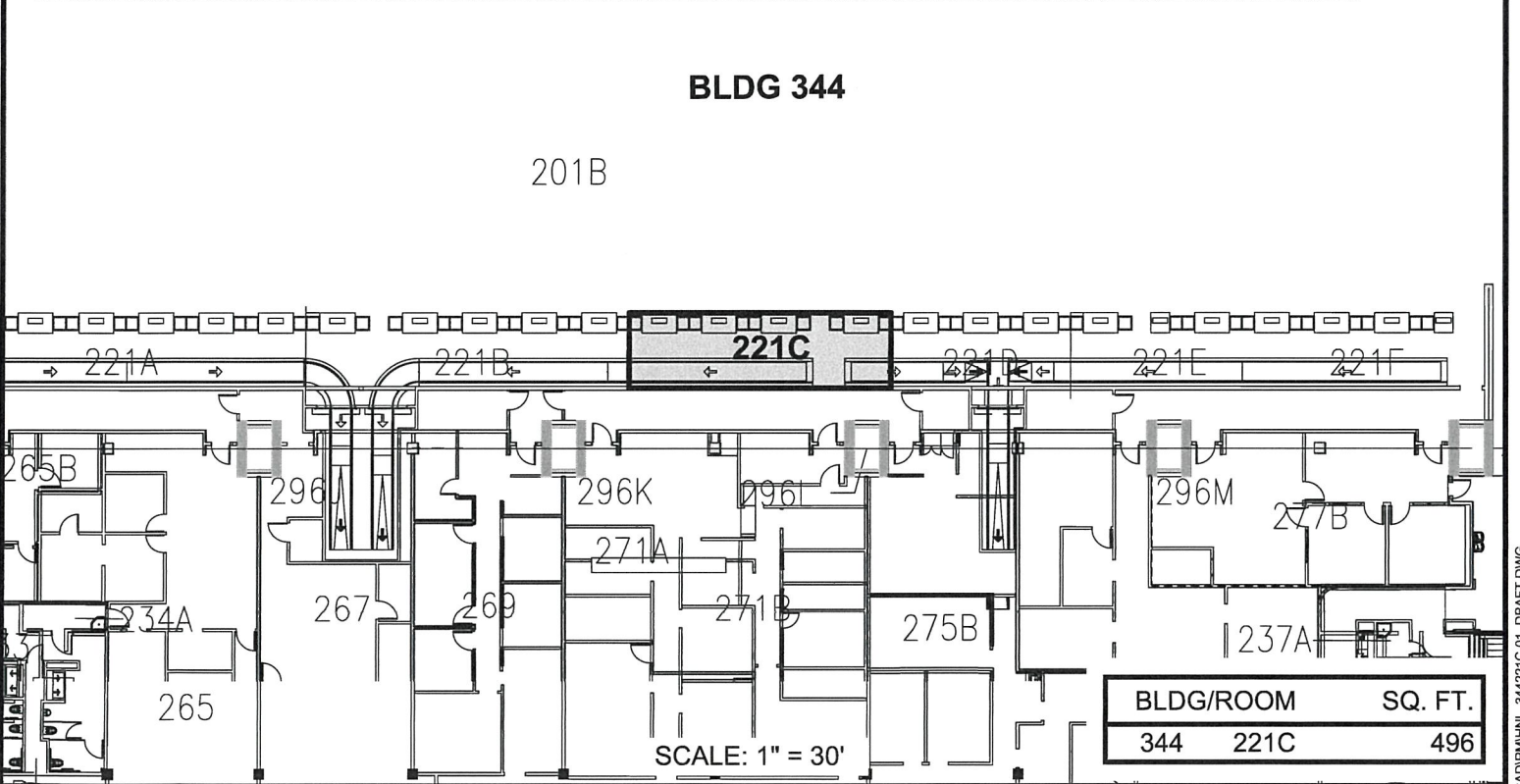
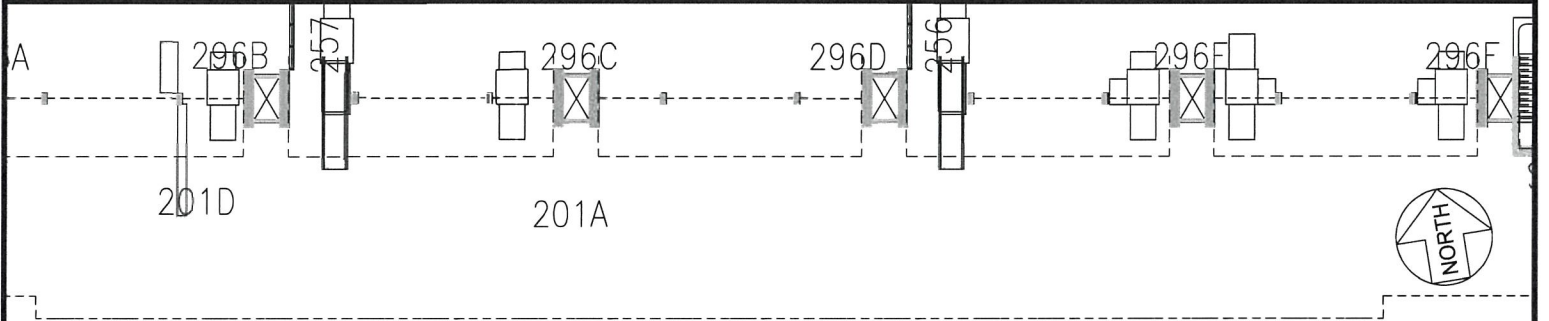
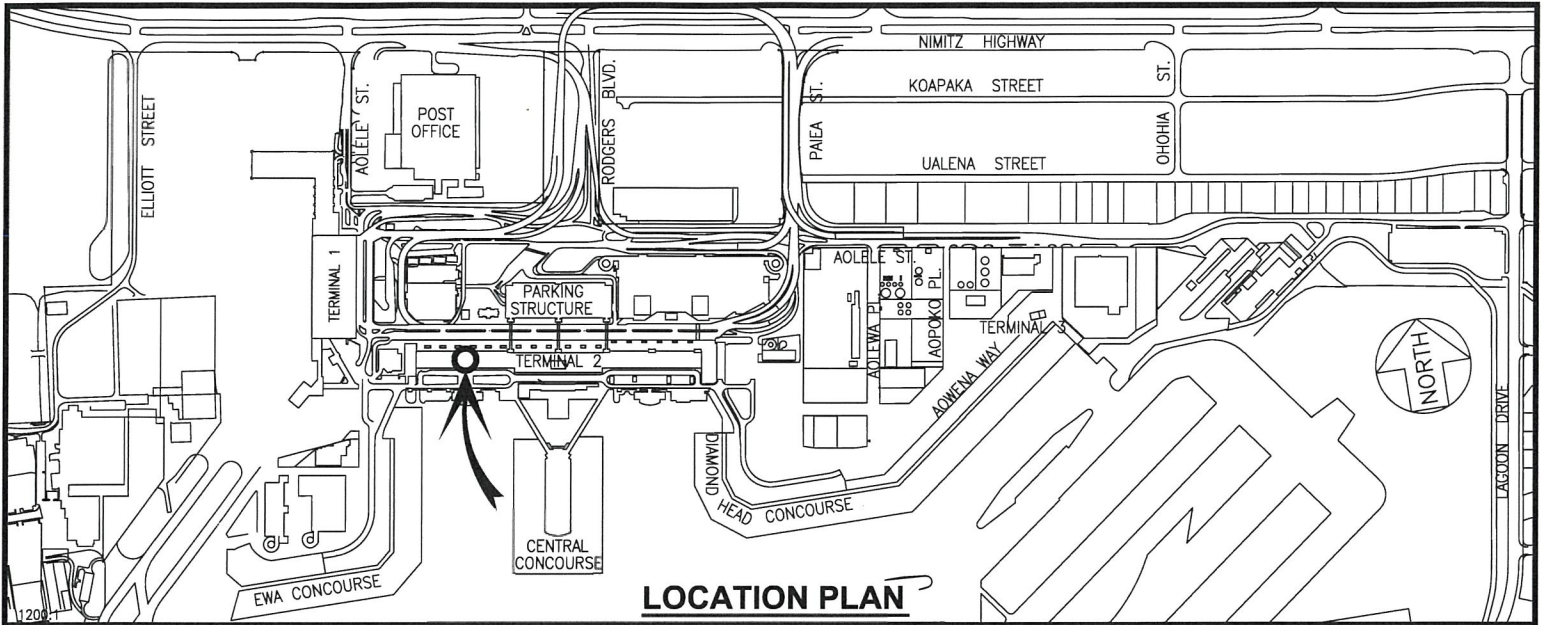

RP-9569

DATE : MAY 2024

EXHIBIT: **A**



AIRPORTS

HAWAIIAN AIRLINES, INC.

**BUILDING 344
EWA DOMESTIC EXTN.
SECOND LEVEL**

344221C