



STATE OF HAWAII | KA MOKU'ĀINA 'O HAWAI'I
DEPARTMENT OF TRANSPORTATION | KA 'OIHANA ALAKAU
869 PUNCHBOWL STREET
HONOLULU, HAWAII 96813-5097

June 28, 2024

Board of Land and
Natural Resources
State of Hawaii
Honolulu, Hawaii

ISSUANCE OF A REVOCABLE PERMIT FOR AN OFFICE,
STORAGE SPACE AND VEHICLE PARKING
OSHKOSH AEROTECH, LLC
DANIEL K. INOUE INTERNATIONAL AIRPORT
TAX MAP KEY: (1) 1-1-003: 050

OAHU

APPLICANT:

Oshkosh Aerotech, LLC, whose business address is 758 Kapahulu Avenue,
Suite 100-1133, Honolulu, Hawaii 96816.

LEGAL REFERENCE:

Hawaii Revised Statutes (HRS), Section 171-55, as amended.

LOCATION AND TAX MAP KEY:

A portion of Daniel K. Inouye International Airport (Airport), Island of Oahu, State of
Hawaii, identified by Tax Map Key: 1st Division, 1-1-003: 050.

AREA:

Building/Room No. 350-121B, containing an area of approximately 2,375 square feet;
Area/Space No. 612-116L, containing an area of approximately 124 square feet;
Area/Space No. 612-116M, containing an area of approximately 165 square feet;
Area/Space No. 612-116N, containing an area of approximately 144 square feet; and
Area/Space No. 612-116P, containing an area of approximately 132 square feet,
as shown and delineated on the attached map labeled Exhibit A.

ITEM M-9

ZONING:

State Land Use District: Urban
City and County of Honolulu LUO: Industrial (I-2)

LAND TITLE STATUS:

Section 5(a) lands of the Hawaii Admissions Act: Non-ceded
DHHL 30% entitlement lands pursuant to Hawaii Admission Act YES ___ NO X

CURRENT USE STATUS:

Land presently encumbered by Governor’s Executive Order No. 3201, dated June 8, 1983, setting aside 3,152.177 acres designated as the Airport under the control and management of the State of Hawaii, Department of Transportation (HDOT), for Airport purposes.

CHARACTER OF USE:

Oshkosh Aerotech, LLC will use the spaces for an office, storage of parts and vehicle parking in support of their contract to service and maintain the Mauka Terminal Baggage Handling System.

COMMENCEMENT DATE:

Upon execution of the revocable permit.

MONTHLY RENTAL:

\$5,873.60 (as determined from the HDOT schedule of rates and charges established by appraisal of Airports property statewide plus \$926.25 for utilities and \$593.75 for air conditioning).

SECURITY DEPOSIT:

\$17,620.80, or three times the monthly rental in effect.

DCCA VERIFICATION:

Place of business registration confirmed:	YES <u>X</u>	NO ___
Registered business name confirmed:	YES <u>X</u>	NO ___
Good standing confirmed:	YES <u>X</u>	NO ___

CHAPTER 343, HRS - ENVIRONMENTAL ASSESSMENT:

The environmental impacts of the proposed action to the subject land area are covered by the Honolulu International Airport Master Plan Update and Noise Compatibility Program Environmental Assessment (EA), State Project No. AO1011-03. The EA is a joint State and Federal document, dated September 1989 and published in the October 23, 1989 issue of the OEQC Bulletin. Accordingly, relevant mitigation from the EA and HDOT environmental best management practice will address minimal impacts from this action.

REMARKS:

In accordance with HRS, relating to Permits, HDOT proposes to issue a month-to-month revocable permit to Oshkosh Aerotech, LLC for an office, storage space and vehicle parking in support of their contract to service and maintain the Mauka Terminal Baggage Handling System at the Airport.

RECOMMENDATION:

Based on this submittal, and testimony and facts presented, HDOT recommends the Board finds that approving the issuance of a month-to-month Revocable Permit to Oshkosh Aerotech, LLC, including its conditions and rent, will serve the best interests of the State.

Respectfully submitted,



EDWIN H. SNIFFEN
Director of Transportation

APPROVED FOR SUBMITTAL:



DAWN N. S. CHANG
Chairperson
Board of Land and Natural Resources

Attachment

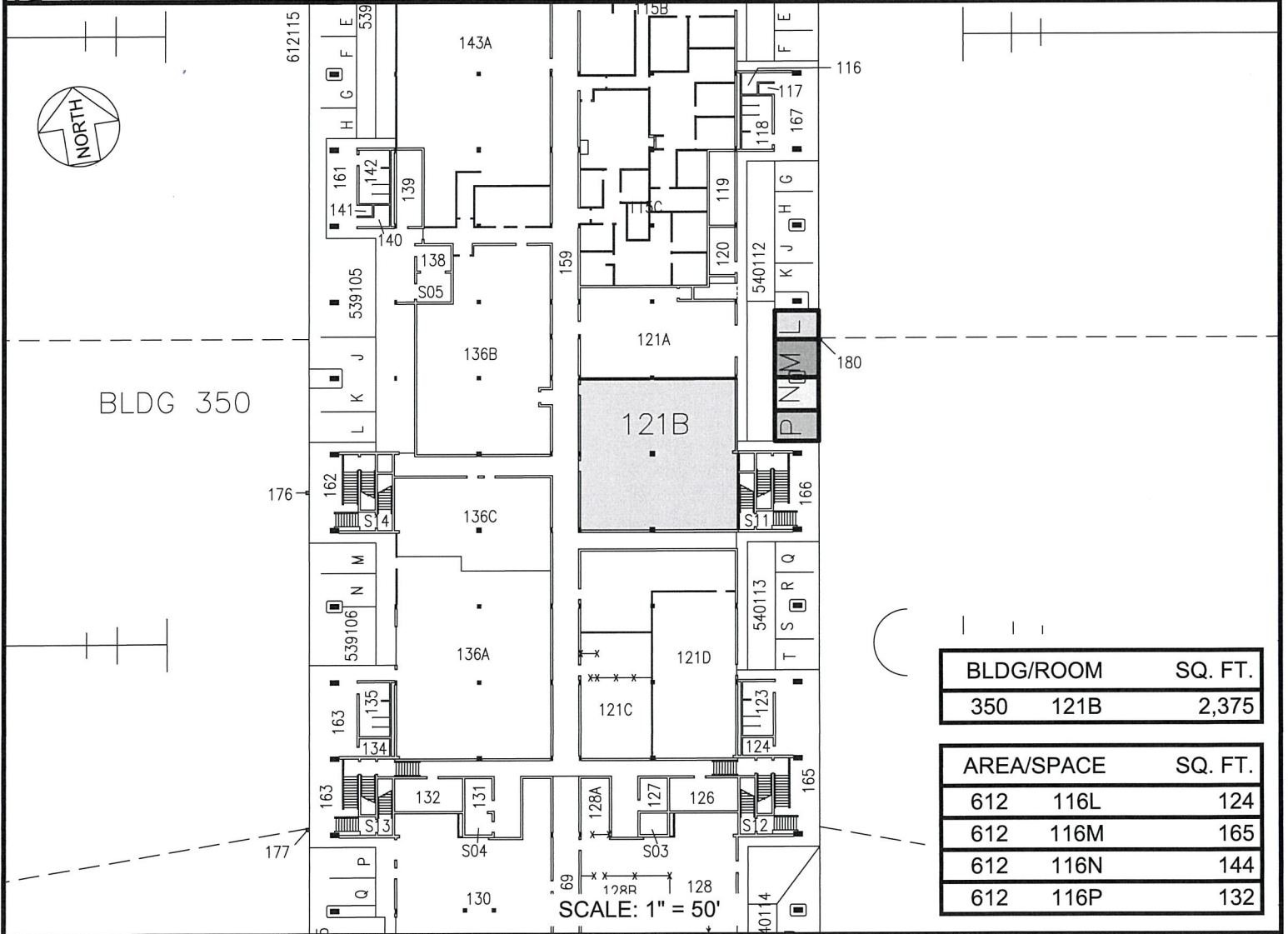
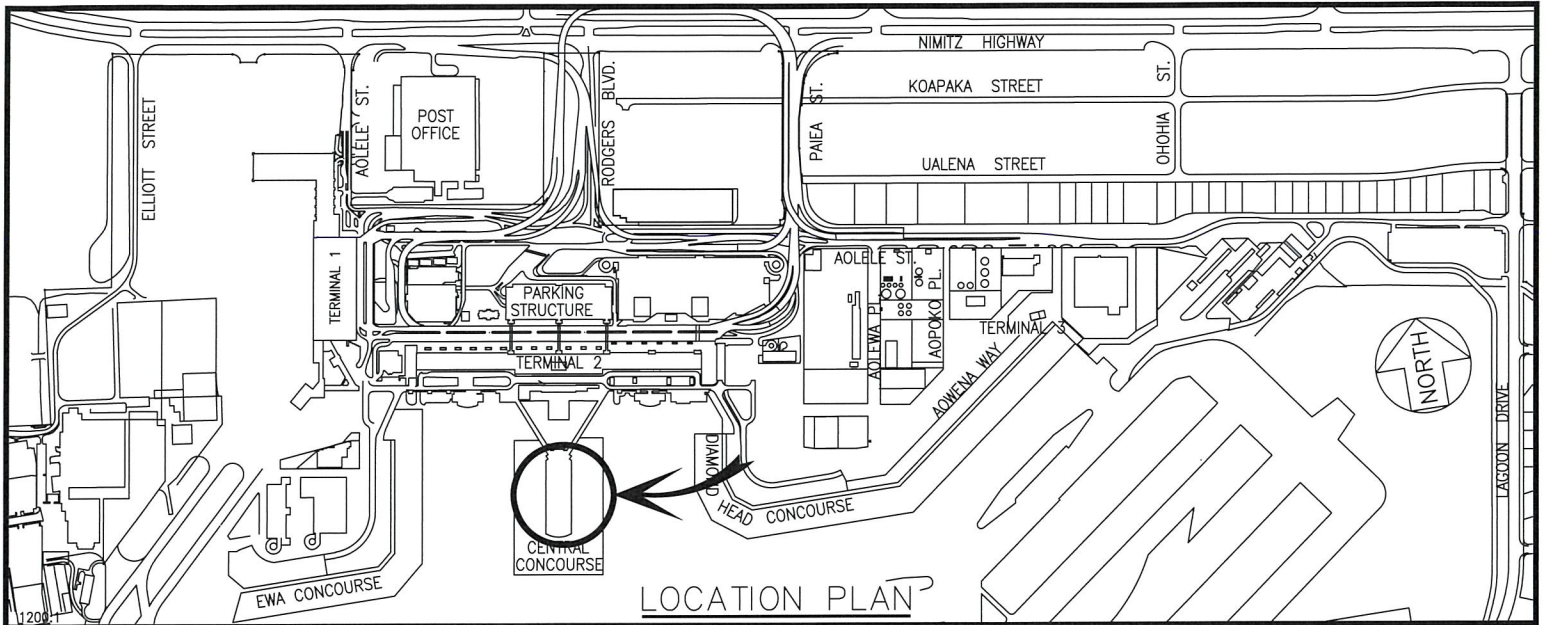

BLDG/ROOM	SQ. FT.
350 121B	2,375

AREA/SPACE	SQ. FT.
612 116L	124
612 116M	165
612 116N	144
612 116P	132

SCALE: 1" = 50'

RP-9565

DATE : MAY 2024

EXHIBIT: **A**



OSHKOSH AEROTECH, LLC

BUILDING 350
CENTRAL CONCOURSE
GROUND LEVEL

350121B
612116L-P

DANIEL K. INOUE INTERNATIONAL AIRPORT

N:\AIRPORTS\HNL_HONOLULU\CAD\PM\HNL_350121B-01.DWG