

STATE OF HAWAII
DEPARTMENT OF LAND AND NATURAL RESOURCES
Land Division
Honolulu, Hawaii 96813

August 23, 2024

Board of Land and Natural Resources
State of Hawaii
Honolulu, Hawaii

OAHU

(1) Consent to Assignment of Grant of Non-Exclusive Easement No. S-5629 from Carl Phillip Mudrick, Personal Representative of The Estate of Miles F. Shiratori, Deceased, Assignor, to FC2, Inc., Assignee; (2) Amend the Easement Conditions regarding Consent to Assignment and Insurance Provision; Kaneohe, Koolaupoko, Oahu, Tax Map Key: (1) 4-4-022: seaward of 006.

APPLICANT:

FC2, Inc, a Nevada corporation.

LEGAL REFERENCE:

Section 171-6, 36(a)(5), Hawaii Revised Statutes, as amended.

LOCATION:

Portion of Government lands situated at Kaneohe, Koolaupoko, Oahu, identified by Tax Map Key: (1) 4-4-022: seaward of 006, as shown on **Exhibit A1** and **A2**.

AREA:

153 square feet, more or less.

TRUST LAND STATUS:

Section 5(b) lands of the Hawaii Admission Act
DHHL 30% entitlement lands pursuant to the Hawaii State Constitution: No

CHARACTER OF USE:

Right, privilege and authority to use, maintain, and repair boat ramp.

TERM OF EASEMENT:

Fifty (55) years, commencing on April 1, 2005 and expiring on March 31, 2060.

RENTAL:

A one-time payment (\$1,800) was paid when the easement was issued.

CONSIDERATION:

Not applicable as the subject request was triggered by the sale of the abutting private property and there is no information on consideration allocated to the assignment of the subject easement.

CHAPTER 343 – ENVIRONMENTAL ASSESSMENT:

In accordance with Hawaii Administrative Rules (HAR) § 11-200.1-15 and the Exemption List for the Department of Land and Natural Resources reviewed and concurred on by the Environmental Council on November 10, 2020 the subject request is exempt from the preparation of an environmental assessment pursuant to General Exemption Type 1 that states, “Operations, repairs or maintenance of existing structures, facilities, equipment, or topographical features, involving minor expansion or minor change of use beyond that previously existing” and Part 1, Item 39 that states, “Creation or termination of easement, covenants, or other rights in structures or land.” The proposed action is a de minimis action that will probably have minimal or no significant effect on the environment and should be declared exempt from the preparation of an environmental assessment and the requirements of § 11-200.1-17 HAR.

DCCA VERIFICATION:

Not applicable. Applicant does not conduct any business activities in the State.

REMARKS:

At its meeting of July 27, 2001, under agenda item D-8, the Board approved the issuance of Grant of Non-Exclusive Easement S-5629 (“GL5629”) for boat ramp purposes to Leonard A. Jaffe and Miles F. Shiratori, as joint tenants, who were the owners of the abutting private property further identified as tax map key (1) 4-6-022:006 (Parcel 6).

Since GL5629 issued on April 1, 2005, there were changes in the ownership of Parcel 6 as shown below:

1. January 25, 2012 – Leonard A. Jaffe and Miles F. Shiratori, Grantor; Leonard A Jaffe, Trustee of Leonard A. Jaffe Revocable Trust dated December 9, 1992, and Miles F. Shiratori, Trustee of Miles F. Shiratori Revocable Trust dated December 9, 1992 (Tenants in Common), Grantees;
2. July 19, 2013 – Correction deed substituted the date of Leonard A. Jaffe Revocable Trust in January 25, 2012 deed by March 6, 1992;
3. January 25, 2020 - Leonard A. Jaffe passed.

4. April 17, 2020 – Miles F. Shiratori passed.
5. June 10, 2021 – Carl Phillip Mudrick Successor Trustee of Leonard A. Jaffe Revocable Trust dated March 6, 1992, Grantor; Carl Phillip Mudrick, Successor Trustee of Miles F. Shiratori Revocable Trust dated December 9, 1992, Grantee; and
6. June 10, 2021 – Carl Phillip Mudrick, Successor Trustee of Miles F. Shiratori Revocable Trust dated December 9, 1992, Grantor; FC2, Inc. [the current applicant], Grantee.

Assignment:

The conveyances described above dealt with the private property (Parcel 6) only and did not purport to transfer any interest in GL5629. Accordingly, the interest in GL5629 passed to Miles F. Shiratori, the last surviving grantee under the joint tenancy, until his passing in April 2020. Upon Mr. Shiratori's death, GL5629 became an asset of his probate estate. On July 24, 2024, Carl Phillip Mudrick, the Personal Representative of the Estate of Miles F. Shiratori, Deceased, transferred the interest in GL5629 from the estate to the current owner of Parcel 6, FC2, Inc.

Pursuant to condition 5 in GL5629, which requires the Board's written consent to the assignment, staff brings the request to the Board for consent on today's agenda.

Amendment:

The current policy for similar shoreline easements is to make the easement run with the property served by the easement. Therefore, staff recommends the Board authorize the amendment of the easement to allow it to "run with the land" that it serves, specifically the private property identified as tax map key (1) 4-4-022:006.

Insurance:

Paragraph 11 of GL5629 requires the grantee to procure liability and property damage insurance in an amount of at least \$300,000 and \$500,000 respectively. The current insurance requirement for similar shoreline easements is \$1 million per occurrence and \$2 million aggregate. Staff recommends the Board authorize the amendment of the easement by updating the insurance provision with the current requirements.

Staff did not solicit comments from other agencies on the subject request as there is no change in the existing use. The Applicant has not had a lease, permit, easement or other disposition of State lands terminated within the last five years due to non-compliance with such terms and conditions.

RECOMMENDATION: That the Board:

- A. Declare that, after considering the potential effects of the proposed disposition as provided by Chapter 343, Hawaii Revised Statutes and Chapter 11-200.1-15, Hawaii Administrative Rules, this project will probably have minimal or no

significant effect on the environment and is therefore exempt from the preparation of an environmental assessment as a de minimis activity.

- B. Consent to the assignment of Grant of Non-Exclusive Easement S-5629 from Carl Phillip Mudrick, Personal Representative of the Estate of Miles F. Shiratori, Deceased, Assignor, to FC2, Inc., Assignee, subject to the following:
1. The standard terms and conditions of the most current consent to assignment form, as may be amended from time to time;
 2. Review and approval by the Department of the Attorney General; and
 3. Such other terms and conditions as may be prescribed by the Chairperson to best serve the interests of the State.
- C. Authorize the amendment of Grant of Non-Exclusive Easement S-5629 under the terms and conditions cited above, which are by this reference incorporated herein and further subject to the following:
1. Replace paragraph 5 of the subject easement with the following: “The easement shall run with the land and shall inure to the benefit of the real property described as Tax Map Key: (1) 4-4-022:006, provided however: (1) it is specifically understood and agreed that the easement shall immediately cease to run with the land upon the expiration or other termination or abandonment of the easement; and (2) if and when the easement is sold, assigned, conveyed, or otherwise transferred, the Grantee shall notify the Grantor of such transaction in writing, and shall notify Grantee’s successors or assigns of the insurance requirement in writing, separate and apart from the easement document”;
 2. Replace paragraph 11 of the subject easement with the current insurance provision;
 3. Review and approval by the Department of the Attorney General; and
 4. Such other terms and conditions as may be prescribed by the Chairperson to best serve the interests of the State.

Respectfully Submitted,

Barry Cheung

Barry Cheung
District Land Agent

APPROVED FOR SUBMITTAL:



Dawn N. S. Chang, Chairperson *KEM*

RT



TMK: (1) 4-4-022: seaward of 006

Exhibit A1

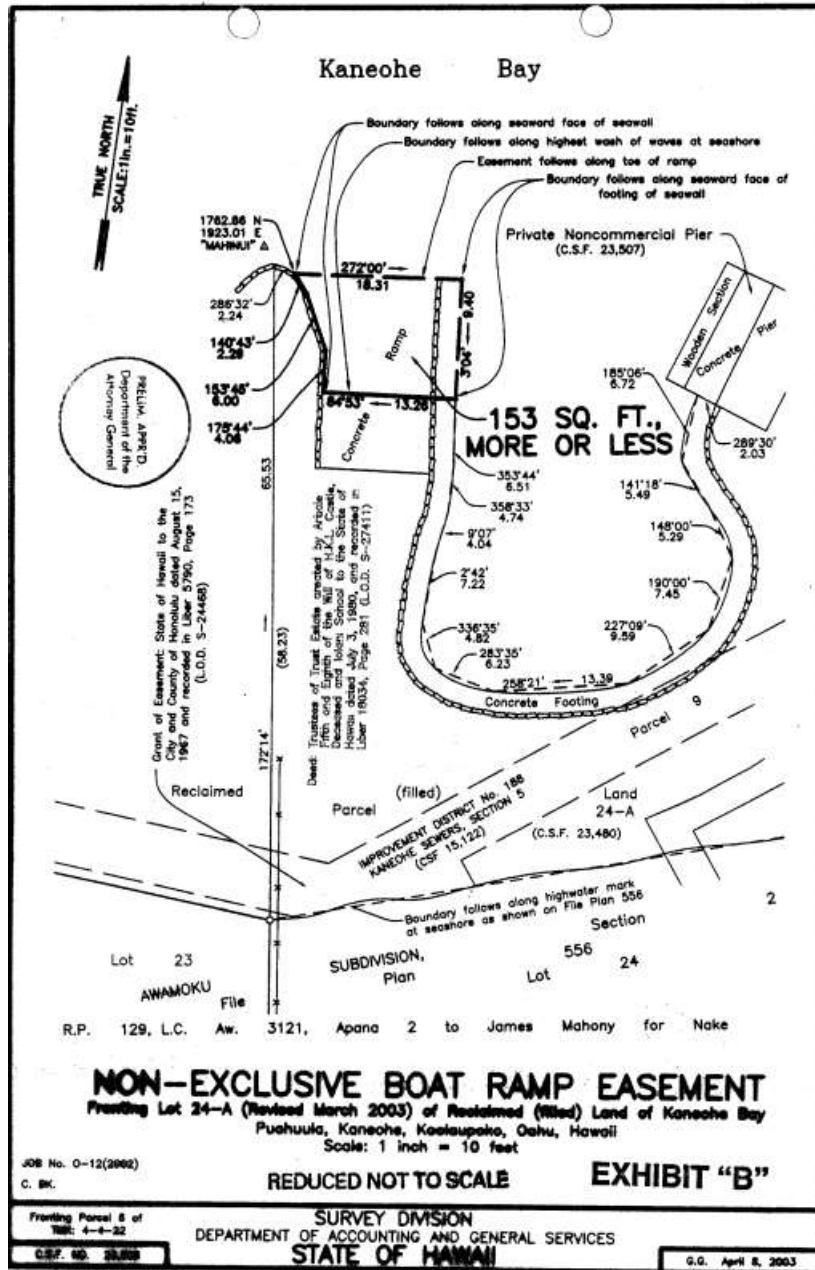

TMK: (1) 4-4-022: seaward of 006

Exhibit A2